

**Final Submittal**

**Energy Engineering Analysis Program  
Lighting Survey of Selected Buildings  
Pine Bluff Arsenal  
Pine Bluff, Arkansas**



**Volume IIIB  
Site Survey Forms**

**Contract No. DACA01-94-D-0038  
Delivery Order No. 0001**

**June 1995**

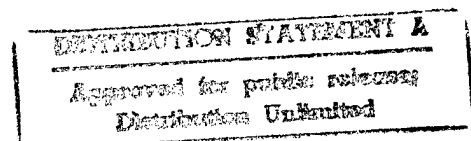



DEPARTMENT OF THE ARMY  
CONSTRUCTION ENGINEERING RESEARCH LABORATORIES, CORPS OF ENGINEERS  
P.O. BOX 9005  
CHAMPAIGN, ILLINOIS 61826-9005

REPLY <sup>TO</sup>  
ATTENTION OF: TR-I Library

17 Sep 1997

Based on SOW, these Energy Studies are unclassified/unlimited.  
Distribution A. Approved for public release.

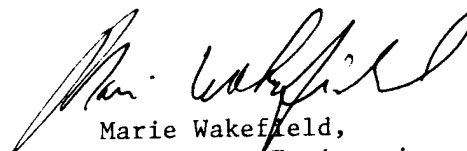
  
Marie Wakefield,  
Librarian Engineering

19971017 223

FINAL SUBMITTAL

ENERGY ENGINEERING ANALYSIS PROGRAM  
LIGHTING SURVEY OF SELECTED BUILDINGS  
PINE BLUFF ARSENAL  
PINE BLUFF, ARKANSAS

VOLUME 111B  
SITE SURVEY FORMS

CONTRACT NO. DACA01-94-D-0038  
DELIVERY ORDER NO. 0001

PREPARED FOR:

U.S. ARMY CORPS OF ENGINEERS  
LITTLE ROCK, ARKANSAS

PREPARED BY:

REYNOLDS, SMITH AND HILLS, INC.  
ENERGY SERVICES DEPARTMENT  
P.O. BOX 4850  
JACKSONVILLE, FLORIDA 32201

*See Appendix A for Project P*

PROJECT NO. 6941331001

JUNE 1995



Carlos S. Warren, PhD, PE  
Project Manager

VOLUME IIIA  
TABLE OF CONTENTS

BLDG

TAB

34-970	1
44-100	2
51-420	3
51-430	4
53-160	5
60-020	6
60-060	7
60-070	8
60-090	9
60-630	10
63-100	11
63-110	12
63-120	13
63-200	14
63-210	15
63-410	16

# LIGHTING SURVEY DATA SHEET

BLDG. # 60020

ROOM # \_\_\_\_\_

Area Description: Wms Rest Room

Area Dimensions: \_\_\_\_\_ ft X \_\_\_\_\_ ft.

Fixture Grid: \_\_\_\_\_ ft X \_\_\_\_\_ ft. (center-to-center)

Fixture Type: 4' SURF GASKET

Switching - Type: WALL No. 1

Accessibility to User: OK

Hours of Operation: \_\_\_\_\_

Lamp Model: \_\_\_\_\_

Ballast Model: \_\_\_\_\_

Lamps/ Fixture	Ballast/ Fixture	No. Fixture	FC	FC	FC
<u>2</u>	<u>1</u>	<u>1</u>	<u>11</u>	—	—

## LIGHTING SURVEY DATA SHEET

BLDG. # 34970

ROOM # 1

Area Description: SECRETARY OFFICE

Area Dimensions: 12 ft X 12 ft. 8'

Fixture Grid: \_\_\_\_\_ ft X \_\_\_\_\_ ft. (center-to-center)

Fixture Type: RECESSED ACRYLIC

Switching - Type: WALL No. 1

Accessibility to User: OK

Hours of Operation: 0700-1630

Lamp Model: F40 CW

Ballast Model: STD

Lamps/ Fixture	Ballast/ Fixture	No. Fixture	FC	FC	FC
<u>4</u>	<u>2</u>	<u>4</u>	<u>71</u>	—	—

# LIGHTING SURVEY DATA SHEET

BLDG. # 34970

ROOM # 4

Area Description: Rm 4 OFFICE

Area Dimensions: 11 ft X 12 ft. 8'

Fixture Grid: \_\_\_\_\_ ft X \_\_\_\_\_ ft. (center-to-center).

Fixture Type: RECESSED ARMED

Switching - Type: WALL No. 1

Accessibility to User: OK

Hours of Operation: \_\_\_\_\_

Lamp Model: RUOLW

Ballast Model: STD

Lamps/ Fixture	Ballast/ Fixture	No. Fixture	FC	FC	FC
<u>4</u>	<u>2</u>	<u>4</u>	<u>60</u>	_____	_____

## LIGHTING SURVEY DATA SHEET

BLDG. # 34970

ROOM # 3

Area Description: Rm 3 OFFICE

Area Dimensions: 13 ft X 12 ft. 8'

Fixture Grid: \_\_\_\_\_ ft X \_\_\_\_\_ ft. (center-to-center)

Fixture Type: RECESSED ARMED

Switching - Type: WALL No. 1

Accessibility to User: OK

Hours of Operation: \_\_\_\_\_

Lamp Model: RUOLW

Ballast Model: STD

Lamps/ Fixture	Ballast/ Fixture	No. Fixture	FC	FC	FC
<u>4</u>	<u>2</u>	<u>4</u>	<u>90</u>	_____	_____

# LIGHTING SURVEY DATA SHEET

BLDG. # 34970

ROOM # \_\_\_\_\_

Area Description: DIRECTOR ENG

Area Dimensions: 16 ft X 18 ft. 8'

Fixture Grid: \_\_\_\_\_ ft X \_\_\_\_\_ ft. (center-to-center)

Fixture Type: SAME

Switching - Type: WALL No. 1

Accessibility to User: OK

Hours of Operation: \_\_\_\_\_

Lamp Model: F40CW + 34W

Ballast Model: STD

Lamps/ Fixture	Ballast/ Fixture	No. Fixture	FC	FC	FC
<u>2</u>	<u>1</u>	<u>8</u>	<u>66</u>	_____	_____

## LIGHTING SURVEY DATA SHEET

BLDG. # 34970

ROOM # \_\_\_\_\_

Area Description: ADMIN OFFICE

Area Dimensions: \_\_\_\_\_ ft X \_\_\_\_\_ ft. 8'

Fixture Grid: \_\_\_\_\_ ft X \_\_\_\_\_ ft. (center-to-center)

Fixture Type: SAME

Switching - Type: WALL No. 1

Accessibility to User: OK

Hours of Operation: \_\_\_\_\_

Lamp Model: \_\_\_\_\_

Ballast Model: \_\_\_\_\_

Lamps/ Fixture	Ballast/ Fixture	No. Fixture	FC	FC	FC
<u>4</u>	<u>2</u>	<u>4</u>	_____	_____	_____

LOCKED - COULD NOT GET IN

# LIGHTING SURVEY DATA SHEET

BLDG. # 34970

ROOM # \_\_\_\_\_

Area Description: CONF ROOM

Area Dimensions: 16.5 ft X 18 ft. 8'

Fixture Grid: \_\_\_\_\_ ft X \_\_\_\_\_ ft. (center-to-center)

Fixture Type: SAME

Switching - Type: WALL No. 1

Accessibility to User: OK

Hours of Operation: \_\_\_\_\_

Lamp Model: P40 CW w/4 SAME 34W Ballast Model: STD

Lamps/ Fixture	Ballast/ Fixture	No. Fixture	FC	FC	FC
<u>4</u>	<u>2</u>	<u>5</u>	<u>51</u>	_____	_____

ONLY 2 LAMPS USED IN FIXTURE

## LIGHTING SURVEY DATA SHEET

BLDG. # 34970

ROOM # \_\_\_\_\_

Area Description: FILE ROOM

Area Dimensions: 9 ft X 14 ft. 8'

Fixture Grid: \_\_\_\_\_ ft X \_\_\_\_\_ ft. (center-to-center)

Fixture Type: SAME

Switching - Type: WALL No. 1

Accessibility to User: OK

Hours of Operation: 0700 - 1630

Lamp Model: \_\_\_\_\_ Ballast Model: \_\_\_\_\_

Lamps/ Fixture	Ballast/ Fixture	No. Fixture	FC	FC	FC
<u>4</u>	<u>2</u>	<u>2</u>	<u>22</u>	<u>57</u>	_____



# LIGHTING SURVEY DATA SHEET

BLDG. # 34970

ROOM # \_\_\_\_\_

Area Description: CORNER ROOM

Area Dimensions: 5.5 ft X 13 ft. 101

Fixture Grid: \_\_\_\_\_ ft X \_\_\_\_\_ ft. (center-to-center)

Fixture Type: 4' EGGCRATE

Switching - Type: O.S. No. 1

Accessibility to User: OK

Hours of Operation: \_\_\_\_\_

Lamp Model: \_\_\_\_\_ Ballast Model: \_\_\_\_\_

Lamps/ Fixture	Ballast/ Fixture	No. Fixture	FC	FC	FC
<u>4</u>	<u>2</u>	<u>2</u>	<u>28</u>	_____	_____

## LIGHTING SURVEY DATA SHEET

BLDG. # 34970

ROOM # \_\_\_\_\_

Area Description: STORAGE ROOM

Area Dimensions: 5.5 ft X 15 ft.

Fixture Grid: \_\_\_\_\_ ft X \_\_\_\_\_ ft. (center-to-center)

Fixture Type: 4' S.M. WRAP ARMS

Switching - Type: WALL No. 1

Accessibility to User: OK

Hours of Operation: \_\_\_\_\_

Lamp Model: F40 CW Ballast Model: STD

Lamps/ Fixture	Ballast/ Fixture	No. Fixture	FC	FC	FC
<u>2</u>	<u>1</u>	<u>2</u>	<u>30</u>	_____	_____

# LIGHTING SURVEY DATA SHEET

BLDG. # 34970

ROOM # \_\_\_\_\_

Area Description: WOMENS Rest Room

Area Dimensions: 6 ft X 9 ft. 10 + (3.5 x 9 8')

Fixture Grid: \_\_\_\_\_ ft X \_\_\_\_\_ ft. (center-to-center)

Fixture Type: \_\_\_\_\_

Switching - Type: WALL No. 1

Accessibility to User: OK

Hours of Operation: \_\_\_\_\_

Lamp Model: F40CW Ballast Model: STD

Lamps/ Fixture	Ballast/ Fixture	No. Fixture	FC	FC	FC
<u>4</u>	<u>2</u>	<u>1</u>	<u>27</u>	<u>32</u> TOILET	_____

1 INCANDESCENT - 75 W

## LIGHTING SURVEY DATA SHEET

BLDG. # 34970

ROOM # \_\_\_\_\_

Area Description: ALCOVE

Area Dimensions: 3.5 ft X 6 ft. 7.5

Fixture Grid: \_\_\_\_\_ ft X \_\_\_\_\_ ft. (center-to-center)

Fixture Type: RECESSED ACRYLIC

Switching - Type: WALL No. 1

Accessibility to User: OK

Hours of Operation: \_\_\_\_\_

Lamp Model: F40CW Ballast Model: STD

Lamps/ Fixture	Ballast/ Fixture	No. Fixture	FC	FC	FC
<u>2</u>	<u>1</u>	<u>1</u>	<u>75</u>	_____	_____

# LIGHTING SURVEY DATA SHEET

BLDG. # 34970

ROOM # \_\_\_\_\_

Area Description: MENS RM

Area Dimensions: 3.5 ft X 9' ft. 8'

Fixture Grid: \_\_\_\_\_ ft X \_\_\_\_\_ ft. (center-to-center)

Fixture Type: INCLAD

Switching - Type: WALL No. 1

Accessibility to User: OK

Hours of Operation: \_\_\_\_\_

Lamp Model: \_\_\_\_\_

Ballast Model: \_\_\_\_\_

Lamps/  
Fixture

Ballast/  
Fixture

No.  
Fixture

FC

FC

FC

22

1 75W INCLAD

## LIGHTING SURVEY DATA SHEET

BLDG. # 34970

ROOM # \_\_\_\_\_

Area Description: KITCHEN

Area Dimensions: 7.5 ft X 13 ft. 7.5

Fixture Grid: \_\_\_\_\_ ft X \_\_\_\_\_ ft. (center-to-center)

Fixture Type: RECESSED ARMRIC

Switching - Type: WALL No. 1

Accessibility to User: OK

Hours of Operation: \_\_\_\_\_

Lamp Model: F40 CW

Ballast Model: STD

Lamps/  
Fixture

Ballast/  
Fixture

No.  
Fixture

FC

FC

FC

2

1

1

60

# LIGHTING SURVEY DATA SHEET

BLDG. # 34970

ROOM # \_\_\_\_\_

Area Description: HALL

Area Dimensions: 4 ft X 30 ft.

Fixture Grid: \_\_\_\_\_ ft X \_\_\_\_\_ ft. (center-to-center)

Fixture Type: RECESSED ACRYLIC

Switching - Type: WALL No. 1

Accessibility to User: OK

Hours of Operation: \_\_\_\_\_

Lamp Model: PHO CW Ballast Model: STD

Lamps/ Fixture	Ballast/ Fixture	No. Fixture	FC	FC	FC
<u>2</u>	<u>1</u>	<u>2</u>	<u>65</u>	<u>60</u>	_____

## LIGHTING SURVEY DATA SHEET

BLDG. # \_\_\_\_\_

ROOM # \_\_\_\_\_

Area Description: \_\_\_\_\_

Area Dimensions: \_\_\_\_\_ ft X \_\_\_\_\_ ft.

Fixture Grid: \_\_\_\_\_ ft X \_\_\_\_\_ ft. (center-to-center)

Fixture Type: \_\_\_\_\_

Switching - Type: \_\_\_\_\_ No. \_\_\_\_\_

Accessibility to User: \_\_\_\_\_

Hours of Operation: \_\_\_\_\_

Lamp Model: \_\_\_\_\_ Ballast Model: \_\_\_\_\_

Lamps/ Fixture	Ballast/ Fixture	No. Fixture	FC	FC	FC
_____	_____	_____	_____	_____	_____

# LIGHTING SURVEY ECO CHECK-LIST

BLDG # 44/100

ROOM/AREA ENTIRE BUILDING

## A. Reduce/enhance lighting

1. Remove unneeded lamps or fixtures \_\_\_\_\_
2. Reduce indoor lighting where illumination exceeds AEI recommended levels \_\_\_\_\_
3. Increase daylighting \_\_\_\_\_
4. Lower light fixtures \_\_\_\_\_
5. Improve reflection and dispersion with light-colored ceiling and walls \_\_\_\_\_

## B. Improve lighting controls

1. Install occupancy controls to control lighting \_\_\_\_\_ ✓ \*
2. Install photocells to lighting near windows \_\_\_\_\_
3. Install additional switches to control lighting arrangements \_\_\_\_\_
4. Use time-clocks to shut off exterior building lights \_\_\_\_\_

## C. Improve lighting efficiency

1. Replace incandescent lamps in kitchen, hallway, and bathroom fixtures with compact fluorescent lamps \_\_\_\_\_
2. Replace incandescent lamps in exit sign fixtures with LED fixtures \_\_\_\_\_
3. Replace incandescent lamps in exit signs with compact fluorescent lamps \_\_\_\_\_ ✓
4. Replace standard fluorescent lamps with energy-conserving lamps \_\_\_\_\_ ✓
5. Replace standard fluorescent ballasts with electronic ballasts \_\_\_\_\_ ✓
6. Replace existing fluorescent fixtures with new fixtures having efficient reflectors, electronic ballasts, and energy-conserving lamps \_\_\_\_\_ ✓
7. Use more efficient lighting sources, i.e., upgrade from incandescent to fluorescent, from fluorescent to HID, from mercury vapor to high-pressure sodium, etc. \_\_\_\_\_

\* AS NECESSARY

# LIGHTING SURVEY DATA SHEET

BLDG. # 44160

ROOM # \_\_\_\_\_

Area Description: CAFETERIA

Area Dimensions: SEE DRAWING ft X \_\_\_\_\_ ft.

Fixture Grid: 8 ft X 12 ft. (center-to-center)

Fixture Type: RECESSED 2'x4' ACRYLIC

Switching - Type: WALL No. 8

Accessibility to User: OK

Hours of Operation: \_\_\_\_\_

Lamp Model: F40 CW

Ballast Model: MARK III

Lamps/ Fixture	Ballast/ Fixture	No. Fixture	FC	FC	FC
<u>3</u>	<u>2</u>	<u>60</u>	<u>28</u>	<u>20</u>	<u>26</u>

EXIT SIGN - 2-25W INCANDESCENT \* 10 FIXTURES ARE ABOVE OFFICES  
 CEILING - 9'  
 LIGHT SWITCHES CONTROL DIFFERENT BULBS IN FIXTURES  
 SOME FIXTURES ARE 2'x2' - INDICATED ON DRAWING

## LIGHTING SURVEY DATA SHEET

BLDG. # 44100

ROOM # \_\_\_\_\_

Area Description: CAFETERIA COOKING AREA

Area Dimensions: SEE DRAWING ft X \_\_\_\_\_ ft.

Fixture Grid: \_\_\_\_\_ ft X \_\_\_\_\_ ft. (center-to-center)

Fixture Type: SAME

Switching - Type: WALL No. 1

Accessibility to User: OK

Hours of Operation: \_\_\_\_\_

Lamp Model: \_\_\_\_\_

Ballast Model: \_\_\_\_\_

Lamps/ Fixture	Ballast/ Fixture	No. Fixture	FC	FC	FC
<u>3</u>	<u>2</u>	<u>7</u>	<u>72</u>	<u>65</u>	_____

CEILING - 9'

# LIGHTING SURVEY DATA SHEET

BLDG. # 411/00 ROOM #       

Area Description: CAFETERIA OFFICE

Area Dimensions: 16 ft X 20 ft. 7.5'

Fixture Grid:        ft X        ft. (center-to-center)

Fixture Type: SAME

Switching - Type:        No. 1

Accessibility to User: OK

Hours of Operation: 0630 - 1630

Lamp Model: F40 CW Ballast Model: MAR III

Lamps/ Fixture	Ballast/ Fixture	No. Fixture	FC	FC	FC
<u>4</u>	<u>2</u>	<u>8</u>	<u>111</u>	<u>106</u>	<u>      </u>

CAFETERIA FIXTURES ARE ABOVE OFFICE CEILING

## LIGHTING SURVEY DATA SHEET

BLDG. # 411/012 ROOM #       

Area Description: CAFETERIA CONFERENCE

Area Dimensions: 12 ft X 20 ft. 7.5'

Fixture Grid:        ft X        ft. (center-to-center)

Fixture Type: SAME

Switching - Type: WALL No. 1

Accessibility to User: OK

Hours of Operation:       

Lamp Model:        Ballast Model:       

Lamps/ Fixture	Ballast/ Fixture	No. Fixture	FC	FC	FC
<u>4</u>	<u>2</u>	<u>4</u>	<u>184</u>	<u>      </u>	<u>      </u>

LIGHTS ARE NORMALLY OFF

# LIGHTING SURVEY DATA SHEET

BLDG. # 44100

ROOM # \_\_\_\_\_

Area Description: CAFETERIA OFFICE

Area Dimensions: 12 ft X 16 ft. + 12x8

Fixture Grid: \_\_\_\_\_ ft X \_\_\_\_\_ ft. (center-to-center)

Fixture Type: SAME

Switching - Type: WALL No. 1

Accessibility to User: \_\_\_\_\_

Hours of Operation: \_\_\_\_\_

Lamp Model: F40 CW Ballast Model: NAP-III

Lamps/ Fixture	Ballast/ Fixture	No. Fixture	FC	FC	FC
<u>4</u>	<u>2</u>	<u>3</u>	<u>121</u>	_____	_____
<u>3</u>	<u>2</u>	<u>1</u>			

\* LIGHTS WERE OFF

## LIGHTING SURVEY DATA SHEET

BLDG. # 44100

ROOM # \_\_\_\_\_

Area Description: MENS/WMS RESTROOM

Area Dimensions: \_\_\_\_\_ ft X \_\_\_\_\_ ft.

Fixture Grid: \_\_\_\_\_ ft X \_\_\_\_\_ ft. (center-to-center)

Fixture Type: 75 W INCAD.

Switching - Type: O.S. No. 1

Accessibility to User: \_\_\_\_\_

Hours of Operation: \_\_\_\_\_

Lamp Model: \_\_\_\_\_ Ballast Model: \_\_\_\_\_

Lamps/ Fixture	Ballast/ Fixture	No. Fixture	FC	FC	FC
_____	_____	_____	_____	_____	_____

O.S. APPARATUS TO NOT FUNCTION



# LIGHTING SURVEY DATA SHEET

BLDG. # \_\_\_\_\_ ROOM # \_\_\_\_\_

Area Description: CATERING HALLWAY

Area Dimensions: \_\_\_\_\_ ft X \_\_\_\_\_ ft.

Fixture Grid: \_\_\_\_\_ ft X \_\_\_\_\_ ft. (center-to-center)

Fixture Type: EDW INCAD

Switching - Type: \_\_\_\_\_ No. \_\_\_\_\_

Accessibility to User: \_\_\_\_\_

Hours of Operation: \_\_\_\_\_

Lamp Model: \_\_\_\_\_ Ballast Model: \_\_\_\_\_

<u>Lamps/ Fixture</u>	<u>Ballast/ Fixture</u>	<u>No. Fixture</u>	<u>FC</u>	<u>FC</u>	<u>FC</u>
_____	_____	<u>3</u>	_____	_____	_____

## LIGHTING SURVEY DATA SHEET

BLDG. # 44100 ROOM # \_\_\_\_\_

Area Description: ENG. OFFICE

Area Dimensions: 10 ft X 12.5 ft. 8'

Fixture Grid: \_\_\_\_\_ ft X \_\_\_\_\_ ft. (center-to-center)

Fixture Type: SAME

Switching - Type: WALL No. 1

Accessibility to User: OK

Hours of Operation: \_\_\_\_\_

Lamp Model: F40 CW Ballast Model: \_\_\_\_\_

<u>Lamps/ Fixture</u>	<u>Ballast/ Fixture</u>	<u>No. Fixture</u>	<u>FC</u>	<u>FC</u>	<u>FC</u>
<u>4</u>	<u>2</u>	<u>2</u>	<u>60</u>	<u>60</u>	_____

# LIGHTING SURVEY DATA SHEET

BLDG. # 44100

ROOM # \_\_\_\_\_

Area Description: PM OFFICE

Area Dimensions: 10 ft X 12.5 ft.

Fixture Grid: \_\_\_\_\_ ft X \_\_\_\_\_ ft. (center-to-center)

Fixture Type: SAME

Switching - Type: WALL No. 1

Accessibility to User: OK

Hours of Operation: \_\_\_\_\_

Lamp Model: F40 CW Ballast Model: MAZE III

Lamps/ Fixture	Ballast/ Fixture	No. Fixture	FC	FC	FC
<u>4</u>	<u>2</u>	<u>2</u>	<u>43</u>	_____	_____

-----  
LIGHTING SURVEY DATA SHEET

BLDG. # 44100

ROOM # \_\_\_\_\_

Area Description: ADMIN OFFICE

Area Dimensions: 19 ft X 30 ft.

Fixture Grid: \_\_\_\_\_ ft X \_\_\_\_\_ ft. (center-to-center)

Fixture Type: SAME

Switching - Type: WALL No. 1

Accessibility to User: OK

Hours of Operation: \_\_\_\_\_

Lamp Model: F40 CW Ballast Model: M III

Lamps/ Fixture	Ballast/ Fixture	No. Fixture	FC	FC	FC
<u>4</u>	<u>2</u>	<u>9</u>	<u>75</u>	<u>30</u>	_____

# LIGHTING SURVEY DATA SHEET

BLDG. # 44100

ROOM # \_\_\_\_\_

Area Description: DIRECTOR OFFICE

Area Dimensions: 24 ft X 12 ft.

Fixture Grid: \_\_\_\_\_ ft X \_\_\_\_\_ ft. (center-to-center)

Fixture Type: SAME

Switching - Type: WALL No. 1

Accessibility to User: OK

Hours of Operation: \_\_\_\_\_

Lamp Model: F40CW Ballast Model: M III

Lamps/ Fixture	Ballast/ Fixture	No. Fixture	FC	FC	FC
<u>4</u>	<u>2</u>	<u>4</u>	<u>82</u>	_____	_____

-----  
LIGHTING SURVEY DATA SHEET

BLDG. # 44100

ROOM # \_\_\_\_\_

Area Description: COFFEE ROOM

Area Dimensions: 12 ft X 13 ft.

Fixture Grid: \_\_\_\_\_ ft X \_\_\_\_\_ ft. (center-to-center)

Fixture Type: SAME

Switching - Type: WALL No. 1

Accessibility to User: OK

Hours of Operation: \_\_\_\_\_

Lamp Model: F40CW Ballast Model: M III

Lamps/ Fixture	Ballast/ Fixture	No. Fixture	FC	FC	FC
<u>4</u>	<u>2</u>	<u>2</u>	<u>75</u>	_____	_____

# LIGHTING SURVEY DATA SHEET

BLDG. # 44100 ROOM # \_\_\_\_\_

Area Description: CAD OFFICE

Area Dimensions: 9.5 ft X 13 ft.

Fixture Grid: SAME ft X \_\_\_\_\_ ft. (center-to-center)

Fixture Type: \_\_\_\_\_

Switching - Type: WALL No. 1

Accessibility to User: OK

Hours of Operation: \_\_\_\_\_

Lamp Model: \_\_\_\_\_ Ballast Model: \_\_\_\_\_

Lamps/ Fixture	Ballast/ Fixture	No. Fixture	FC	FC	FC
<u>4</u>	<u>2</u>	<u>2</u>	<u>68</u>	_____	_____

## LIGHTING SURVEY DATA SHEET

BLDG. # 44100 ROOM # \_\_\_\_\_

Area Description: OFFICE #1

Area Dimensions: 11 ft X 14 ft.

Fixture Grid: \_\_\_\_\_ ft X \_\_\_\_\_ ft. (center-to-center)

Fixture Type: SAME

Switching - Type: WALL No. 1

Accessibility to User: OK

Hours of Operation: \_\_\_\_\_

Lamp Model: FHDCW Ballast Model: M III

Lamps/ Fixture	Ballast/ Fixture	No. Fixture	FC	FC	FC
<u>4</u>	<u>2</u>	<u>3</u>	<u>91</u>	_____	_____

# LIGHTING SURVEY DATA SHEET

BLDG. # 44100

ROOM # \_\_\_\_\_

Area Description: STATISTICS OFFICE

Area Dimensions: 10.5 ft X 10.5 ft.

Fixture Grid: \_\_\_\_\_ ft X \_\_\_\_\_ ft. (center-to-center)

Fixture Type: SAME

Switching - Type: WALL No. 1

Accessibility to User: OK

Hours of Operation: \_\_\_\_\_

Lamp Model: \_\_\_\_\_ Ballast Model: \_\_\_\_\_

Lamps/ Fixture	Ballast/ Fixture	No. Fixture	FC	FC	FC
<u>4</u>	<u>2</u>	<u>2</u>	<u>61</u>	_____	_____

## LIGHTING SURVEY DATA SHEET

BLDG. # 44100

ROOM # \_\_\_\_\_

Area Description: OFFICE #2

Area Dimensions: 10.5 ft X 10.5 ft.

Fixture Grid: \_\_\_\_\_ ft X \_\_\_\_\_ ft. (center-to-center)

Fixture Type: SAME

Switching - Type: WALL No. 1

Accessibility to User: OK

Hours of Operation: \_\_\_\_\_

Lamp Model: \_\_\_\_\_ Ballast Model: \_\_\_\_\_

Lamps/ Fixture	Ballast/ Fixture	No. Fixture	FC	FC	FC
<u>4</u>	<u>2</u>	<u>2</u>	<u>65</u>	_____	_____

# LIGHTING SURVEY DATA SHEET

BLDG. # 44100

ROOM # \_\_\_\_\_

Area Description: OFFICE HALL

Area Dimensions: 4 ft X 21.5 ft.

Fixture Grid: \_\_\_\_\_ ft X \_\_\_\_\_ ft. (center-to-center)

Fixture Type: SAME

Switching - Type: WALL No. 1

Accessibility to User: OK

Hours of Operation: \_\_\_\_\_

Lamp Model: FUD CW

Ballast Model: M III

Lamps/ Fixture	Ballast/ Fixture	No. Fixture	FC	FC	FC
<u>4</u>	<u>2</u>	<u>2</u>	<u>42</u>	<u>50</u>	_____

EXIT SIGN - 2 75W INCLAD

## LIGHTING SURVEY DATA SHEET

BLDG. # 44100

ROOM # \_\_\_\_\_

Area Description: MAIN HALL

Area Dimensions: SEE DRAW. ft X \_\_\_\_\_ ft.

Fixture Grid: \_\_\_\_\_ ft X \_\_\_\_\_ ft. (center-to-center)

Fixture Type: SAME

Switching - Type: WALL No. 1

Accessibility to User: OK

Hours of Operation: \_\_\_\_\_

Lamp Model: FUD CW

Ballast Model: RQM-2540-3-TP

Lamps/ Fixture	Ballast/ Fixture	No. Fixture	FC	FC	FC
<u>2</u>	<u>2</u>	<u>7</u>	<u>26</u>	<u>36</u>	_____

ADVANCE

# LIGHTING SURVEY DATA SHEET

BLDG. # 44/60

ROOM # \_\_\_\_\_

Area Description: MAIN OFFICE

Area Dimensions: 15 ft X 19.30 ft.

Fixture Grid: \_\_\_\_\_ ft X \_\_\_\_\_ ft. (center-to-center)

Fixture Type: SAME

Switching - Type: WALL No. 1 NEED D.S.

Accessibility to User: OK

Hours of Operation: \_\_\_\_\_

Lamp Model: \_\_\_\_\_

Ballast Model: \_\_\_\_\_

Lamps/ Fixture	Ballast/ Fixture	No. Fixture	FC	FC	FC
<u>2</u>	<u>1</u>	<u>6</u>	<u>66</u>	<u>47</u>	<u>   </u>

## ----- LIGHTING SURVEY DATA SHEET

BLDG. # 44/00

ROOM # \_\_\_\_\_

Area Description: OFFICE #3

Area Dimensions: 12 ft X 30 ft.

Fixture Grid: \_\_\_\_\_ ft X \_\_\_\_\_ ft. (center-to-center)

Fixture Type: SAME

Switching - Type: WALL No. 1 NEED D.S.

Accessibility to User: OK

Hours of Operation: \_\_\_\_\_

Lamp Model: F40 CW

Ballast Model: \_\_\_\_\_

Lamps/ Fixture	Ballast/ Fixture	No. Fixture	FC	FC	FC
<u>4</u>	<u>2</u>	<u>5</u>	<u>55</u>	<u>71</u>	<u>   </u>

HAS EXIT SIGN

# LIGHTING SURVEY DATA SHEET

BLDG. # 44100

ROOM # \_\_\_\_\_

Area Description: MENS LOBBY ROOM

Area Dimensions: \_\_\_\_\_ ft X \_\_\_\_\_ ft.

Fixture Grid: \_\_\_\_\_ ft X \_\_\_\_\_ ft. (center-to-center)

Fixture Type: SAME

Switching - Type: WALL No. 1 NEED O.S.

Accessibility to User: OK

Hours of Operation: \_\_\_\_\_

Lamp Model: PHOCW

Ballast Model: ADVANCE

Lamps/ Fixture	Ballast/ Fixture	No. Fixture	FC	FC	FC
<u>2</u>	<u>1</u>	<u>14</u>	<u>26</u>	<u>33</u>	_____

1 IN ABOVE

## LIGHTING SURVEY DATA SHEET

BLDG. # 44100

ROOM # \_\_\_\_\_

Area Description: SHOWER AREA

Area Dimensions: \_\_\_\_\_ ft X \_\_\_\_\_ ft.

Fixture Grid: \_\_\_\_\_ ft X \_\_\_\_\_ ft. (center-to-center)

Fixture Type: SAME

Switching - Type: WALL No. 2 NEED O.S.

Accessibility to User: OK

Hours of Operation: \_\_\_\_\_

Lamp Model: \_\_\_\_\_

Ballast Model: \_\_\_\_\_

Lamps/ Fixture	Ballast/ Fixture	No. Fixture	FC	FC	FC
<u>2</u>	<u>1</u>	<u>5</u>	<u>64</u>	<u>29</u>	_____

SHOWER

TOILET

2 WALL MOUNTED 4' FIXTURES IN BATH RM



# LIGHTING SURVEY DATA SHEET

BLDG. # 44100

ROOM # \_\_\_\_\_

Area Description: Locker Rm - OLD

Area Dimensions: \_\_\_\_\_ ft X \_\_\_\_\_ ft.

Fixture Grid: \_\_\_\_\_ ft X \_\_\_\_\_ ft. (center-to-center)

Fixture Type: SAME

Switching - Type: WALL No. \_\_\_\_\_ NEED DIS

Accessibility to User: OK

Hours of Operation: \_\_\_\_\_

Lamp Model: F40 CW

Ballast Model: \_\_\_\_\_

Lamps/ Fixture	Ballast/ Fixture	No. Fixture	FC	FC	FC
<u>2</u>	<u>1</u>	<u>36</u>	<u>30</u>	<u>35</u>	_____

## LIGHTING SURVEY DATA SHEET

BLDG. # \_\_\_\_\_

ROOM # \_\_\_\_\_

Area Description: \_\_\_\_\_

Area Dimensions: \_\_\_\_\_ ft X \_\_\_\_\_ ft.

Fixture Grid: \_\_\_\_\_ ft X \_\_\_\_\_ ft. (center-to-center)

Fixture Type: \_\_\_\_\_

Switching - Type: \_\_\_\_\_ No. \_\_\_\_\_

Accessibility to User: \_\_\_\_\_

Hours of Operation: \_\_\_\_\_

Lamp Model: \_\_\_\_\_

Ballast Model: \_\_\_\_\_

Lamps/ Fixture	Ballast/ Fixture	No. Fixture	FC	FC	FC
_____	_____	_____	_____	_____	_____

# LIGHTING SURVEY DATA SHEET

BLDG. # 44100

ROOM # \_\_\_\_\_

Area Description: LOCKER HALL

Area Dimensions: \_\_\_\_\_ ft X \_\_\_\_\_ ft.

Fixture Grid: \_\_\_\_\_ ft X \_\_\_\_\_ ft. (center-to-center)

Fixture Type: VARIOUS

Switching - Type: WALL No. 2

Accessibility to User: OK

Hours of Operation: \_\_\_\_\_

Lamp Model: \_\_\_\_\_ Ballast Model: \_\_\_\_\_

Lamps/ Fixture	Ballast/ Fixture	No. Fixture	FC	FC	FC
<u>2</u>	<u>1</u>	<u>6</u>	—	—	—
<u>2</u>	<u>1</u>	<u>2</u>	—	—	—

SURFACE  
MOUNT  
INDUSTRIAL

LIGHTS ARE BURNED OUT → 1'x4'  
1 - 75 W INCAD.

## LIGHTING SURVEY DATA SHEET

BLDG. # 44100

ROOM # \_\_\_\_\_

Area Description: MENS RM

Area Dimensions: \_\_\_\_\_ ft X \_\_\_\_\_ ft.

Fixture Grid: \_\_\_\_\_ ft X \_\_\_\_\_ ft. (center-to-center)

Fixture Type: SURF. MOUNT INDUS 41

Switching - Type: WALL No. 1

Accessibility to User: OK

Hours of Operation: \_\_\_\_\_

Lamp Model: \_\_\_\_\_ Ballast Model: \_\_\_\_\_

Lamps/ Fixture	Ballast/ Fixture	No. Fixture	FC	FC	FC
<u>2</u>	<u>1</u>	<u>8</u>	<u>80</u>	—	—

# LIGHTING SURVEY DATA SHEET

BLDG. # 44100

ROOM # \_\_\_\_\_

Area Description: MENS SHOWER

Area Dimensions: \_\_\_\_\_ ft X \_\_\_\_\_ ft.

Fixture Grid: \_\_\_\_\_ ft X \_\_\_\_\_ ft. (center-to-center)

Fixture Type: 4' SURFACE MOUNT - GASET

Switching - Type: O.S. No. 1 DOESN'T WORK

Accessibility to User: OK

Hours of Operation: \_\_\_\_\_

Lamp Model: F40 CW

Ballast Model: \_\_\_\_\_

Lamps/ Fixture	Ballast/ Fixture	No. Fixture	FC	FC	FC
<u>2</u>	<u>1</u>	<u>8</u>	<u>28</u>	<u>40</u>	_____

## LIGHTING SURVEY DATA SHEET

BLDG. # 44100

ROOM # \_\_\_\_\_

Area Description: WOMENS LOUVER

Area Dimensions: 12.5 ft X 38 ft.

Fixture Grid: \_\_\_\_\_ ft X \_\_\_\_\_ ft. (center-to-center)

Fixture Type: SAME

Switching - Type: WALL No. 1 NEED O.S.

Accessibility to User: OK

Hours of Operation: \_\_\_\_\_

Lamp Model: \_\_\_\_\_

Ballast Model: \_\_\_\_\_

Lamps/ Fixture	Ballast/ Fixture	No. Fixture	FC	FC	FC
<u>2</u>	<u>1</u>	<u>8</u>	<u>48</u>	<u>35</u>	_____

# LIGHTING SURVEY DATA SHEET

BLDG. # 44100

ROOM # \_\_\_\_\_

Area Description: WOMENS SHOWER #1

Area Dimensions: 1' - ft X \_\_\_\_\_ ft.

Fixture Grid: \_\_\_\_\_ ft X \_\_\_\_\_ ft. (center-to-center)

Fixture Type: 75 W ENCLOSED IN LANCES

Switching - Type: WALL No. 1 NEED O.S

Accessibility to User: OK

Hours of Operation: \_\_\_\_\_

Lamp Model: \_\_\_\_\_ Ballast Model: \_\_\_\_\_

Lamps/ Fixture	Ballast/ Fixture	No. Fixture	FC	FC	FC
_____	_____	<u>14</u>	<u>10</u>	_____	_____

## LIGHTING SURVEY DATA SHEET

BLDG. # 44100

ROOM # \_\_\_\_\_

Area Description: WOMENS SHOWER #2

Area Dimensions: \_\_\_\_\_ ft X \_\_\_\_\_ ft.

Fixture Grid: \_\_\_\_\_ ft X \_\_\_\_\_ ft. (center-to-center)

Fixture Type: SAME AS #1

Switching - Type: \_\_\_\_\_ No. \_\_\_\_\_

Accessibility to User: \_\_\_\_\_

Hours of Operation: \_\_\_\_\_

Lamp Model: \_\_\_\_\_ Ballast Model: \_\_\_\_\_

Lamps/ Fixture	Ballast/ Fixture	No. Fixture	FC	FC	FC
_____	_____	<u>9</u>	<u>12</u>	_____	_____

# LIGHTING SURVEY DATA SHEET

BLDG. # 44100

ROOM # \_\_\_\_\_

Area Description: WOMENS BATH POOL LOUNGE

Area Dimensions: 16.5 ft X 22.5 ft.

Fixture Grid: \_\_\_\_\_ ft X \_\_\_\_\_ ft. (center-to-center)

Fixture Type: SAME

Switching - Type: WALL No. 1 NEED D.S.

Accessibility to User: \_\_\_\_\_

Hours of Operation: \_\_\_\_\_

Lamp Model: \_\_\_\_\_ Ballast Model: \_\_\_\_\_

Lamps/ Fixture	Ballast/ Fixture	No. Fixture	FC	FC	FC
<u>2</u>	<u>1</u>	<u>4</u>	<u>50</u>	_____	_____

## LIGHTING SURVEY DATA SHEET

BLDG. # 44100

ROOM # \_\_\_\_\_

Area Description: WOMENS B.R.

Area Dimensions: \_\_\_\_\_ ft X \_\_\_\_\_ ft.

Fixture Grid: \_\_\_\_\_ ft X \_\_\_\_\_ ft. (center-to-center)

Fixture Type: 4' INDUSTRIAL

Switching - Type: WALL No. 1

Accessibility to User: OK

Hours of Operation: \_\_\_\_\_

Lamp Model: \_\_\_\_\_ Ballast Model: \_\_\_\_\_

Lamps/ Fixture	Ballast/ Fixture	No. Fixture	FC	FC	FC
<u>2</u>	<u>1</u>	<u>3</u>	<u>36</u>	<u>46</u>	_____

THERE ARE 2 ADDITIONAL FIXTURES NOT USED

# LIGHTING SURVEY DATA SHEET

BLDG. # 44100

ROOM # \_\_\_\_\_

Area Description: SUPPLY STORAGE

Area Dimensions: 29 ft X 16.5 ft.

Fixture Grid: \_\_\_\_\_ ft X \_\_\_\_\_ ft. (center-to-center)

Fixture Type: SAME

Switching - Type: WALL No. 1

Accessibility to User: OK

Hours of Operation: \_\_\_\_\_

Lamp Model: F40 CW Ballast Model: \_\_\_\_\_

Lamps/ Fixture	Ballast/ Fixture	No. Fixture	FC	FC	FC
<u>2</u>	<u>1</u>	<u>8</u>	<u>40</u>	<u>33</u>	<u>   </u>

## ----- LIGHTING SURVEY DATA SHEET

BLDG. # \_\_\_\_\_

ROOM # \_\_\_\_\_

Area Description: SUPPLY FILING AREA

Area Dimensions: 16.60 ft X 41 ft. 8'

Fixture Grid: \_\_\_\_\_ ft X \_\_\_\_\_ ft. (center-to-center)

Fixture Type: SAME

Switching - Type: WALL No. 1 NEED O.S

Accessibility to User: OK

Hours of Operation: \_\_\_\_\_

Lamp Model: F40-CW Ballast Model: \_\_\_\_\_

Lamps/ Fixture	Ballast/ Fixture	No. Fixture	FC	FC	FC
<u>4</u>	<u>2</u>	<u>23</u>	<u>69</u>	<u>71</u>	<u>   </u>

# LIGHTING SURVEY DATA SHEET

BLDG. # 441160

ROOM # \_\_\_\_\_

Area Description: SUPPLY OFFICE

Area Dimensions: 30 ft X 20 ft.

Fixture Grid: \_\_\_\_\_ ft X \_\_\_\_\_ ft. (center-to-center)

Fixture Type: \_\_\_\_\_

Switching - Type: WALL No. 1

Accessibility to User: OK

Hours of Operation: \_\_\_\_\_

Lamp Model: \_\_\_\_\_

Ballast Model: \_\_\_\_\_

Lamps/ Fixture	Ballast/ Fixture	No. Fixture	FC	FC	FC
<u>2</u>	<u>1</u>	<u>7</u>	<u>32</u>	_____	_____

## LIGHTING SURVEY DATA SHEET

BLDG. # 441160

ROOM # \_\_\_\_\_

Area Description: SUPPLY OFFICE PARTITION

Area Dimensions: 9.5 ft X 10 ft. 7'

Fixture Grid: \_\_\_\_\_ ft X \_\_\_\_\_ ft. (center-to-center)

Fixture Type: SAME

Switching - Type: WALL No. 1

Accessibility to User: OK

Hours of Operation: \_\_\_\_\_

Lamp Model: \_\_\_\_\_

Ballast Model: \_\_\_\_\_

Lamps/ Fixture	Ballast/ Fixture	No. Fixture	FC	FC	FC
<u>4</u>	<u>2</u>	<u>2</u>	<u>76</u>	_____	_____

# LIGHTING SURVEY ECO CHECK-LIST

BLDG # 511-420

ROOM/AREA ENTIRE BUILDING

## A. Reduce/enhance lighting

1. Remove unneeded lamps or fixtures ☒
2. Reduce indoor lighting where illumination exceeds AEI recommended levels ☒
3. Increase daylighting ☐
4. Lower light fixtures ☐
5. Improve reflection and dispersion with light-colored ceiling and walls ☐

## B. Improve lighting controls

1. Install occupancy controls to control lighting ☒
2. Install photocells to lighting near windows ☐
3. Install additional switches to control lighting arrangements ☐
4. Use time-clocks to shut off exterior building lights ☐

## C. Improve lighting efficiency

1. Replace incandescent lamps in kitchen, hallway, and bathroom fixtures with compact fluorescent lamps ☐
2. Replace incandescent lamps in exit sign fixtures with LED fixtures ☒
3. Replace incandescent lamps in exit signs with compact fluorescent lamps ☐
4. Replace standard fluorescent lamps with energy-conserving lamps ☒
5. Replace standard fluorescent ballasts with electronic ballasts ☒
6. Replace existing fluorescent fixtures with new fixtures having efficient reflectors, electronic ballasts, and energy-conserving lamps ☐
7. Use more efficient lighting sources, i.e., upgrade from incandescent to fluorescent, from fluorescent to HID, from mercury vapor to high-pressure sodium, etc. ☐



# LIGHTING SURVEY DATA SHEET

BLDG. # 5420 51420

ROOM # 34

Area Description: BREAK ROOM

Area Dimensions: 15 ft X 19.5 ft.

Fixture Grid: \_\_\_\_\_ ft X \_\_\_\_\_ ft. (center-to-center)

Fixture Type: 2x4 RECESSED ACRYLIC LENS

Switching - Type: WALL No. 1

Accessibility to User: OK

Hours of Operation: 0700 - 1630 OFF EVERY OTHER FRIDAY

Lamp Model: F40 CW

Ballast Model: MAGNATEK 446-L-SLH-TL-D

Lamps/ Fixture	Ballast/ Fixture	No. Fixture	FC	FC	FC
<u>4</u>	<u>2</u>	<u>6</u>	<u>90</u>	_____	_____

(ESB)

\* FC HIGH DUE TO DAYLIGHT  
8' CEILING

## LIGHTING SURVEY DATA SHEET

BLDG. # 5420

ROOM # 35

Area Description: CONF. ROOM

Area Dimensions: 13 ft X 15 ft.

Fixture Grid: \_\_\_\_\_ ft X \_\_\_\_\_ ft. (center-to-center)

Fixture Type: SAME

Switching - Type: OCUP. SENS. No. 1

Accessibility to User: OK

Hours of Operation: \_\_\_\_\_

Lamp Model: \_\_\_\_\_

Ballast Model: \_\_\_\_\_

Lamps/ Fixture	Ballast/ Fixture	No. Fixture	FC	FC	FC
<u>4</u>	<u>2</u>	<u>4</u>	<u>48</u>	_____	_____

# LIGHTING SURVEY DATA SHEET

BLDG. # 54120

ROOM # 33

Area Description: OFFICE

Area Dimensions: 15 ft X 15 ft.

Fixture Grid: \_\_\_\_\_ ft X \_\_\_\_\_ ft. (center-to-center)

Fixture Type: \_\_\_\_\_

Switching - Type: O.S. No. 1

Accessibility to User: OK

Hours of Operation: \_\_\_\_\_

Lamp Model: \_\_\_\_\_

Ballast Model: \_\_\_\_\_

Lamps/ Fixture	Ballast/ Fixture	No. Fixture	FC	FC	FC
<u>4</u>	<u>2</u>	<u>4</u>	<u>46</u>	_____	_____

## LIGHTING SURVEY DATA SHEET

BLDG. # 54120

ROOM # 31

Area Description: CHEM. ENG. OFFICE

Area Dimensions: 15.5 ft X 15 ft.

Fixture Grid: \_\_\_\_\_ ft X \_\_\_\_\_ ft. (center-to-center)

Fixture Type: SAME

Switching - Type: WALL No. 1

Accessibility to User: OK

Hours of Operation: \_\_\_\_\_

Lamp Model: \_\_\_\_\_

Ballast Model: \_\_\_\_\_

Lamps/ Fixture	Ballast/ Fixture	No. Fixture	FC	FC	FC
<u>4</u>	<u>2</u>	<u>6</u>	<u>53</u>	_____	_____

Some lamps out

# LIGHTING SURVEY DATA SHEET

BLDG. # 54120

ROOM # 29

Area Description: OFFICE

Area Dimensions: 15 ft X 12 ft.

Fixture Grid: \_\_\_\_\_ ft X \_\_\_\_\_ ft. (center-to-center)

Fixture Type: \_\_\_\_\_

Switching - Type: WALL No. 1

Accessibility to User: OK

Hours of Operation: \_\_\_\_\_

Lamp Model: \_\_\_\_\_ Ballast Model: \_\_\_\_\_

Lamps/ Fixture	Ballast/ Fixture	No. Fixture	FC	FC	FC
<u>4</u>	<u>2</u>	<u>4</u>	<u>117</u>	_____	_____

## LIGHTING SURVEY DATA SHEET

BLDG. # 54120

ROOM # 32

Area Description: MENS CHANGE ROOM

Area Dimensions: 15 ft X 14.5 ft.

Fixture Grid: \_\_\_\_\_ ft X \_\_\_\_\_ ft. (center-to-center)

Fixture Type: 4' GASKET

Switching - Type: WALL No. 1

Accessibility to User: OK

Hours of Operation: \_\_\_\_\_

Lamp Model: F40 CW Ballast Model: MARK III

Lamps/ Fixture	Ballast/ Fixture	No. Fixture	FC	FC	FC
<u>2</u>	<u>1</u>	<u>4</u> <u>5</u>	<u>55</u>	<u>50</u>	<u>B<sub>9</sub></u>

LOCKER AREA

ALSO 1 3' WALL MOUNTED - 2 LAMP F30CW

# LIGHTING SURVEY DATA SHEET

BLDG. # 54120

ROOM # 30

Area Description: WOMENS CHANGING ROOM

Area Dimensions: 15 ft X 9 ft.

Fixture Grid: \_\_\_\_\_ ft X \_\_\_\_\_ ft. (center-to-center)

Fixture Type: SAME AS MENS

Switching - Type: WALL No. 1

Accessibility to User: OK

Hours of Operation: \_\_\_\_\_

Lamp Model: \_\_\_\_\_ Ballast Model: \_\_\_\_\_

Lamps/ Fixture	Ballast/ Fixture	No. Fixture	FC	FC	FC
<u>2</u>	<u>1</u>	<u>3</u> +1 WALL	_____	_____	_____

1 WALL SAME AS MENS

# LIGHTING SURVEY DATA SHEET

BLDG. # 54120

ROOM # HALL 1

Area Description: HALLWAY

Area Dimensions: 6.5 ft X LENGTH OF BUILD ft.

Fixture Grid: \_\_\_\_\_ ft X \_\_\_\_\_ ft. (center-to-center)

Fixture Type: \_\_\_\_\_

did not calculate

Switching - Type: WALL No. 1

Accessibility to User: OK

Hours of Operation: \_\_\_\_\_

Lamp Model: E20 T12 Ballast Model: MAGNATEK 447 LR-TC-P

Lamps/ Fixture	Ballast/ Fixture	No. Fixture	FC	FC	FC
<u>2</u>	<u>1</u>	<u>8</u>	<u>7</u>	<u>15</u>	_____

EXIT SIGN 2 15W INCANDESCENT BULBS

# LIGHTING SURVEY DATA SHEET

BLDG. # 54120

ROOM # 27

Area Description: OFFICE

Area Dimensions: 15 ft X 14 ft.

Fixture Grid: \_\_\_\_\_ ft X \_\_\_\_\_ ft. (center-to-center)

Fixture Type: SAME

Switching - Type: WALL No. 1

Accessibility to User: OK

Hours of Operation: \_\_\_\_\_

Lamp Model: \_\_\_\_\_

Ballast Model: \_\_\_\_\_

Lamps/ Fixture	Ballast/ Fixture	No. Fixture	FC	FC	FC
<u>4</u>	<u>2</u>	<u>4</u>	<u>71</u>	_____	_____

3 FIXTURES HAVE 2 LAMPS TURNED OFF  
1 FIXTURE IS COMPLETELY OFF

## ----- LIGHTING SURVEY DATA SHEET

BLDG. # 54120

ROOM # 25

Area Description: OFFICE

Area Dimensions: 13.5 ft X 15 ft.

Fixture Grid: \_\_\_\_\_ ft X \_\_\_\_\_ ft. (center-to-center)

Fixture Type: SAME

Switching - Type: WALL No. 1

Accessibility to User: OK

Hours of Operation: \_\_\_\_\_

Lamp Model: \_\_\_\_\_

Ballast Model: \_\_\_\_\_

Lamps/ Fixture	Ballast/ Fixture	No. Fixture	FC	FC	FC
<u>4</u>	<u>2</u>	<u>4</u>	<u>117</u>	_____	_____

2 LAMPS ARE OUT IN 3 FIXTURES

# LIGHTING SURVEY DATA SHEET

BLDG. # 54120

ROOM # 23

Area Description: OFFICE

Area Dimensions: 15.5 ft X 15 ft.

Fixture Grid: \_\_\_\_\_ ft X \_\_\_\_\_ ft. (center-to-center)

Fixture Type: SAME

Switching - Type: O.S. No. 1

Accessibility to User: OK

Hours of Operation: \_\_\_\_\_

Lamp Model: \_\_\_\_\_

Ballast Model: \_\_\_\_\_

Lamps/ Fixture	Ballast/ Fixture	No. Fixture	FC	FC	FC
<u>4</u>	<u>2</u>	<u>4</u>	<u>61</u>	_____	_____

3 FIXTURES HAVE 2 LAMPS OUT  
1 FIXTURE HAS ALL LAMPS OUT

## LIGHTING SURVEY DATA SHEET

BLDG. # 54120

ROOM # 2

Area Description: OFFICE

Area Dimensions: 15 ft X 15 ft.

Fixture Grid: \_\_\_\_\_ ft X \_\_\_\_\_ ft. (center-to-center)

Fixture Type: SAME

Switching - Type: O.S. No. 1

Accessibility to User: OK

Hours of Operation: \_\_\_\_\_

Lamp Model: \_\_\_\_\_

Ballast Model: \_\_\_\_\_

Lamps/ Fixture	Ballast/ Fixture	No. Fixture	FC	FC	FC
<u>4</u>	<u>2</u>	<u>4</u>	<u>75</u>	_____	_____

2 LAMPS OUT IN ALL FIXTURES

# LIGHTING SURVEY DATA SHEET

BLDG. # 54120

ROOM # 22

Area Description: OFFICE

Area Dimensions: 14 ft X 15 ft.

Fixture Grid: \_\_\_\_\_ ft X \_\_\_\_\_ ft. (center-to-center)

Fixture Type: SAME

Switching - Type: \_\_\_\_\_ No. \_\_\_\_\_

Accessibility to User: \_\_\_\_\_

Hours of Operation: \_\_\_\_\_

Lamp Model: \_\_\_\_\_ Ballast Model: \_\_\_\_\_

Lamps/ Fixture	Ballast/ Fixture	No. Fixture	FC	FC	FC
<u>4</u>	<u>2</u>	<u>4</u>	_____	_____	_____

LOCKED - COULD NOT GET IN

## LIGHTING SURVEY DATA SHEET

BLDG. # 54120

ROOM # 20/24

Area Description: STORAGE AREA

Area Dimensions: 10 ft X 15 ft.

Fixture Grid: \_\_\_\_\_ ft X \_\_\_\_\_ ft. (center-to-center)

Fixture Type: SAME

Switching - Type: WALL No. 1

Accessibility to User: OK

Hours of Operation: \_\_\_\_\_

Lamp Model: \_\_\_\_\_ Ballast Model: \_\_\_\_\_

Lamps/ Fixture	Ballast/ Fixture	No. Fixture	FC	FC	FC
<u>1</u>	<u>2</u>	<u>4</u>	<u>205</u>	_____	_____

# LIGHTING SURVEY DATA SHEET

BLDG. # 54120

ROOM # 26

Area Description: OFFICE

Area Dimensions: 13 ft X 15 ft.

Fixture Grid: \_\_\_\_\_ ft X \_\_\_\_\_ ft. (center-to-center)

Fixture Type: SAME

Switching - Type: WALL No. 1

Accessibility to User: \_\_\_\_\_

Hours of Operation: \_\_\_\_\_

Lamp Model: \_\_\_\_\_

Ballast Model: \_\_\_\_\_

Lamps/  
Fixture

Ballast/  
Fixture

No.  
Fixture

FC

FC

FC

4

2

4

198

\_\_\_\_\_

\_\_\_\_\_

## LIGHTING SURVEY DATA SHEET

BLDG. # 54120

ROOM # 28

Area Description: OFFICE

Area Dimensions: 18 ft X 15 ft.

Fixture Grid: \_\_\_\_\_ ft X \_\_\_\_\_ ft. (center-to-center)

Fixture Type: SAME

Switching - Type: WALL No. 1

Accessibility to User: OK

Hours of Operation: \_\_\_\_\_

Lamp Model: \_\_\_\_\_

Ballast Model: \_\_\_\_\_

Lamps/  
Fixture

Ballast/  
Fixture

No.  
Fixture

FC

FC

FC

4

2

4

75

89

\_\_\_\_\_



# LIGHTING SURVEY DATA SHEET

BLDG. # 54120

ROOM # MENS Rm.

Area Description: MENS BATHROOM

Area Dimensions: 11.5 ft X 14.5 ft.

Fixture Grid: \_\_\_\_\_ ft X \_\_\_\_\_ ft. (center-to-center)

Fixture Type: \_\_\_\_\_

Switching - Type: 1 No. WALL

Accessibility to User: OK

Hours of Operation: \_\_\_\_\_

Lamp Model: \_\_\_\_\_ Ballast Model: \_\_\_\_\_

Lamps/ Fixture	Ballast/ Fixture	No. Fixture	FC	FC	FC
<u>4</u>	<u>2</u>	<u>4</u>	<u>75</u>	<u>35</u>	<u>   </u>

## LIGHTING SURVEY DATA SHEET

BLDG. # \_\_\_\_\_

ROOM # Wms. Rm

Area Description: WOMENS RESTROOM

Area Dimensions: 19 ft X 14.5 ft.

Fixture Grid: \_\_\_\_\_ ft X \_\_\_\_\_ ft. (center-to-center)

Fixture Type: SAME

Switching - Type: WALL No. 1

Accessibility to User: OK

Hours of Operation: \_\_\_\_\_

Lamp Model: \_\_\_\_\_ Ballast Model: \_\_\_\_\_

Lamps/ Fixture	Ballast/ Fixture	No. Fixture	FC	FC	FC
<u>4</u>	<u>2</u>	<u>3</u>	<u>70</u>	<u>65</u>	<u>   </u>

PLUS 1 4' INDUSTRIAL 2 TUBE F40 CWIEW 36 LAMPS

## LIGHTING SURVEY DATA SHEET

BLDG. # 54120

ROOM # 7

Area Description: COPIER ROOM

Area Dimensions: 10 ft X 15 ft.

Fixture Grid: \_\_\_\_\_ ft X \_\_\_\_\_ ft. (center-to-center)

Fixture Type: INDUSTRIAL SURFACE MOUNT

Switching - Type: WALL No. 1

Accessibility to User: OK

Hours of Operation:

Lamp Model: F40 CW

Ballast Model: STD

Lamps/  
Fixture

Ballast/  
Fixture

No.  
Fixture

FC

FC

EC

3

2

2

21

FIXTURES MOUNTED ABOVE CEILING GRID  
NEEDS OLLUP. SENSOR

## LIGHTING SURVEY DATA SHEET

BLDG. # 54120

ROOM # H.W. #2

Area Description: HALLWAY #2

Area Dimensions: \_\_\_\_\_ ft X \_\_\_\_\_ ft.

Fixture Grid: \_\_\_\_\_ ft X \_\_\_\_\_ ft. (center-to-center)

Fixture Type: SAME AS HALL #1

Switching - Type: WALL No. 1

Accessibility to User: OK

Hours of Operation:

Lamp Model:

Ballast Model:

Lamps/  
Fixture

Ballast/  
Fixture

No.  
Fixture

FC

FC

FC

4

2

2

2

# LIGHTING SURVEY DATA SHEET

BLDG. # 54120

ROOM # 5

Area Description: MANAGERS OFFICE

Area Dimensions: 20.5 ft X 15 ft.

Fixture Grid: \_\_\_\_\_ ft X \_\_\_\_\_ ft. (center-to-center)

Fixture Type: SAME

Switching - Type: WALL No. 1

Accessibility to User: OK

Hours of Operation: 0630 - 1630 6 DAYS A WEEK

Lamp Model: \_\_\_\_\_

Ballast Model: \_\_\_\_\_

Lamps/ Fixture	Ballast/ Fixture	No. Fixture	FC	FC	FC
<u>4</u>	<u>2</u>	<u>6</u>	<u>105</u>	—	—

-----  
LIGHTING SURVEY DATA SHEET

BLDG. # 54120

ROOM # 3

Area Description: MANAGERS SECRETARY

Area Dimensions: 19 ft X 15 ft.

Fixture Grid: \_\_\_\_\_ ft X \_\_\_\_\_ ft. (center-to-center)

Fixture Type: SAME

Switching - Type: O.S. No. 1

Accessibility to User: OK

Hours of Operation: 0630 - 1630

Lamp Model: \_\_\_\_\_

Ballast Model: \_\_\_\_\_

Lamps/ Fixture	Ballast/ Fixture	No. Fixture	FC	FC	FC
<u>4</u>	<u>2</u>	<u>6</u>	<u>96</u>	—	—

# LIGHTING SURVEY DATA SHEET

BLDG. # 54120

ROOM # 1

Area Description: OFFICE - DIRECTOR

Area Dimensions: 20.5 ft X 15 ft.

Fixture Grid: \_\_\_\_\_ ft X \_\_\_\_\_ ft. (center-to-center)

Fixture Type: SAME

Switching - Type: O.S. No. 1

Accessibility to User: OK

Hours of Operation: 0630-1630

Lamp Model: \_\_\_\_\_

Ballast Model: \_\_\_\_\_

Lamps/ Fixture	Ballast/ Fixture	No. Fixture	FC	FC	FC
<u>4</u>	<u>2</u>	<u>6</u>	<u>104</u>	_____	_____

## LIGHTING SURVEY DATA SHEET

BLDG. # 54120

ROOM # 2

Area Description: OFFICE

Area Dimensions: 12 ft X 15 ft.

Fixture Grid: \_\_\_\_\_ ft X \_\_\_\_\_ ft. (center-to-center)

Fixture Type: SAME

Switching - Type: WALL No. 1

Accessibility to User: OK

Hours of Operation: 0630-1630

Lamp Model: \_\_\_\_\_

Ballast Model: \_\_\_\_\_

Lamps/ Fixture	Ballast/ Fixture	No. Fixture	FC	FC	FC
<u>4</u>	<u>2</u>	<u>2</u>	<u>25</u>	_____	_____

PLENTY OF SUNLIGHT IN ROOM

# LIGHTING SURVEY DATA SHEET

BLDG. # 54120

ROOM # 4

Area Description: OFFICE

Area Dimensions: 18.5 ft X 15 ft.

Fixture Grid: \_\_\_\_\_ ft X \_\_\_\_\_ ft. (center-to-center)

Fixture Type: SAME

Switching - Type: WALL No. 1

Accessibility to User: OK

Hours of Operation: \_\_\_\_\_

Lamp Model: \_\_\_\_\_

Ballast Model: \_\_\_\_\_

Lamps/ Fixture	Ballast/ Fixture	No. Fixture	FC	FC	FC
<u>4</u>	<u>2</u>	<u>6</u>	<u>118</u>	_____	_____

## LIGHTING SURVEY DATA SHEET

BLDG. # 54120

ROOM # 6

Area Description: OFFICE

Area Dimensions: 15 ft X 15 ft.

Fixture Grid: SAME ft X \_\_\_\_\_ ft. (center-to-center)

Fixture Type: \_\_\_\_\_

Switching - Type: WALL No. 1

Accessibility to User: OK

Hours of Operation: \_\_\_\_\_

Lamp Model: \_\_\_\_\_

Ballast Model: \_\_\_\_\_

Lamps/ Fixture	Ballast/ Fixture	No. Fixture	FC	FC	FC
<u>4</u>	<u>2</u>	<u>4</u>	<u>128</u>	_____	_____

# LIGHTING SURVEY DATA SHEET

BLDG. # 54120 ROOM # 8

Area Description: OFFICE  
 Area Dimensions: 14.5 ft X 15 ft.  
 Fixture Grid: \_\_\_\_\_ ft X \_\_\_\_\_ ft. (center-to-center)  
 Fixture Type: SAME  
 Switching - Type: WALL No. 1  
 Accessibility to User: OK  
 Hours of Operation: \_\_\_\_\_  
 Lamp Model: \_\_\_\_\_ Ballast Model: \_\_\_\_\_

Lamps/ Fixture	Ballast/ Fixture	No. Fixture	FC	FC	FC
<u>4</u>	<u>2</u>	<u>4</u>	<u>94</u>	_____	_____

## LIGHTING SURVEY DATA SHEET

BLDG. # 54120 ROOM # 10

Area Description: OFFICE  
 Area Dimensions: 14.5 ft X 15 ft.  
 Fixture Grid: \_\_\_\_\_ ft X \_\_\_\_\_ ft. (center-to-center)  
 Fixture Type: SAME  
 Switching - Type: WALL No. 1  
 Accessibility to User: OK  
 Hours of Operation: \_\_\_\_\_  
 Lamp Model: \_\_\_\_\_ Ballast Model: \_\_\_\_\_

Lamps/ Fixture	Ballast/ Fixture	No. Fixture	FC	FC	FC
<u>4</u>	<u>2</u>	<u>4</u>	_____	_____	_____

# LIGHTING SURVEY DATA SHEET

BLDG. # 54120

ROOM # 9

Area Description: OFFICE

Area Dimensions: 12.5 ft X 15 ft.

Fixture Grid: \_\_\_\_\_ ft X \_\_\_\_\_ ft. (center-to-center)

Fixture Type: SAME

Switching - Type: WALL No. 1

Accessibility to User: OK

Hours of Operation: \_\_\_\_\_

Lamp Model: \_\_\_\_\_

Ballast Model: \_\_\_\_\_

Lamps/ Fixture	Ballast/ Fixture	No. Fixture	FC	FC	FC
<u>4</u>	<u>2</u>	<u>2</u>	<u>84</u>	_____	_____

## ----- LIGHTING SURVEY DATA SHEET

BLDG. # 54120

ROOM # 12

Area Description: OFFICE

Area Dimensions: 18 ft X 15 ft.

Fixture Grid: \_\_\_\_\_ ft X \_\_\_\_\_ ft. (center-to-center)

Fixture Type: SAME

Switching - Type: WALL No. 2 1 FOR BACK ROW 1 FOR FRONT ROW

Accessibility to User: OK

Hours of Operation: \_\_\_\_\_

Lamp Model: \_\_\_\_\_

Ballast Model: \_\_\_\_\_

Lamps/ Fixture	Ballast/ Fixture	No. Fixture	FC	FC	FC
<u>4</u>	<u>2</u>	<u>4</u>	<u>81</u>	_____	_____

# LIGHTING SURVEY DATA SHEET

BLDG. # 54120

ROOM # 11

Area Description: OFFICE

Area Dimensions: 17 ft X 15 ft.

Fixture Grid: \_\_\_\_\_ ft X \_\_\_\_\_ ft. (center-to-center)

Fixture Type: SAME

Switching - Type: WALL No. 1

Accessibility to User: OK

Hours of Operation: \_\_\_\_\_

Lamp Model: \_\_\_\_\_

Ballast Model: \_\_\_\_\_

Lamps/ Fixture	Ballast/ Fixture	No. Fixture	FC	FC	FC
<u>4</u>	<u>2</u>	<u>4</u>	<u>70</u>	—	—

## LIGHTING SURVEY DATA SHEET

BLDG. # 54120

ROOM # 14

Area Description: CONFERENCE ROOM

Area Dimensions: 27 ft X 15 ft.

Fixture Grid: \_\_\_\_\_ ft X \_\_\_\_\_ ft. (center-to-center)

Fixture Type: \_\_\_\_\_

Switching - Type: WALL No. 2

Accessibility to User: OK

Hours of Operation: \_\_\_\_\_

Lamp Model: \_\_\_\_\_

Ballast Model: \_\_\_\_\_

Lamps/ Fixture	Ballast/ Fixture	No. Fixture	FC	FC	FC
<u>4</u>	<u>2</u>	<u>6</u>	<u>94</u>	—	—

HAVE 2 OF FIXTURES HAVE 2 LIGHTS OUT



# LIGHTING SURVEY DATA SHEET

BLDG. # 54120

ROOM # 15

Area Description: OFFICE

Area Dimensions: 20.5 ft X 15 ft.

Fixture Grid: \_\_\_\_\_ ft X \_\_\_\_\_ ft. (center-to-center)

Fixture Type: SAME

Switching - Type: WALL No. 1

Accessibility to User: OK

Hours of Operation: \_\_\_\_\_

Lamp Model: \_\_\_\_\_

Ballast Model: \_\_\_\_\_

Lamps/ Fixture	Ballast/ Fixture	No. Fixture	FC	FC	FC
<u>4</u>	<u>2</u>	<u>4</u>	<u>85</u>	—	—

## LIGHTING SURVEY DATA SHEET

BLDG. # 54120

ROOM # \_\_\_\_\_

Area Description: COMPUTER ROOM - AUTOMATED PLANTGROWTH SYSTEM

Area Dimensions: 13.5 ft X 14.5 ft.

Fixture Grid: \_\_\_\_\_ ft X \_\_\_\_\_ ft. (center-to-center)

Fixture Type: 2X2 DIMMING BALLAST

Switching - Type: WALL DIMMER No. 2

Accessibility to User: OK

Hours of Operation: \_\_\_\_\_

Lamp Model: \_\_\_\_\_

Ballast Model: \_\_\_\_\_

Lamps/ Fixture	Ballast/ Fixture	No. Fixture	FC	FC	FC
<u>4</u>	<u>2</u>	<u>4</u>	—	—	—

THIS ROOM WILL BE CHANGED SOON - PROBABLY TO A STORAGE ROOM

# LIGHTING SURVEY DATA SHEET

BLDG. # 51430 ROOM # \_\_\_\_\_

Area Description: OFFICE #1

Area Dimensions: 16 ft X 23 ft. 8

Fixture Grid: \_\_\_\_\_ ft X \_\_\_\_\_ ft. (center-to-center)

Fixture Type: RECESSED ACRYLIC

Switching - Type: WALL No. 1

Accessibility to User: OK

Hours of Operation: 0700 - 1600

Lamp Model: F40 CW Ballast Model: STD

Lamps/ Fixture	Ballast/ Fixture	No. Fixture	FC	FC	FC
<u>4</u>	<u>2</u>	<u>9</u>	<u>86</u>	<u>37</u>	<u>    </u>

## LIGHTING SURVEY DATA SHEET

BLDG. # 51430 ROOM # \_\_\_\_\_

Area Description: OFFICE / SHOP

Area Dimensions: 21.5 ft X 29 ft. 11

Fixture Grid: \_\_\_\_\_ ft X \_\_\_\_\_ ft. (center-to-center)

Fixture Type: 8' INDUS. SUSPEND, NO REFLEC.

Switching - Type: WALL No. 1

Accessibility to User: OK

Hours of Operation: 0700 - 1600

Lamp Model: F96 CW 60W Ballast Model: STD

Lamps/ Fixture	Ballast/ Fixture	No. Fixture	FC	FC	FC
<u>2</u>	<u>1</u>	<u>8</u>	<u>45</u>	<u>89</u>	<u>    </u>

# LIGHTING SURVEY DATA SHEET

BLDG. # 51430

ROOM # \_\_\_\_\_

Area Description: BATHROOMS

Area Dimensions: \_\_\_\_\_ ft X \_\_\_\_\_ ft.

Fixture Grid: \_\_\_\_\_ ft X \_\_\_\_\_ ft. (center-to-center)

Fixture Type: INCA

Switching - Type: WALL No. 1

Accessibility to User: OK

Hours of Operation: \_\_\_\_\_

Lamp Model: 75 W Ballast Model: \_\_\_\_\_

Lamps/ Fixture	Ballast/ Fixture	No. Fixture	FC	FC	FC
_____	_____	_____	_____	_____	_____

## LIGHTING SURVEY DATA SHEET

BLDG. # 51430

ROOM # \_\_\_\_\_

Area Description: OFFICE #2

Area Dimensions: 14 ft X 29 ft. 8'

Fixture Grid: \_\_\_\_\_ ft X \_\_\_\_\_ ft. (center-to-center)

Fixture Type: RECESSED

Switching - Type: WALL No. 1

Accessibility to User: OK

Hours of Operation: 0700-1600

Lamp Model: F40CW Ballast Model: STD

Lamps/ Fixture	Ballast/ Fixture	No. Fixture	FC	FC	FC
<u>2</u>	<u>1</u>	<u>3</u>	<u>42</u>	<u>29</u>	_____
<u>4</u>	<u>2</u>	<u>6</u>			

# LIGHTING SURVEY DATA SHEET

BLDG. # 51430

ROOM # \_\_\_\_\_

Area Description: OFFICE #3

Area Dimensions: 18.5 ft X 12.5 ft.

Fixture Grid: \_\_\_\_\_ ft X \_\_\_\_\_ ft. (center-to-center)

Fixture Type: RECESSED ACRYLIC

Switching - Type: WALL No. 1

Accessibility to User: OK

Hours of Operation: 0700-1800

Lamp Model: FUO CW Ballast Model: STD

Lamps/ Fixture	Ballast/ Fixture	No. Fixture	FC	FC	FC
<u>4</u>	<u>2</u>	<u>2</u>	<u>52</u>	—	—
<u>2</u>	<u>1</u>	<u>1</u>			

## LIGHTING SURVEY DATA SHEET

BLDG. # 51430

ROOM # \_\_\_\_\_

Area Description: OFFICE #3 RESTROOM

Area Dimensions: \_\_\_\_\_ ft X \_\_\_\_\_ ft.

Fixture Grid: \_\_\_\_\_ ft X \_\_\_\_\_ ft. (center-to-center)

Fixture Type: IN CAD.

Switching - Type: WALL No. 1

Accessibility to User: OK

Hours of Operation: \_\_\_\_\_

Lamp Model: 60 W Ballast Model: \_\_\_\_\_

Lamps/ Fixture	Ballast/ Fixture	No. Fixture	FC	FC	FC
<u>1</u>	—	<u>2</u>	—	—	—

# LIGHTING SURVEY DATA SHEET

BLDG. # 53160

ROOM # \_\_\_\_\_

Area Description: MAIN AREA  
 Area Dimensions: 14.5 ft X 36 ft. + 6x20 ft. 8'10"  
 Fixture Grid: \_\_\_\_\_ ft X \_\_\_\_\_ ft. (center-to-center)  
 Fixture Type: RECESSED ACRYLIC  
 Switching - Type: WALL No. 1  
 Accessibility to User: OK  
 Hours of Operation: \_\_\_\_\_  
 Lamp Model: FWD CW Ballast Model: STD

Lamps/ Fixture	Ballast/ Fixture	No. Fixture	FC	FC	FC
<u>4</u>	<u>2</u>	<u>10</u>	<u>89</u>	_____	_____

## ----- LIGHTING SURVEY DATA SHEET

BLDG. # 53160

ROOM # \_\_\_\_\_

Area Description: OFFICE #1  
 Area Dimensions: 10 ft X 12 ft.  
 Fixture Grid: \_\_\_\_\_ ft X \_\_\_\_\_ ft. (center-to-center)  
 Fixture Type: SAME  
 Switching - Type: WALL No. 1  
 Accessibility to User: OK  
 Hours of Operation: \_\_\_\_\_  
 Lamp Model: FWD CW Ballast Model: STD

Lamps/ Fixture	Ballast/ Fixture	No. Fixture	FC	FC	FC
<u>4</u>	<u>2</u>	<u>2</u>	<u>92</u>	_____	_____

# LIGHTING SURVEY DATA SHEET

BLDG. # 53160

ROOM # \_\_\_\_\_

Area Description: OFFICE #2

Area Dimensions: 11 ft X 10 ft.

Fixture Grid: \_\_\_\_\_ ft X \_\_\_\_\_ ft. (center-to-center)

Fixture Type: SAME

Switching - Type: WALL No. 1

Accessibility to User: OK

Hours of Operation: \_\_\_\_\_

Lamp Model: FWCW Ballast Model: \_\_\_\_\_

Lamps/ Fixture	Ballast/ Fixture	No. Fixture	FC	FC	FC
<u>4</u>	<u>2</u>	<u>2</u>	<u>82</u>	_____	_____

## LIGHTING SURVEY DATA SHEET

BLDG. # 53160

ROOM # \_\_\_\_\_

Area Description: OFFICE #3

Area Dimensions: 10 ft X 12 ft.

Fixture Grid: \_\_\_\_\_ ft X \_\_\_\_\_ ft. (center-to-center)

Fixture Type: SAME

Switching - Type: WALL No. 1

Accessibility to User: OK

Hours of Operation: \_\_\_\_\_

Lamp Model: FWCW Ballast Model: STD

Lamps/ Fixture	Ballast/ Fixture	No. Fixture	FC	FC	FC
<u>4</u>	<u>2</u>	<u>2</u>	<u>84</u>	_____	_____

# LIGHTING SURVEY DATA SHEET

BLDG. # 53160

ROOM # \_\_\_\_\_

Area Description: BREAK ROOM

Area Dimensions: 21 ft X 24 ft. 10

Fixture Grid: \_\_\_\_\_ ft X \_\_\_\_\_ ft. (center-to-center)

Fixture Type: SAME - RECESSED ACR,

Switching - Type: WALL No. 1

Accessibility to User: OK

Hours of Operation: \_\_\_\_\_

Lamp Model: \_\_\_\_\_

Ballast Model: \_\_\_\_\_

Lamps/ Fixture	Ballast/ Fixture	No. Fixture	FC	FC	FC
<u>2</u>	<u>1</u>	<u>9</u>	<u>33</u>	_____	_____

# LIGHTING SURVEY DATA SHEET

BLDG. # 53160

ROOM # \_\_\_\_\_

Area Description: WMS. CLOTHING TURN-IN

Area Dimensions: 5 ft X 9 ft.

Fixture Grid: \_\_\_\_\_ ft X \_\_\_\_\_ ft. (center-to-center)

Fixture Type: 1'x4' RECESSED ACR

Switching - Type: WALL No. 1

Accessibility to User: OK

Hours of Operation: \_\_\_\_\_

Lamp Model: END CW

Ballast Model: \_\_\_\_\_

Lamps/ Fixture	Ballast/ Fixture	No. Fixture	FC	FC	FC
<u>2</u>	<u>1</u>	<u>1</u>	<u>17</u>	_____	_____

# LIGHTING SURVEY DATA SHEET

BLDG. # 53160

ROOM # \_\_\_\_\_

Area Description: Women Restroom

Area Dimensions: 13 ft X 8.5 ft. 91

Fixture Grid: \_\_\_\_\_ ft X \_\_\_\_\_ ft. (center-to-center)

Fixture Type: 1'x4' RECESSED (2) 4' WALL MOUNT CL

Switching - Type: WALL No. 1

Accessibility to User: OK

Hours of Operation: \_\_\_\_\_

Lamp Model: P40 CW

Ballast Model: STD

Lamps/ Fixture	Ballast/ Fixture	No. Fixture	FC	FC	FC
<u>2</u>	<u>1</u>	<u>3</u>	<u>25</u>	<u>—</u>	<u>—</u>

2 INLAD IN SHOWER - NOT WORKING

## LIGHTING SURVEY DATA SHEET

BLDG. # 53160

ROOM # \_\_\_\_\_

Area Description: WOMENS LOCKER

Area Dimensions: 8 ft X 14 ft. 4 x 9 9' UEL

Fixture Grid: \_\_\_\_\_ ft X \_\_\_\_\_ ft. (center-to-center)

Fixture Type: 2'x4' REC. A27 (2) 1'x4' REC. A27 (1)

Switching - Type: WALL No. 1

Accessibility to User: OK

Hours of Operation: \_\_\_\_\_

Lamp Model: P40 LW

Ballast Model: STD

Lamps/ Fixture	Ballast/ Fixture	No. Fixture	FC	FC	FC
<u>4</u>	<u>2</u>	<u>2</u>	<u>12</u>	<u>27</u>	<u>—</u>
<u>2</u>	<u>1</u>	<u>1</u>			



# LIGHTING SURVEY DATA SHEET

BLDG. # 53160

ROOM # \_\_\_\_\_

Area Description: JANITOR

Area Dimensions: 5 ft X 5 ft. 9'

Fixture Grid: \_\_\_\_\_ ft X \_\_\_\_\_ ft. (center-to-center)

Fixture Type: INCAD

Switching - Type: WALL No. 1

Accessibility to User: OK

Hours of Operation: \_\_\_\_\_

Lamp Model: 75W INCAD

Ballast Model: \_\_\_\_\_

Lamps/ Fixture	Ballast/ Fixture	No. Fixture	FC	FC	FC
<u>1</u>	_____	<u>2</u>	<u>22</u>	_____	_____

## LIGHTING SURVEY DATA SHEET

BLDG. # 53160

ROOM # \_\_\_\_\_

Area Description: OFFICE #3

Area Dimensions: 14 ft X 24 ft. 8

Fixture Grid: \_\_\_\_\_ ft X \_\_\_\_\_ ft. (center-to-center)

Fixture Type: RECESSED

Switching - Type: WALL No. 1

Accessibility to User: OK

Hours of Operation: \_\_\_\_\_

Lamp Model: \_\_\_\_\_

Ballast Model: \_\_\_\_\_

Lamps/ Fixture	Ballast/ Fixture	No. Fixture	FC	FC	FC
<u>4</u>	<u>2</u>	<u>4</u>	_____	_____	_____

Room WAS LOCKED

# LIGHTING SURVEY DATA SHEET

BLDG. # 53160

ROOM # \_\_\_\_\_

Area Description: STORE ROOM

Area Dimensions: 8 ft X 14 ft. 10'

Fixture Grid: \_\_\_\_\_ ft X \_\_\_\_\_ ft. (center-to-center)

Fixture Type: RECESSED

Switching - Type: WALL No. 2

Accessibility to User: OK

Hours of Operation: \_\_\_\_\_

Lamp Model: F40CW Ballast Model: STA

Lamps/ Fixture	Ballast/ Fixture	No. Fixture	FC	FC	FC
<u>4</u>	<u>2</u>	<u>2</u>	<u>39</u>	_____	_____

## LIGHTING SURVEY DATA SHEET

BLDG. # 53160

ROOM # \_\_\_\_\_

Area Description: ALLUVE #1

Area Dimensions: 8 ft X 4 ft. 8'

Fixture Grid: \_\_\_\_\_ ft X \_\_\_\_\_ ft. (center-to-center)

Fixture Type: INCAD

Switching - Type: WALL No. 1

Accessibility to User: OK

Hours of Operation: \_\_\_\_\_

Lamp Model: 100 W Ballast Model: X

Lamps/ Fixture	Ballast/ Fixture	No. Fixture	FC	FC	FC
<u>1</u>	<u>X</u>	<u>2</u>	<u>41</u>	_____	_____

# LIGHTING SURVEY DATA SHEET

BLDG. # 53160

ROOM # \_\_\_\_\_

Area Description: MENS CLOTHING TURN-IN

Area Dimensions: 14.5 ft X 8.5 ft. 10

Fixture Grid: \_\_\_\_\_ ft X \_\_\_\_\_ ft. (center-to-center)

Fixture Type: RECESSED

Switching - Type: WALL No. 1

Accessibility to User: OK

Hours of Operation: \_\_\_\_\_

Lamp Model: PHO CW Ballast Model: STD

Lamps/ Fixture	Ballast/ Fixture	No. Fixture	FC	FC	FC
<u>4</u>	<u>2</u>	<u>2</u>	<u>45</u>	_____	_____

## LIGHTING SURVEY DATA SHEET

BLDG. # 53160

ROOM # \_\_\_\_\_

Area Description: MENS BATH ROOM

Area Dimensions: 14.5 ft X 18 ft. 9'

Fixture Grid: \_\_\_\_\_ ft X \_\_\_\_\_ ft. (center-to-center)

Fixture Type: RECESSED AER (3) 4' WALL (2)

Switching - Type: WALL No. 2

Accessibility to User: OK

Hours of Operation: \_\_\_\_\_

Lamp Model: PHO CW Ballast Model: STD

Lamps/ Fixture	Ballast/ Fixture	No. Fixture	FC	FC	FC
<u>4</u>	<u>2</u>	<u>3</u>	<u>61</u>	_____	_____
<u>2</u>	<u>1</u>	<u>2</u>			

# LIGHTING SURVEY DATA SHEET

BLDG. # 53160

ROOM # \_\_\_\_\_

Area Description: MENS LOCKER

Area Dimensions: 14.5 ft X 20 ft. 91

Fixture Grid: \_\_\_\_\_ ft X \_\_\_\_\_ ft. (center-to-center)

Fixture Type: RECES. 2'x4' ACR (4) 1'x4' ACR (1)

Switching - Type: WALL No. 1

Accessibility to User: OK

Hours of Operation: \_\_\_\_\_

Lamp Model: F40 CW

Ballast Model: STD

Lamps/ Fixture	Ballast/ Fixture	No. Fixture	FC	FC	FC
<u>4</u>	<u>2</u>	<u>4</u>	<u>37</u>	_____	_____
<u>2</u>	<u>1</u>				

-----  
LIGHTING SURVEY DATA SHEET

BLDG. # 53160

ROOM # \_\_\_\_\_

Area Description: COMMON REST ROOMS

Area Dimensions: 10.5 ft X 11 ft. 8'

Fixture Grid: \_\_\_\_\_ ft X \_\_\_\_\_ ft. (center-to-center)

Fixture Type: 1'x4' RECESSED (1) 1'x4' WALL MOUNT (ACRL)

Switching - Type: WALL No. 1

Accessibility to User: OK

Hours of Operation: \_\_\_\_\_

Lamp Model: F40 CW

Ballast Model: STD

Lamps/ Fixture	Ballast/ Fixture	No. Fixture	FC	FC	FC
<u>2</u>	<u>1</u>	<u>2</u>	_____	_____	_____

MEN + Women ARE SAME

# LIGHTING SURVEY DATA SHEET

BLDG. # 53160 ROOM # \_\_\_\_\_

Area Description: HALL

Area Dimensions: 5 ft X 25 ft.

Fixture Grid: \_\_\_\_\_ ft X \_\_\_\_\_ ft. (center-to-center)

Fixture Type: 4'x2' RECESSED ACRYLIC

Switching - Type: WALL No. 1

Accessibility to User: OK

Hours of Operation: \_\_\_\_\_

Lamp Model: F40CW Ballast Model: SLD

<u>Lamps/ Fixture</u>	<u>Ballast/ Fixture</u>	<u>No. Fixture</u>	<u>FC</u>	<u>FC</u>	<u>FC</u>
<u>4</u>	<u>2</u>	<u>1</u>	<u>67</u>	_____	_____

## LIGHTING SURVEY DATA SHEET

BLDG. # \_\_\_\_\_ ROOM # \_\_\_\_\_

Area Description: \_\_\_\_\_

Area Dimensions: \_\_\_\_\_ ft X \_\_\_\_\_ ft.

Fixture Grid: \_\_\_\_\_ ft X \_\_\_\_\_ ft. (center-to-center)

Fixture Type: \_\_\_\_\_

Switching - Type: \_\_\_\_\_ No. \_\_\_\_\_

Accessibility to User: \_\_\_\_\_

Hours of Operation: \_\_\_\_\_

Lamp Model: \_\_\_\_\_ Ballast Model: \_\_\_\_\_

<u>Lamps/ Fixture</u>	<u>Ballast/ Fixture</u>	<u>No. Fixture</u>	<u>FC</u>	<u>FC</u>	<u>FC</u>
_____	_____	_____	_____	_____	_____

# LIGHTING SURVEY DATA SHEET

BLDG. # 60020

ROOM # \_\_\_\_\_

Area Description: PROVOST MARSHALL

Area Dimensions: 13.5 ft X 15 ft. 9' 2"

Fixture Grid: \_\_\_\_\_ ft X \_\_\_\_\_ ft. (center-to-center)

Fixture Type: SEE DRAWINGS

Switching - Type: Wall No. 1

Accessibility to User: \_\_\_\_\_

Hours of Operation: \_\_\_\_\_

Lamp Model: \_\_\_\_\_

Ballast Model: \_\_\_\_\_

Lamps/  
Fixture

Ballast/  
Fixture

No.  
Fixture

FC

FC

FC

2

1

4

34

\_\_\_\_\_

\_\_\_\_\_

## LIGHTING SURVEY DATA SHEET

BLDG. # \_\_\_\_\_

ROOM # \_\_\_\_\_

Area Description: SECURITY SPEC

Area Dimensions: \_\_\_\_\_ ft X \_\_\_\_\_ ft.

Fixture Grid: \_\_\_\_\_ ft X \_\_\_\_\_ ft. (center-to-center)

Fixture Type: \_\_\_\_\_

Switching - Type: \_\_\_\_\_ No. \_\_\_\_\_

Accessibility to User: \_\_\_\_\_

Hours of Operation: \_\_\_\_\_

Lamp Model: \_\_\_\_\_

Ballast Model: \_\_\_\_\_

Lamps/  
Fixture

Ballast/  
Fixture

No.  
Fixture

FC

FC

FC

\_\_\_\_\_

\_\_\_\_\_

\_\_\_\_\_

48

\_\_\_\_\_

\_\_\_\_\_

SAME AS PROV. MARSH

# LIGHTING SURVEY DATA SHEET

BLDG. # \_\_\_\_\_

ROOM # \_\_\_\_\_

Area Description: Room 103

Area Dimensions: 9 ft X \_\_\_\_\_ ft.

Fixture Grid: \_\_\_\_\_ ft X \_\_\_\_\_ ft. (center-to-center)

Fixture Type: \_\_\_\_\_

Switching - Type: \_\_\_\_\_ No. \_\_\_\_\_

Accessibility to User: \_\_\_\_\_

Hours of Operation: \_\_\_\_\_

Lamp Model: \_\_\_\_\_ Ballast Model: \_\_\_\_\_

<u>Lamps/ Fixture</u>	<u>Ballast/ Fixture</u>	<u>No. Fixture</u>	<u>FC</u>	<u>FC</u>	<u>FC</u>
<u>2</u>	<u>1</u>	<u>2</u>	<u>27</u>	_____	_____

## LIGHTING SURVEY DATA SHEET

BLDG. # \_\_\_\_\_

ROOM # \_\_\_\_\_

Area Description: 105

Area Dimensions: 15 ft X 15 ft.

Fixture Grid: \_\_\_\_\_ ft X \_\_\_\_\_ ft. (center-to-center)

Fixture Type: S.M. WRAP AROUND

Switching - Type: WALL No. 1

Accessibility to User: \_\_\_\_\_

Hours of Operation: \_\_\_\_\_

Lamp Model: \_\_\_\_\_ Ballast Model: \_\_\_\_\_

<u>Lamps/ Fixture</u>	<u>Ballast/ Fixture</u>	<u>No. Fixture</u>	<u>FC</u>	<u>FC</u>	<u>FC</u>
<u>2</u>	<u>1</u>	<u>4</u>	<u>39</u>	_____	_____

# LIGHTING SURVEY DATA SHEET

BLDG. # \_\_\_\_\_ ROOM # \_\_\_\_\_

Area Description: 105 A

Area Dimensions: 8 ft X 15 ft.

Fixture Grid: \_\_\_\_\_ ft X \_\_\_\_\_ ft. (center-to-center)

Fixture Type: 4' EGGRATE

Switching - Type: WALL No. 1

Accessibility to User: \_\_\_\_\_

Hours of Operation: \_\_\_\_\_

Lamp Model: \_\_\_\_\_ Ballast Model: \_\_\_\_\_

Lamps/ Fixture	Ballast/ Fixture	No. Fixture	FC	FC	FC
<u>2</u>	<u>1</u>	<u>2</u>	<u>24</u>	_____	_____

## LIGHTING SURVEY DATA SHEET

BLDG. # \_\_\_\_\_ ROOM # \_\_\_\_\_

Area Description: 107

Area Dimensions: 15 ft X 12 ft.

Fixture Grid: \_\_\_\_\_ ft X \_\_\_\_\_ ft. (center-to-center)

Fixture Type: EGGRATE 4'

Switching - Type: WALL No. 1

Accessibility to User: OK

Hours of Operation: \_\_\_\_\_

Lamp Model: \_\_\_\_\_ Ballast Model: \_\_\_\_\_

Lamps/ Fixture	Ballast/ Fixture	No. Fixture	FC	FC	FC
<u>2</u>	<u>1</u>	<u>2</u>	<u>13</u>	_____	_____



# LIGHTING SURVEY DATA SHEET

BLDG. # \_\_\_\_\_

ROOM # \_\_\_\_\_

Area Description: 102

Area Dimensions: 15.5 ft X 15 ft.

Fixture Grid: \_\_\_\_\_ ft X \_\_\_\_\_ ft. (center-to-center)

Fixture Type: E662PASE

Switching - Type: WALL No. 1

Accessibility to User: OK

Hours of Operation: \_\_\_\_\_

Lamp Model: \_\_\_\_\_ Ballast Model: \_\_\_\_\_

Lamps/ Fixture	Ballast/ Fixture	No. Fixture	FC	FC	FC
<u>2</u>	<u>1</u>	<u>4</u>	<u>32</u>	_____	_____

## LIGHTING SURVEY DATA SHEET

BLDG. # \_\_\_\_\_

ROOM # \_\_\_\_\_

Area Description: 104

Area Dimensions: 15 ft X 9.5 ft.

Fixture Grid: \_\_\_\_\_ ft X \_\_\_\_\_ ft. (center-to-center)

Fixture Type: E662PASE

Switching - Type: WALL No. 1

Accessibility to User: OK

Hours of Operation: \_\_\_\_\_

Lamp Model: \_\_\_\_\_ Ballast Model: \_\_\_\_\_

Lamps/ Fixture	Ballast/ Fixture	No. Fixture	FC	FC	FC
<u>4</u>	<u>2</u>	<u>1</u>	<u>31</u>	_____	_____
<u>2</u>	<u>1</u>	<u>1</u>			

# LIGHTING SURVEY DATA SHEET

BLDG. # 60020

ROOM # \_\_\_\_\_

Area Description: BREAK ROOM

Area Dimensions: 13 ft X 15 ft.

Fixture Grid: \_\_\_\_\_ ft X \_\_\_\_\_ ft. (center-to-center)

Fixture Type: EGG CRATE

Switching - Type: WALL No. 1

Accessibility to User: \_\_\_\_\_

Hours of Operation: \_\_\_\_\_

Lamp Model: \_\_\_\_\_ Ballast Model: \_\_\_\_\_

Lamps/ Fixture	Ballast/ Fixture	No. Fixture	FC	FC	FC
<u>2</u>	<u>1</u>	<u>2</u>	<u>15</u>	_____	_____

## LIGHTING SURVEY DATA SHEET

BLDG. # 60020

ROOM # \_\_\_\_\_

Area Description: MENS BATH RM

Area Dimensions: 7 ft X 15 ft.

Fixture Grid: \_\_\_\_\_ ft X \_\_\_\_\_ ft. (center-to-center)

Fixture Type: S.M. WRAP AROUND ACRYLIC

Switching - Type: WALL No. 1

Accessibility to User: OK

Hours of Operation: \_\_\_\_\_

Lamp Model: \_\_\_\_\_ Ballast Model: \_\_\_\_\_

Lamps/ Fixture	Ballast/ Fixture	No. Fixture	FC	FC	FC
<u>2</u>	<u>1</u>	<u>1</u>	<u>23</u>	_____	_____

# LIGHTING SURVEY DATA SHEET

BLDG. # 60020

ROOM # \_\_\_\_\_

Area Description: Wms Rest Room

Area Dimensions: \_\_\_\_\_ ft X \_\_\_\_\_ ft.

Fixture Grid: \_\_\_\_\_ ft X \_\_\_\_\_ ft. (center-to-center)

Fixture Type: 4' SURF GAZET

Switching - Type: WALL No. 1

Accessibility to User: OK

Hours of Operation: \_\_\_\_\_

Lamp Model: \_\_\_\_\_

Ballast Model: \_\_\_\_\_

Lamps/ Fixture	Ballast/ Fixture	No. Fixture	FC	FC	FC
<u>2</u>	<u>1</u>	<u>1</u>	<u>11</u>	_____	_____

## LIGHTING SURVEY DATA SHEET

BLDG. # 34970

ROOM # 1

Area Description: SECRETARY OFFICE

Area Dimensions: 12 ft X 12 ft. 8'

Fixture Grid: \_\_\_\_\_ ft X \_\_\_\_\_ ft. (center-to-center)

Fixture Type: RECESSED ACRYLIC

Switching - Type: WALL No. 1

Accessibility to User: OK

Hours of Operation: 0700 - 1630

Lamp Model: F40 CW

Ballast Model: STD

Lamps/ Fixture	Ballast/ Fixture	No. Fixture	FC	FC	FC
<u>4</u>	<u>2</u>	<u>4</u>	<u>71</u>	_____	_____

# LIGHTING SURVEY DATA SHEET

BLDG. # 60020

ROOM # \_\_\_\_\_

Area Description: Hallways

Area Dimensions: \_\_\_\_\_ ft X \_\_\_\_\_ ft. 9'

Fixture Grid: \_\_\_\_\_ ft X \_\_\_\_\_ ft. (center-to-center)

Fixture Type: S.M. W-A Acrl.

Switching - Type: WS No. 2

Accessibility to User: fair - 1 behind drink machines

Hours of Operation: 24 h/d

Lamp Model: \_\_\_\_\_ Ballast Model: \_\_\_\_\_

	<u>Lamps/ Fixture</u>	<u>Ballast/ Fixture</u>	<u>No. Fixture</u>	<u>FC</u>	<u>FC</u>	<u>FC</u>
<u>fluor</u>	<u>4</u>	<u>2</u>	<u>9</u>	<u>80</u>	<u>65</u>	_____
<u>incand</u>	<u>1</u>	<u>-</u>	<u>1</u>			

New fluors

## LIGHTING SURVEY DATA SHEET

BLDG. # 60020

ROOM # \_\_\_\_\_

Area Description: Storage Training

Area Dimensions: \_\_\_\_\_ ft X \_\_\_\_\_ ft. 8 1/2

Fixture Grid: \_\_\_\_\_ ft X \_\_\_\_\_ ft. (center-to-center)

Fixture Type: Rec'd 2x4 w acryl

Switching - Type: WS No. 2

Accessibility to User: good

Hours of Operation: Intermittent

Lamp Model: \_\_\_\_\_ Ballast Model: \_\_\_\_\_

	<u>Lamps/ Fixture</u>	<u>Ballast/ Fixture</u>	<u>No. Fixture</u>	<u>FC</u>	<u>FC</u>	<u>FC</u>
	<u>2</u>	<u>2</u>	<u>4</u>	<u>30</u>	_____	_____

# LIGHTING SURVEY DATA SHEET

BLDG. # 60020

ROOM # \_\_\_\_\_

Area Description: Locheroom 1

Area Dimensions: \_\_\_\_\_ ft X \_\_\_\_\_ ft.

Fixture Grid: \_\_\_\_\_ ft X \_\_\_\_\_ ft. (center-to-center)

Fixture Type: Rec'd 2x4 w/acryl.

Switching - Type: WS No. 1

Accessibility to User: Fair

Hours of Operation: \_\_\_\_\_

Lamp Model: \_\_\_\_\_ Ballast Model: \_\_\_\_\_

Lamps/ Fixture	Ballast/ Fixture	No. Fixture	FC	FC	FC
<u>4</u>	<u>2</u>	<u>2</u>	<u>37</u>	_____	_____

# LIGHTING SURVEY DATA SHEET

BLDG. # 60020

ROOM # \_\_\_\_\_

Area Description: Foyer

Area Dimensions: \_\_\_\_\_ ft X \_\_\_\_\_ ft.

Fixture Grid: \_\_\_\_\_ ft X \_\_\_\_\_ ft. (center-to-center)

Fixture Type: Rec'd 2x4 w/acryl

Switching - Type: WS No. 1

Accessibility to User: Good

Hours of Operation: \_\_\_\_\_

Lamp Model: \_\_\_\_\_ Ballast Model: \_\_\_\_\_

Lamps/ Fixture	Ballast/ Fixture	No. Fixture	FC	FC	FC
<u>2</u>	_____	<u>1</u>	<u>27</u>	_____	_____

# LIGHTING SURVEY DATA SHEET

BLDG. # 60020

ROOM # 109

Area Description: Investigator  
 Area Dimensions: \_\_\_\_\_ ft X \_\_\_\_\_ ft.  
 Fixture Grid: \_\_\_\_\_ ft X \_\_\_\_\_ ft. (center-to-center)  
 Fixture Type: S.M. Open Egg Crate  
 Switching - Type: WS No. 1  
 Accessibility to User: Good  
 Hours of Operation: \_\_\_\_\_  
 Lamp Model: \_\_\_\_\_ Ballast Model: \_\_\_\_\_

Lamps/ Fixture	Ballast/ Fixture	No. Fixture	FC	FC	FC
<u>4</u>	<u>2</u>	<u>3</u>	<u>70</u>	_____	_____

## LIGHTING SURVEY DATA SHEET

BLDG. # 60020

ROOM # 110

Area Description: Investigator  
 Area Dimensions: \_\_\_\_\_ ft X \_\_\_\_\_ ft.  
 Fixture Grid: \_\_\_\_\_ ft X \_\_\_\_\_ ft. (center-to-center)  
 Fixture Type: Rec'd fl. 2x4 w/acrylic  
 Switching - Type: WS No. 1  
 Accessibility to User: Good  
 Hours of Operation: \_\_\_\_\_  
 Lamp Model: \_\_\_\_\_ Ballast Model: \_\_\_\_\_

Lamps/ Fixture	Ballast/ Fixture	No. Fixture	FC	FC	FC
<u>4</u>	<u>2</u>	<u>2</u>	<u>56</u>	_____	_____

# LIGHTING SURVEY DATA SHEET

BLDG. # \_\_\_\_\_

ROOM # \_\_\_\_\_

Area Description: Radio Room

Area Dimensions: \_\_\_\_\_ ft X \_\_\_\_\_ ft.

Fixture Grid: \_\_\_\_\_ ft X \_\_\_\_\_ ft. (center-to-center)

Fixture Type: \_\_\_\_\_

Switching - Type: \_\_\_\_\_ No. \_\_\_\_\_

Accessibility to User: \_\_\_\_\_

Hours of Operation: \_\_\_\_\_

Lamp Model: \_\_\_\_\_ Ballast Model: \_\_\_\_\_

<u>Lamps/ Fixture</u>	<u>Ballast/ Fixture</u>	<u>No. Fixture</u>	<u>FC</u>	<u>FC</u>	<u>FC</u>
<u>4</u>	<u>2</u>	<u>3</u>	<u>27</u>	_____	_____
<u>2</u>	<u>1</u>	<u>1</u>			

Lights off

## LIGHTING SURVEY DATA SHEET

BLDG. # \_\_\_\_\_

ROOM # \_\_\_\_\_

Area Description: Locker room 2

Area Dimensions: \_\_\_\_\_ ft X \_\_\_\_\_ ft.

Fixture Grid: \_\_\_\_\_ ft X \_\_\_\_\_ ft. (center-to-center)

Fixture Type: Rec'd 2x4 w/aerogl

Switching - Type: WS No. 2 either

Accessibility to User: \_\_\_\_\_

Hours of Operation: \_\_\_\_\_

Lamp Model: \_\_\_\_\_ Ballast Model: \_\_\_\_\_

<u>Lamps/ Fixture</u>	<u>Ballast/ Fixture</u>	<u>No. Fixture</u>	<u>FC</u>	<u>FC</u>	<u>FC</u>
<u>4</u>	<u>2</u>	<u>5</u>	<u>23</u>	_____	_____

Many lamps out

# LIGHTING SURVEY DATA SHEET

BLDG. # 60060

ROOM # \_\_\_\_\_

Area Description: BREAK ROOM

Area Dimensions: 19.5 ft X 24.5 ft. 8'

Fixture Grid: \_\_\_\_\_ ft X \_\_\_\_\_ ft. (center-to-center)

Fixture Type: 2'x4' RECESSED ACRYLIC

Switching - Type: WALL No. 1

Accessibility to User: OK

Hours of Operation: 0630 - 1700

Lamp Model: F40CW

Ballast Model: STD

Lamps/ Fixture	Ballast/ Fixture	No. Fixture	FC	FC	FC
<u>4</u>	<u>2</u>	<u>6</u>	<u>85</u>	_____	_____

## LIGHTING SURVEY DATA SHEET

BLDG. # 60060

ROOM # \_\_\_\_\_

Area Description: HALL

Area Dimensions: 4 ft X 10.5 ft.

Fixture Grid: \_\_\_\_\_ ft X \_\_\_\_\_ ft. (center-to-center)

Fixture Type: SURF WRAP AROUND

Switching - Type: WALL No. 1

Accessibility to User: OK

Hours of Operation: \_\_\_\_\_

Lamp Model: F40CW

Ballast Model: STD

Lamps/ Fixture	Ballast/ Fixture	No. Fixture	FC	FC	FC
<u>2</u>	<u>1</u>	<u>1</u>	<u>53</u>	_____	_____



# LIGHTING SURVEY DATA SHEET

BLDG. # 60060

ROOM # \_\_\_\_\_

Area Description: MENS RM

Area Dimensions: 5 ft X 9.5 ft.

Fixture Grid: \_\_\_\_\_ ft X \_\_\_\_\_ ft. (center-to-center)

Fixture Type: 2'x4' REC. ACZ.

Switching - Type: WALL No. 1

Accessibility to User: OK

Hours of Operation: \_\_\_\_\_

Lamp Model: FWDCW

Ballast Model: STD

Lamps/ Fixture	Ballast/ Fixture	No. Fixture	FC	FC	FC
<u>4</u>	<u>2</u>	<u>1</u>	<u>20</u>	_____	_____

1 60W INCAD

## LIGHTING SURVEY DATA SHEET

BLDG. # 60060

ROOM # \_\_\_\_\_

Area Description: WOMENS RM

Area Dimensions: 10 ft X 9.5 ft.

Fixture Grid: \_\_\_\_\_ ft X \_\_\_\_\_ ft. (center-to-center)

Fixture Type: 2'x4' RECESSED ACZ.

Switching - Type: WALL No. 1

Accessibility to User: OUTSIDE OF BATH RM

Hours of Operation: \_\_\_\_\_

Lamp Model: FWDCW

Ballast Model: STD

Lamps/ Fixture	Ballast/ Fixture	No. Fixture	FC	FC	FC
<u>4</u>	<u>2</u>	<u>1</u>	<u>54</u>	_____	_____

2 18" WALL MOUNT FLOR. 2-TUBES

# LIGHTING SURVEY DATA SHEET

BLDG. # 60060

ROOM # \_\_\_\_\_

Area Description: JANITOR

Area Dimensions: 4 ft X 4 ft.

Fixture Grid: \_\_\_\_\_ ft X \_\_\_\_\_ ft. (center-to-center)

Fixture Type: INCEAD

Switching - Type: WALL No. 1

Accessibility to User: OK

Hours of Operation: \_\_\_\_\_

Lamp Model: 60 W Ballast Model: T

Lamps/ Fixture	Ballast/ Fixture	No. Fixture	FC	FC	FC
<u>1</u>	<u>X</u>	<u>1</u>	<u>10</u>	<u>   </u>	<u>   </u>

## LIGHTING SURVEY DATA SHEET

BLDG. # 60060

ROOM # \_\_\_\_\_

Area Description: Rm. 6 OFFICE

Area Dimensions: 10 ft X 14 ft.

Fixture Grid: \_\_\_\_\_ ft X \_\_\_\_\_ ft. (center-to-center)

Fixture Type: 2' x 4' REC. ACRY

Switching - Type: WALL No. 1

Accessibility to User: OK

Hours of Operation: \_\_\_\_\_

Lamp Model: FWD CW Ballast Model: STD

Lamps/ Fixture	Ballast/ Fixture	No. Fixture	FC	FC	FC
<u>4</u>	<u>2</u>	<u>2</u>	<u>67</u>	<u>   </u>	<u>   </u>

# LIGHTING SURVEY DATA SHEET

BLDG. # 60060

ROOM # \_\_\_\_\_

Area Description: OPEN OFFICE

Area Dimensions: 27.5 ft X 22 ft.

Fixture Grid: \_\_\_\_\_ ft X \_\_\_\_\_ ft. (center-to-center)

Fixture Type: RECESS ACR.

Switching - Type: WALL No. 1

Accessibility to User: OK

Hours of Operation: \_\_\_\_\_

Lamp Model: F40CW Ballast Model: STD

Lamps/ Fixture	Ballast/ Fixture	No. Fixture	FC	FC	FC
<u>4</u>	<u>2</u>	<u>9</u>	<u>44</u>	<u>67</u>	<u>   </u>

## LIGHTING SURVEY DATA SHEET

BLDG. # 60060

ROOM # \_\_\_\_\_

Area Description: Rm 5 OFFICE

Area Dimensions: 13.5 ft X 13 ft.

Fixture Grid: \_\_\_\_\_ ft X \_\_\_\_\_ ft. (center-to-center)

Fixture Type: SAME

Switching - Type: WALL No. 1

Accessibility to User: OK

Hours of Operation: \_\_\_\_\_

Lamp Model: F40CW Ballast Model: STD

Lamps/ Fixture	Ballast/ Fixture	No. Fixture	FC	FC	FC
<u>4</u>	<u>2</u>	<u>2</u>	<u>70</u>	<u>   </u>	<u>   </u>

# LIGHTING SURVEY DATA SHEET

BLDG. # 60060

ROOM # \_\_\_\_\_

Area Description: Rm 6 OFFICE

Area Dimensions: 13 ft X 13.5 ft.

Fixture Grid: \_\_\_\_\_ ft X \_\_\_\_\_ ft. (center-to-center)

Fixture Type: SAME

Switching - Type: WALL No. 1

Accessibility to User: OK

Hours of Operation: \_\_\_\_\_

Lamp Model: PHOEN Ballast Model: STD

Lamps/ Fixture	Ballast/ Fixture	No. Fixture	FC	FC	FC
<u>4</u>	<u>2</u>	<u>2</u>	<u>66</u>	_____	_____

## LIGHTING SURVEY DATA SHEET

BLDG. # 60060

ROOM # \_\_\_\_\_

Area Description: STORAGE

Area Dimensions: 7.5 ft X 8.5 ft.

Fixture Grid: \_\_\_\_\_ ft X \_\_\_\_\_ ft. (center-to-center)

Fixture Type: SURF. MOUNT WRAP AROUND

Switching - Type: WALL No. 1

Accessibility to User: OK

Hours of Operation: \_\_\_\_\_

Lamp Model: PHOEN Ballast Model: STD

Lamps/ Fixture	Ballast/ Fixture	No. Fixture	FC	FC	FC
<u>2</u>	<u>1</u>	<u>1</u>	<u>24</u>	_____	_____

# LIGHTING SURVEY DATA SHEET

BLDG. # 60060

ROOM # \_\_\_\_\_

Area Description: Rm. 3 OFFICE  
 Area Dimensions: 15.5 ft X 17.5 ft.  
 Fixture Grid: \_\_\_\_\_ ft X \_\_\_\_\_ ft. (center-to-center)  
 Fixture Type: 2'x4' RECES  
 Switching - Type: WALL No. 1  
 Accessibility to User: OK  
 Hours of Operation: \_\_\_\_\_  
 Lamp Model: F40CW Ballast Model: STD

Lamps/ Fixture	Ballast/ Fixture	No. Fixture	FC	FC	FC
<u>4</u>	<u>2</u>	<u>4</u>	<u>61</u>	_____	_____

## LIGHTING SURVEY DATA SHEET

BLDG. # 60060

ROOM # \_\_\_\_\_

Area Description: OPEN OFFICE AREA<sup>4</sup>  
 Area Dimensions: 17 ft X 40 ft.  
 Fixture Grid: \_\_\_\_\_ ft X \_\_\_\_\_ ft. (center-to-center)  
 Fixture Type: RECES ACB9  
 Switching - Type: WALL No. 2  
 Accessibility to User: OK  
 Hours of Operation: \_\_\_\_\_  
 Lamp Model: F40CW Ballast Model: STD

Lamps/ Fixture	Ballast/ Fixture	No. Fixture	FC	FC	FC
<u>4</u>	<u>2</u>	<u>9</u>	<u>84</u>	_____	_____

# LIGHTING SURVEY DATA SHEET

BLDG. # 60000 ROOM # \_\_\_\_\_

Area Description: Rm 2 OFFICE

Area Dimensions: 10.5 ft X 17.5 ft.

Fixture Grid: \_\_\_\_\_ ft X \_\_\_\_\_ ft. (center-to-center)

Fixture Type: 2'x4' RECES.

Switching - Type: WALL No. 1

Accessibility to User: OK

Hours of Operation: \_\_\_\_\_

Lamp Model: FUDCW Ballast Model: STD

Lamps/ Fixture	Ballast/ Fixture	No. Fixture	FC	FC	FC
<u>4</u>	<u>2</u>	<u>3</u>	<u>76</u>	_____	_____

## LIGHTING SURVEY DATA SHEET

BLDG. # 60000 ROOM # \_\_\_\_\_

Area Description: Rm #1 OFFICE

Area Dimensions: 15.5 ft X 17.5 ft.

Fixture Grid: \_\_\_\_\_ ft X \_\_\_\_\_ ft. (center-to-center)

Fixture Type: RECES. ACRY.

Switching - Type: WALL No. 1

Accessibility to User: OK

Hours of Operation: \_\_\_\_\_

Lamp Model: FUDCW Ballast Model: STD

Lamps/ Fixture	Ballast/ Fixture	No. Fixture	FC	FC	FC
<u>4</u>	<u>2</u>	<u>4</u>	<u>102</u>	_____	_____

# LIGHTING SURVEY DATA SHEET

BLDG. # 60060

ROOM # \_\_\_\_\_

Area Description: ENTRANCE HALL + ACCOVS

Area Dimensions: 5 ft X 18 ft.

Fixture Grid: \_\_\_\_\_ ft X \_\_\_\_\_ ft. (center-to-center)

Fixture Type: 4' S.M. WRAD

Switching - Type: WALL No. 1

Accessibility to User: OK

Hours of Operation: \_\_\_\_\_

Lamp Model: FLUO2W

Ballast Model: STD

Lamps/ Fixture	Ballast/ Fixture	No. Fixture	FC	FC	FC
<u>2</u>	<u>1</u>	<u>1</u>	<u>53</u>	_____	_____

1 60W INCAD IN ACCOVS

## LIGHTING SURVEY DATA SHEET

BLDG. # \_\_\_\_\_

ROOM # \_\_\_\_\_

Area Description: \_\_\_\_\_

Area Dimensions: \_\_\_\_\_ ft X \_\_\_\_\_ ft.

Fixture Grid: \_\_\_\_\_ ft X \_\_\_\_\_ ft. (center-to-center)

Fixture Type: \_\_\_\_\_

Switching - Type: \_\_\_\_\_ No. \_\_\_\_\_

Accessibility to User: \_\_\_\_\_

Hours of Operation: \_\_\_\_\_

Lamp Model: \_\_\_\_\_

Ballast Model: \_\_\_\_\_

Lamps/ Fixture	Ballast/ Fixture	No. Fixture	FC	FC	FC
_____	_____	_____	_____	_____	_____

# LIGHTING SURVEY ECO CHECK-LIST

BLDG # 60070

ROOM/AREA ENTIRE BUILDING

## A. Reduce/enhance lighting

1. Remove unneeded lamps or fixtures \_\_\_\_\_
2. Reduce indoor lighting where illumination exceeds AEI recommended levels \_\_\_\_\_
3. Increase daylighting \_\_\_\_\_
4. Lower light fixtures \_\_\_\_\_
5. Improve reflection and dispersion with light-colored ceiling and walls \_\_\_\_\_

## B. Improve lighting controls

1. Install occupancy controls to control lighting \_\_\_\_\_ ✓ AS NEEDED
2. Install photocells to lighting near windows \_\_\_\_\_
3. Install additional switches to control lighting arrangements \_\_\_\_\_
4. Use time-clocks to shut off exterior building lights \_\_\_\_\_

## C. Improve lighting efficiency

1. Replace incandescent lamps in kitchen, hallway, and bathroom fixtures with compact fluorescent lamps \_\_\_\_\_
2. Replace incandescent lamps in exit sign fixtures with LED fixtures \_\_\_\_\_
3. Replace incandescent lamps in exit signs with compact fluorescent lamps \_\_\_\_\_
4. Replace standard fluorescent lamps with energy-conserving lamps \_\_\_\_\_ ✓
5. Replace standard fluorescent ballasts with electronic ballasts \_\_\_\_\_ ✓
6. Replace existing fluorescent fixtures with new fixtures having efficient reflectors, electronic ballasts, and energy-conserving lamps \_\_\_\_\_ ✓
7. Use more efficient lighting sources, i.e., upgrade from incandescent to fluorescent, from fluorescent to HID, from mercury vapor to high-pressure sodium, etc. \_\_\_\_\_



# LIGHTING SURVEY DATA SHEET

BLDG. # 63200

ROOM # \_\_\_\_\_

Area Description: T002 Rm

Area Dimensions: \_\_\_\_\_ ft X \_\_\_\_\_ ft.

Fixture Grid: \_\_\_\_\_ ft X \_\_\_\_\_ ft. (center-to-center)

Fixture Type: \_\_\_\_\_

Switching - Type: WALL No. 1

Accessibility to User: OK

Hours of Operation: \_\_\_\_\_

Lamp Model: \_\_\_\_\_

Ballast Model: \_\_\_\_\_

Lamps/ Fixture	Ballast/ Fixture	No. Fixture	FC	FC	FC
_____	_____	<u>5</u>	<u>43</u>	_____	_____

SEE DRAWING FOR DATA

## LIGHTING SURVEY DATA SHEET

BLDG. # 60070

ROOM # \_\_\_\_\_

Area Description: COTTON STORAGE

Area Dimensions: 19 ft X 15 ft. 12' 8"

Fixture Grid: \_\_\_\_\_ ft X \_\_\_\_\_ ft. (center-to-center)

Fixture Type: 8' INDUS. SUSPENDED CLOSED APERTURE / GASKET SURFACE MOUNT  
40W

Switching - Type: WALL No. 1

Accessibility to User: OK

Hours of Operation: \_\_\_\_\_

Lamp Model: 75W-F96T-12 CW

Ballast Model: STD

Lamps/ Fixture	Ballast/ Fixture	No. Fixture	FC	FC	FC
<u>4</u>	<u>2</u>	<u>2</u>	<u>102</u>	<u>16</u>	_____
<u>2</u>	<u>1</u>	<u>4</u>	<u>UNDER 8' FIXTURE</u>	_____	_____

1-EXIT SIGN

# LIGHTING SURVEY DATA SHEET

BLDG. # 60070

ROOM # \_\_\_\_\_

Area Description: OFFICE

Area Dimensions: 8.5 ft X 18.5 ft. 12' 8"

Fixture Grid: \_\_\_\_\_ ft X \_\_\_\_\_ ft. (center-to-center)

Fixture Type: 4' SURF MOUNT GASET

Switching - Type: WALL No. 1

Accessibility to User: OK

Hours of Operation: \_\_\_\_\_

Lamp Model: F40 CW

Ballast Model: STD

Lamps/  
Fixture

Ballast/  
Fixture

No.  
Fixture

FC

FC

FC

2

1

2

19

LOWER LIGHTS

## LIGHTING SURVEY DATA SHEET

BLDG. # 60070

ROOM # \_\_\_\_\_

Area Description: SHOWER

Area Dimensions: 9 ft X 11.5 ft. 8'

Fixture Grid: \_\_\_\_\_ ft X \_\_\_\_\_ ft. (center-to-center)

Fixture Type: 4' GASET SURFACE MOUNT

Switching - Type: WALL No. 1

Accessibility to User: OK

Hours of Operation: \_\_\_\_\_

Lamp Model: \_\_\_\_\_

Ballast Model: \_\_\_\_\_

Lamps/  
Fixture

Ballast/  
Fixture

No.  
Fixture

FC

FC

FC

2

1

2

50

~~NOT~~ USED AS STORAGE RM

# LIGHTING SURVEY DATA SHEET

BLDG. # 60010

ROOM # \_\_\_\_\_

Area Description: MEN'S LOCKER

Area Dimensions: 8.5 ft X 18.5 ft. 12' 8"

Fixture Grid: \_\_\_\_\_ ft X \_\_\_\_\_ ft. (center-to-center)

Fixture Type: 4' GASKET SURFACE MOUNT

Switching - Type: WALL No. 1

Accessibility to User: OK

Hours of Operation: \_\_\_\_\_

Lamp Model: F40 CW

Ballast Model: STD

Lamps/ Fixture	Ballast/ Fixture	No. Fixture	FC	FC	FC
<u>2</u>	<u>1</u>	<u>2</u>	<u>35</u>	_____	_____

## LIGHTING SURVEY DATA SHEET

BLDG. # \_\_\_\_\_

ROOM # \_\_\_\_\_

Area Description: WOMEN'S SHOWER

Area Dimensions: \_\_\_\_\_ ft X \_\_\_\_\_ ft.

Fixture Grid: \_\_\_\_\_ ft X \_\_\_\_\_ ft. (center-to-center)

Fixture Type: \_\_\_\_\_

Switching - Type: \_\_\_\_\_ No. \_\_\_\_\_

Accessibility to User: \_\_\_\_\_

Hours of Operation: \_\_\_\_\_

Lamp Model: \_\_\_\_\_

Ballast Model: \_\_\_\_\_

Lamps/ Fixture	Ballast/ Fixture	No. Fixture	FC	FC	FC
_____	_____	_____	_____	_____	_____

- SAME AS MEN'S SHOWER

# LIGHTING SURVEY DATA SHEET

BLDG. # 60010

ROOM # \_\_\_\_\_

Area Description: HALL

Area Dimensions: 5.5 ft X 17 ft.

Fixture Grid: \_\_\_\_\_ ft X \_\_\_\_\_ ft. (center-to-center)

Fixture Type: GASSET SURFACE

Switching - Type: WALL No. 1

Accessibility to User: OK

Hours of Operation: \_\_\_\_\_

Lamp Model: \_\_\_\_\_

Ballast Model: \_\_\_\_\_

Lamps/  
Fixture

Ballast/  
Fixture

No.  
Fixture

FC

FC

FC

2

1

2

\_\_\_\_\_

\_\_\_\_\_

\_\_\_\_\_

1 - EXIT SIGN

## LIGHTING SURVEY DATA SHEET

BLDG. # 60010

ROOM # \_\_\_\_\_

Area Description: MEN'S RESTROOM

Area Dimensions: 8 ft X 9.5 ft.

Fixture Grid: \_\_\_\_\_ ft X \_\_\_\_\_ ft. (center-to-center)

Fixture Type: 4" GASSET SURFACE MOUNT

Switching - Type: WALL No. 1 NEED O.S.

Accessibility to User: OK

Hours of Operation: \_\_\_\_\_

Lamp Model: \_\_\_\_\_

Ballast Model: \_\_\_\_\_

Lamps/  
Fixture

Ballast/  
Fixture

No.  
Fixture

FC

FC

FC

2

1

2

25

\_\_\_\_\_

\_\_\_\_\_

# LIGHTING SURVEY DATA SHEET

BLDG. # 60070

ROOM # \_\_\_\_\_

Area Description: REPAIR STATION

Area Dimensions: 17 ft X 24.5 ft.

Fixture Grid: \_\_\_\_\_ ft X \_\_\_\_\_ ft. (center-to-center)

Fixture Type: 4' GASKET + ADDIT SHOWN ON DRAWING

Switching - Type: WALL No. 1

Accessibility to User: OK

Hours of Operation: \_\_\_\_\_

Lamp Model: \_\_\_\_\_

Ballast Model: \_\_\_\_\_

Lamps/  
Fixture

Ballast/  
Fixture

No.  
Fixture

FC

FC

FC

2  
4

1  
Q1

12  
1

21

—

—

# LIGHTING SURVEY DATA SHEET

BLDG. # 60070

ROOM # \_\_\_\_\_

Area Description: CONTROL ROOM

Area Dimensions: \_\_\_\_\_ ft X \_\_\_\_\_ ft.

Fixture Grid: \_\_\_\_\_ ft X \_\_\_\_\_ ft. (center-to-center)

Fixture Type: 4' GASKET

Switching - Type: WALL No. 1 NEED O.S.

Accessibility to User: OK

Hours of Operation: \_\_\_\_\_

Lamp Model: \_\_\_\_\_

Ballast Model: \_\_\_\_\_

Lamps/  
Fixture

Ballast/  
Fixture

No.  
Fixture

FC

FC

FC

2

1

2

—

—

—

# LIGHTING SURVEY DATA SHEET

BLDG. # 60090

ROOM # \_\_\_\_\_

Area Description: OFFICE #1

Area Dimensions: 15.5 ft X 15 ft. 10' 8"

Fixture Grid: \_\_\_\_\_ ft X \_\_\_\_\_ ft. (center-to-center)

Fixture Type: 4' EGGRATE - SUSPENDED

Switching - Type: WALL No. 1

Accessibility to User: OK

Hours of Operation: 0630 - 1700 OFF PEAK

Lamp Model: F40CW

Ballast Model: STD

Lamps/ Fixture	Ballast/ Fixture	No. Fixture	FC	FC	FC
<u>4</u>	<u>2</u>	<u>4</u>	<u>43</u>	<u>55</u>	_____

# LIGHTING SURVEY DATA SHEET

BLDG. # 60090

ROOM # \_\_\_\_\_

Area Description: MAIN OFFICE

Area Dimensions: SEE DRAW ft X \_\_\_\_\_ ft.

Fixture Grid: \_\_\_\_\_ ft X \_\_\_\_\_ ft. (center-to-center)

Fixture Type: SAME

Switching - Type: WALL No. 1

Accessibility to User: OK

Hours of Operation: \_\_\_\_\_

Lamp Model: \_\_\_\_\_

Ballast Model: \_\_\_\_\_

Lamps/ Fixture	Ballast/ Fixture	No. Fixture	FC	FC	FC
<u>4</u>	<u>2</u>	<u>7</u>	<u>55</u>	<u>50</u>	_____

# LIGHTING SURVEY DATA SHEET

BLDG. # 60090

ROOM # \_\_\_\_\_

Area Description: ENTRANCE

Area Dimensions: 6 ft X 8 ft.

Fixture Grid: \_\_\_\_\_ ft X \_\_\_\_\_ ft. (center-to-center)

Fixture Type: SAME

Switching - Type: WALL No. 1

Accessibility to User: OK

Hours of Operation: \_\_\_\_\_

Lamp Model: \_\_\_\_\_

Ballast Model: \_\_\_\_\_

Lamps/ Fixture	Ballast/ Fixture	No. Fixture	FC	FC	FC
<u>4</u>	<u>2</u>	<u>1</u>	<u>69</u>	_____	_____

## ----- LIGHTING SURVEY DATA SHEET

BLDG. # 60090

ROOM # \_\_\_\_\_

Area Description: OFFICE #2

Area Dimensions: 19.75 ft X 9.5 ft.

Fixture Grid: \_\_\_\_\_ ft X \_\_\_\_\_ ft. (center-to-center)

Fixture Type: SAME

Switching - Type: WALL No. 1

Accessibility to User: OK

Hours of Operation: \_\_\_\_\_

Lamp Model: \_\_\_\_\_

Ballast Model: \_\_\_\_\_

Lamps/ Fixture	Ballast/ Fixture	No. Fixture	FC	FC	FC
<u>4</u>	<u>2</u>	<u>3</u>	<u>37</u>	_____	_____

# LIGHTING SURVEY DATA SHEET

BLDG. # 60090

ROOM # \_\_\_\_\_

Area Description: FILE AREA

Area Dimensions: 11.75 ft X 22.75 ft.

Fixture Grid: \_\_\_\_\_ ft X \_\_\_\_\_ ft. (center-to-center)

Fixture Type: SAME

Switching - Type: WALL No. 1

Accessibility to User: OK

Hours of Operation: \_\_\_\_\_

Lamp Model: \_\_\_\_\_

Ballast Model: \_\_\_\_\_

Lamps/  
Fixture

Ballast/  
Fixture

No.  
Fixture

FC

FC

FC

4

2

7

50

## LIGHTING SURVEY DATA SHEET

BLDG. # 60090

ROOM # \_\_\_\_\_

Area Description: OFFICE #3

Area Dimensions: 13.75 ft X 9.75 ft.

Fixture Grid: \_\_\_\_\_ ft X \_\_\_\_\_ ft. (center-to-center)

Fixture Type: SAME

Switching - Type: WALL No. 1

Accessibility to User: OK

Hours of Operation: \_\_\_\_\_

Lamp Model: \_\_\_\_\_

Ballast Model: \_\_\_\_\_

Lamps/  
Fixture

Ballast/  
Fixture

No.  
Fixture

FC

FC

FC

4

2

2

38



# LIGHTING SURVEY DATA SHEET

BLDG. # 60090

ROOM # \_\_\_\_\_

Area Description: KITCHEN

Area Dimensions: 9.75 ft X 11.75 ft.

Fixture Grid: \_\_\_\_\_ ft X \_\_\_\_\_ ft. (center-to-center)

Fixture Type: SAME

Switching - Type: WALL No. 1

Accessibility to User: OK

Hours of Operation: \_\_\_\_\_

Lamp Model: \_\_\_\_\_ Ballast Model: \_\_\_\_\_

Lamps/ Fixture	Ballast/ Fixture	No. Fixture	FC	FC	FC
<u>4</u>	<u>2</u>	<u>2</u>	<u>54</u>	_____	_____

# LIGHTING SURVEY DATA SHEET

BLDG. # 60090

ROOM # \_\_\_\_\_

Area Description: HALL

Area Dimensions: 8.25 ft X 10.25 ft. + SEE DRAWING

Fixture Grid: \_\_\_\_\_ ft X \_\_\_\_\_ ft. (center-to-center)

Fixture Type: SAME

Switching - Type: WALL No. 1

Accessibility to User: OK

Hours of Operation: \_\_\_\_\_

Lamp Model: \_\_\_\_\_ Ballast Model: \_\_\_\_\_

Lamps/ Fixture	Ballast/ Fixture	No. Fixture	FC	FC	FC
<u>4</u>	<u>2</u>	<u>3</u>	<u>57</u>	_____	_____

# LIGHTING SURVEY DATA SHEET

BLDG. # 60090

ROOM # \_\_\_\_\_

Area Description: Wms. RM

Area Dimensions: 5 ft X DRAWNB ft.

Fixture Grid: \_\_\_\_\_ ft X \_\_\_\_\_ ft. (center-to-center)

Fixture Type: INCAD

Switching - Type: WALL No. 1

Accessibility to User: OK

Hours of Operation: \_\_\_\_\_

Lamp Model: 60 W

Ballast Model: X

Lamps/ Fixture	Ballast/ Fixture	No. Fixture	FC	FC	FC
<u>2</u>	<u>X</u>	<u>2</u>	<u>50</u>	<u>25</u>	_____
<u>1</u>	<u>X</u>	<u>1</u>	<u>TOILET</u>	<u>ENTRANCE</u>	_____

## LIGHTING SURVEY DATA SHEET

BLDG. # 60090

ROOM # \_\_\_\_\_

Area Description: MENS RM

Area Dimensions: 5.75 ft X DRAWNB ft.

Fixture Grid: \_\_\_\_\_ ft X \_\_\_\_\_ ft. (center-to-center)

Fixture Type: INCAD

Switching - Type: WALL No. 1

Accessibility to User: OK

Hours of Operation: \_\_\_\_\_

Lamp Model: \_\_\_\_\_

Ballast Model: \_\_\_\_\_

Lamps/ Fixture	Ballast/ Fixture	No. Fixture	FC	FC	FC
<u>2</u>	<u>X</u>	<u>1</u>	<u>21</u>	_____	_____
<u>1</u>	<u>X</u>	<u>1</u>	_____	_____	_____

# LIGHTING SURVEY DATA SHEET

BLDG. # 10-630

ROOM # \_\_\_\_\_

Area Description: WAREHOUSE AREA

Area Dimensions: SEE DRAW. ft X \_\_\_\_\_ ft.

Fixture Grid: \_\_\_\_\_ ft X \_\_\_\_\_ ft. (center-to-center)

Fixture Type: 150 HIGH PRESS SODIUM

Switching - Type: \_\_\_\_\_ No. \_\_\_\_\_

Accessibility to User: \_\_\_\_\_

Hours of Operation: 0630-1700 (4 DAYS)

Lamp Model: \_\_\_\_\_ Ballast Model: \_\_\_\_\_

<u>Lamps/ Fixture</u>	<u>Ballast/ Fixture</u>	<u>No. Fixture</u>	<u>FC</u>	<u>FC</u>	<u>FC</u>
_____	_____	<u>18</u>	<u>Avg 4-6</u>	_____	_____

12' HIGH FIXTURES

# LIGHTING SURVEY DATA SHEET

BLDG. # 60-630

ROOM # \_\_\_\_\_

Area Description: SHIPPING PREP.

Area Dimensions: 24 ft X 41 ft.

Fixture Grid: \_\_\_\_\_ ft X \_\_\_\_\_ ft. (center-to-center)

Fixture Type: EXTRACTION PROOF - 150W INCLAD.

Switching - Type: \_\_\_\_\_ No. \_\_\_\_\_

Accessibility to User: \_\_\_\_\_

Hours of Operation: \_\_\_\_\_

Lamp Model: \_\_\_\_\_ Ballast Model: \_\_\_\_\_

<u>Lamps/ Fixture</u>	<u>Ballast/ Fixture</u>	<u>No. Fixture</u>	<u>FC</u>	<u>FC</u>	<u>FC</u>
_____	_____	<u>9</u>	<u>8</u>	_____	_____

CELL - 9 1/2'  
FIXTURE HEIGHT - 2 1/2'

# LIGHTING SURVEY DATA SHEET

BLDG. # 60-630

ROOM # \_\_\_\_\_

Area Description: BREAK ROOM

Area Dimensions: 16'3" ft X 13'3" ft.

Fixture Grid: \_\_\_\_\_ ft X \_\_\_\_\_ ft. (center-to-center)

Fixture Type: RECESSED ACRYLIC

Switching - Type: WALL No. 1

Accessibility to User: OK

Hours of Operation: \_\_\_\_\_

Lamp Model: F40CW

Ballast Model: STD - ACTUALLY

Lamps/  
Fixture

Ballast/  
Fixture

No.  
Fixture

FC

FC

FC

AT-BALLAST

4

2

2

50

\_\_\_\_\_

\_\_\_\_\_

8' - CELL.

## LIGHTING SURVEY DATA SHEET

BLDG. # 60-630

ROOM # \_\_\_\_\_

Area Description: WOMEN'S REST ROOM

Area Dimensions: \_\_\_\_\_ ft X \_\_\_\_\_ ft.

Fixture Grid: \_\_\_\_\_ ft X \_\_\_\_\_ ft. (center-to-center)

Fixture Type: 4' S.M. W.L.

Switching - Type: WALL No. 1

Accessibility to User: OK

Hours of Operation: \_\_\_\_\_

Lamp Model: 40W

Ballast Model: STD

Lamps/  
Fixture

Ballast/  
Fixture

No.  
Fixture

FC

FC

FC

2

1

2

35

\_\_\_\_\_

\_\_\_\_\_

1 Fixture is MOUNTED ON WALL - 7' HIGH

# LIGHTING SURVEY DATA SHEET

BLDG. # 60-630

ROOM # \_\_\_\_\_

Area Description: MENS REST ROOM

Area Dimensions: 17' 8" ft X 13' 3" ft.

Fixture Grid: \_\_\_\_\_ ft X \_\_\_\_\_ ft. (center-to-center)

Fixture Type: S.M.W.L.

Switching - Type: WALL No. 1

Accessibility to User: OK

Hours of Operation: \_\_\_\_\_

Lamp Model: \_\_\_\_\_

Ballast Model: \_\_\_\_\_

Lamps/  
Fixture

Ballast/  
Fixture

No.  
Fixture

FC

FC

FC

2

1

3

35

9' CELL

# LIGHTING SURVEY DATA SHEET

BLDG. # 60-630

ROOM # \_\_\_\_\_

Area Description: MENS SHOWERS

Area Dimensions: INCLUDED IN ft X \_\_\_\_\_ ft.

Fixture Grid: MENS RM ft X \_\_\_\_\_ ft. (center-to-center)

Fixture Type: INCLAD - 75W EVIDENCE (1)

Switching - Type: WALL No. 1

Accessibility to User: OK

Hours of Operation: \_\_\_\_\_

Lamp Model: \_\_\_\_\_

Ballast Model: \_\_\_\_\_

Lamps/  
Fixture

Ballast/  
Fixture

No.  
Fixture

FC

FC

FC

3

9' CELL

# LIGHTING SURVEY DATA SHEET

BLDG. # 1030

ROOM # \_\_\_\_\_

Area Description: STORAGE ROOM

Area Dimensions: 5'8" ft X 13'3" ft.

Fixture Grid: \_\_\_\_\_ ft X \_\_\_\_\_ ft. (center-to-center)

Fixture Type: 4' WET LOCATION

Switching - Type: WALL No. 1

Accessibility to User: OK

Hours of Operation: \_\_\_\_\_

Lamp Model: F4DCW Ballast Model: STD

Lamps/ Fixture	Ballast/ Fixture	No. Fixture	FC	FC	FC
<u>2</u>	<u>1</u>	<u>1</u>	<u>13</u>	<u>  </u>	<u>  </u>

Fixture is S.M. TYPE BUT IS MOUNTED ON WALL 8' HIGH

## LIGHTING SURVEY DATA SHEET

BLDG. # \_\_\_\_\_

ROOM # \_\_\_\_\_

Area Description: OFFICE

Area Dimensions: 10'10" ft X 12 ft.

Fixture Grid: \_\_\_\_\_ ft X \_\_\_\_\_ ft. (center-to-center)

Fixture Type: 4' S.M.W.L.

Switching - Type: WALL No. 1

Accessibility to User: OK

Hours of Operation: \_\_\_\_\_

Lamp Model: 4DW Ballast Model: STD

Lamps/ Fixture	Ballast/ Fixture	No. Fixture	FC	FC	FC
<u>1</u>	<u>1</u>	<u>3</u>	<u>42</u>	<u>  </u>	<u>  </u>

LEIL. 2'

# LIGHTING SURVEY ECO CHECK-LIST

BLDG # 65100

ROOM/AREA ENTIRE BUILDING

## A. Reduce/enhance lighting

1. Remove unneeded lamps or fixtures \_\_\_\_\_
2. Reduce indoor lighting where illumination exceeds AEI recommended levels \_\_\_\_\_
3. Increase daylighting \_\_\_\_\_
4. Lower light fixtures \_\_\_\_\_
5. Improve reflection and dispersion with light-colored ceiling and walls \_\_\_\_\_

## B. Improve lighting controls

1. Install occupancy controls to control lighting \_\_\_\_\_
2. Install photocells to lighting near windows \_\_\_\_\_
3. Install additional switches to control lighting arrangements \_\_\_\_\_
4. Use time-clocks to shut off exterior building lights \_\_\_\_\_

## C. Improve lighting efficiency

1. Replace incandescent lamps in kitchen, hallway, and bathroom fixtures with compact fluorescent lamps \_\_\_\_\_
2. Replace incandescent lamps in exit sign fixtures with LED fixtures \_\_\_\_\_
3. Replace incandescent lamps in exit signs with compact fluorescent lamps \_\_\_\_\_
4. Replace standard fluorescent lamps with energy-conserving lamps ✓
5. Replace standard fluorescent ballasts with electronic ballasts ✓
6. Replace existing fluorescent fixtures with new fixtures having efficient reflectors, electronic ballasts, and energy-conserving lamps ✓
7. Use more efficient lighting sources, i.e., upgrade from incandescent to fluorescent, from fluorescent to HID, from mercury vapor to high-pressure sodium, etc. \_\_\_\_\_

# LIGHTING SURVEY DATA SHEET

BLDG. # 63100

ROOM # \_\_\_\_\_

Area Description: OFFICE - #1

Area Dimensions: 19 ft X 16.5 ft.

Fixture Grid: \_\_\_\_\_ ft X \_\_\_\_\_ ft. (center-to-center)

Fixture Type: INDUSTRIAL SURFACE MOUNT CLOSED APERTURE

Switching - Type: WALL No. 1

Accessibility to User: OK

Hours of Operation: 0630 - 1630 4 DAYS

Lamp Model: 8' - 60W 4' - 40W

Ballast Model: \_\_\_\_\_

	Lamps/ Fixture	Ballast/ Fixture	No. Fixture	FC	FC	FC
4'	<u>2</u>	<u>1</u>	<u>4</u>	<u>45</u>	<u>40</u>	_____
8' -	<u>4</u>	<u>2</u>	<u>2</u>			

2 Lamps out in 8' Fix.

## LIGHTING SURVEY DATA SHEET

BLDG. # 63100

ROOM # \_\_\_\_\_

Area Description: WOMENS REST ROOM

Area Dimensions: 8 ft X 12 ft. 10'

Fixture Grid: \_\_\_\_\_ ft X \_\_\_\_\_ ft. (center-to-center)

Fixture Type: \_\_\_\_\_

Switching - Type: \_\_\_\_\_ No. \_\_\_\_\_

Accessibility to User: \_\_\_\_\_

Hours of Operation: \_\_\_\_\_

Lamp Model: \_\_\_\_\_

Ballast Model: \_\_\_\_\_

	Lamps/ Fixture	Ballast/ Fixture	No. Fixture	FC	FC	FC
	<u>2</u>	<u>1</u>	<u>2</u>	<u>37</u>	_____	_____



# LIGHTING SURVEY DATA SHEET

BLDG. # 63100

ROOM # \_\_\_\_\_

Area Description: OFFICE #2

Area Dimensions: 11 ft X 12.5 ft.

Fixture Grid: \_\_\_\_\_ ft X \_\_\_\_\_ ft. (center-to-center)

Fixture Type: SURFACE MOUNT - ACRYLIC

Switching - Type: WALL No. 1

Accessibility to User: BAD LOCATION

Hours of Operation: \_\_\_\_\_

Lamp Model: 1

Ballast Model: 111

Lamps/ Fixture	Ballast/ Fixture	No. Fixture	FC	FC	FC
<u>4</u>	<u>2</u>	<u>2</u>	<u>72</u>	<u>   </u>	<u>   </u>

## ----- LIGHTING SURVEY DATA SHEET

BLDG. # 63100

ROOM # \_\_\_\_\_

Area Description: MAST-SUIT DISTRIBUTION

Area Dimensions: 27 ft X 52 ft. + 36 X 24

Fixture Grid: \_\_\_\_\_ ft X \_\_\_\_\_ ft. (center-to-center)

Fixture Type: 2'x4' RECESSED ACRYLIC

Switching - Type: WALL No. 3

Accessibility to User: OK

Hours of Operation: \_\_\_\_\_

Lamp Model: F40 CW

Ballast Model: MAZE ETI

Lamps/ Fixture	Ballast/ Fixture	No. Fixture	FC	FC	FC
<u>4</u>	<u>2</u>	<u>26</u>	<u>28</u>	<u>32</u>	<u>   </u>

# LIGHTING SURVEY DATA SHEET

BLDG. # 63100

ROOM # \_\_\_\_\_

Area Description: TRAINING ROOM

Area Dimensions: 23 ft X 15 ft.

Fixture Grid: \_\_\_\_\_ ft X \_\_\_\_\_ ft. (center-to-center)

Fixture Type: SAME AS MASTER

Switching - Type: WALL No. 1

Accessibility to User: OK

Hours of Operation: \_\_\_\_\_

Lamp Model: F40 CW

Ballast Model: M - III

Lamps/ Fixture	Ballast/ Fixture	No. Fixture	FC	FC	FC
<u>4</u>	<u>2</u>	<u>3</u>	<u>29</u>	_____	_____

## LIGHTING SURVEY DATA SHEET

BLDG. # 63100

ROOM # \_\_\_\_\_

Area Description: HALL #1

Area Dimensions: 5 ft X 20 ft.

Fixture Grid: \_\_\_\_\_ ft X \_\_\_\_\_ ft. (center-to-center)

Fixture Type: 4' INDUS

Switching - Type: WALL No. 1

Accessibility to User: OK

Hours of Operation: \_\_\_\_\_

Lamp Model: F40 CW

Ballast Model: \_\_\_\_\_

Lamps/ Fixture	Ballast/ Fixture	No. Fixture	FC	FC	FC
<u>2</u>	<u>1</u>	<u>4</u>	<u>45</u>	_____	_____

# LIGHTING SURVEY DATA SHEET

BLDG. # 63100

ROOM # \_\_\_\_\_

Area Description: MENS RM

Area Dimensions: 11 ft X 13.5 ft.

Fixture Grid: \_\_\_\_\_ ft X \_\_\_\_\_ ft. (center-to-center)

Fixture Type: 4' INDUS

Switching - Type: WALL No. 1

Accessibility to User: OK

Hours of Operation: \_\_\_\_\_

Lamp Model: \_\_\_\_\_ Ballast Model: \_\_\_\_\_

Lamps/ Fixture	Ballast/ Fixture	No. Fixture	FC	FC	FC
<u>2</u>	<u>1</u>	<u>2</u>	<u>47</u>	—	—

## LIGHTING SURVEY DATA SHEET

BLDG. # 63100

ROOM # \_\_\_\_\_

Area Description: CHANGE ROOM

Area Dimensions: 15 ft X 13 ft.

Fixture Grid: \_\_\_\_\_ ft X \_\_\_\_\_ ft. (center-to-center)

Fixture Type: 4' INDUS

Switching - Type: WALL No. 1

Accessibility to User: OK

Hours of Operation: \_\_\_\_\_

Lamp Model: P40CW Ballast Model: \_\_\_\_\_

Lamps/ Fixture	Ballast/ Fixture	No. Fixture	FC	FC	FC
<u>2</u>	<u>1</u>	<u>4</u>	<u>37</u>	—	—

HEATER IN ROOM (SPACE HEAT) BLOWING CONT.

# LIGHTING SURVEY DATA SHEET

BLDG. # 63100

ROOM # \_\_\_\_\_

Area Description: HALL #2

Area Dimensions: 7 ft X \_\_\_\_\_ ft.

Fixture Grid: \_\_\_\_\_ ft X \_\_\_\_\_ ft. (center-to-center)

Fixture Type: 4' INDUSTRIAL

Switching - Type: WALL No. 1

Accessibility to User: OK

Hours of Operation: \_\_\_\_\_

Lamp Model: F40 CW Ballast Model: \_\_\_\_\_

Lamps/ Fixture	Ballast/ Fixture	No. Fixture	FC	FC	FC
<u>2</u>	<u>1</u>	<u>8</u>	<u>18</u>	<u>20</u>	_____

FIXTURE HEIGHT - 10'

## ----- LIGHTING SURVEY DATA SHEET

BLDG. # 63100

ROOM # \_\_\_\_\_

Area Description: BREAK RM

Area Dimensions: 16 ft X 24 ft. 8'

Fixture Grid: \_\_\_\_\_ ft X \_\_\_\_\_ ft. (center-to-center)

Fixture Type: 8' INDUS. SURF MOUNT

Switching - Type: WALL No. 1 NEED O.S

Accessibility to User: OK

Hours of Operation: \_\_\_\_\_

Lamp Model: F60 CW Ballast Model: \_\_\_\_\_

Lamps/ Fixture	Ballast/ Fixture	No. Fixture	FC	FC	FC
<u>2</u>	<u>1</u>	<u>2</u>	<u>18</u>	_____	_____

# LIGHTING SURVEY DATA SHEET

BLDG. # 63160

ROOM # \_\_\_\_\_

Area Description: STORAGE AREA

Area Dimensions: 42 ft X 31 ft. + 18 x 30

Fixture Grid: \_\_\_\_\_ ft X \_\_\_\_\_ ft. (center-to-center)

Fixture Type: 8' INDUS.

Switching - Type: WALL No. \_\_\_\_\_

Accessibility to User: OK

Hours of Operation: \_\_\_\_\_

Lamp Model: F60CW Ballast Model: \_\_\_\_\_

Lamps/ Fixture	Ballast/ Fixture	No. Fixture	FC	FC	FC
<u>2</u>	<u>1</u>	<u>12</u>	<u>42</u>	<u>47</u>	<u>   </u>

FIXTURE HEIGHT - 13

## LIGHTING SURVEY DATA SHEET

BLDG. # 63100

ROOM # \_\_\_\_\_

Area Description: CLEAN ROOM

Area Dimensions: 60 ft X 40 ft. 9'8"

Fixture Grid: \_\_\_\_\_ ft X \_\_\_\_\_ ft. (center-to-center)

Fixture Type: INDUS. SUR

Switching - Type: WALL No. \_\_\_\_\_

Accessibility to User: OK

Hours of Operation: \_\_\_\_\_

Lamp Model: F60CW Ballast Model: \_\_\_\_\_

Lamps/ Fixture	Ballast/ Fixture	No. Fixture	FC	FC	FC
<u>2</u>	<u>1</u>	<u>29</u>	<u>112</u>	<u>61</u>	<u>   </u>
<u>4</u>	<u>2</u>	<u>3</u>			

**RS&H**

SUBJECT \_\_\_\_\_  
DESIGNER \_\_\_\_\_  
CHECKER \_\_\_\_\_

AEP NO \_\_\_\_\_  
SHEET \_\_\_\_\_ OF \_\_\_\_\_  
DATE \_\_\_\_\_  
DATE \_\_\_\_\_

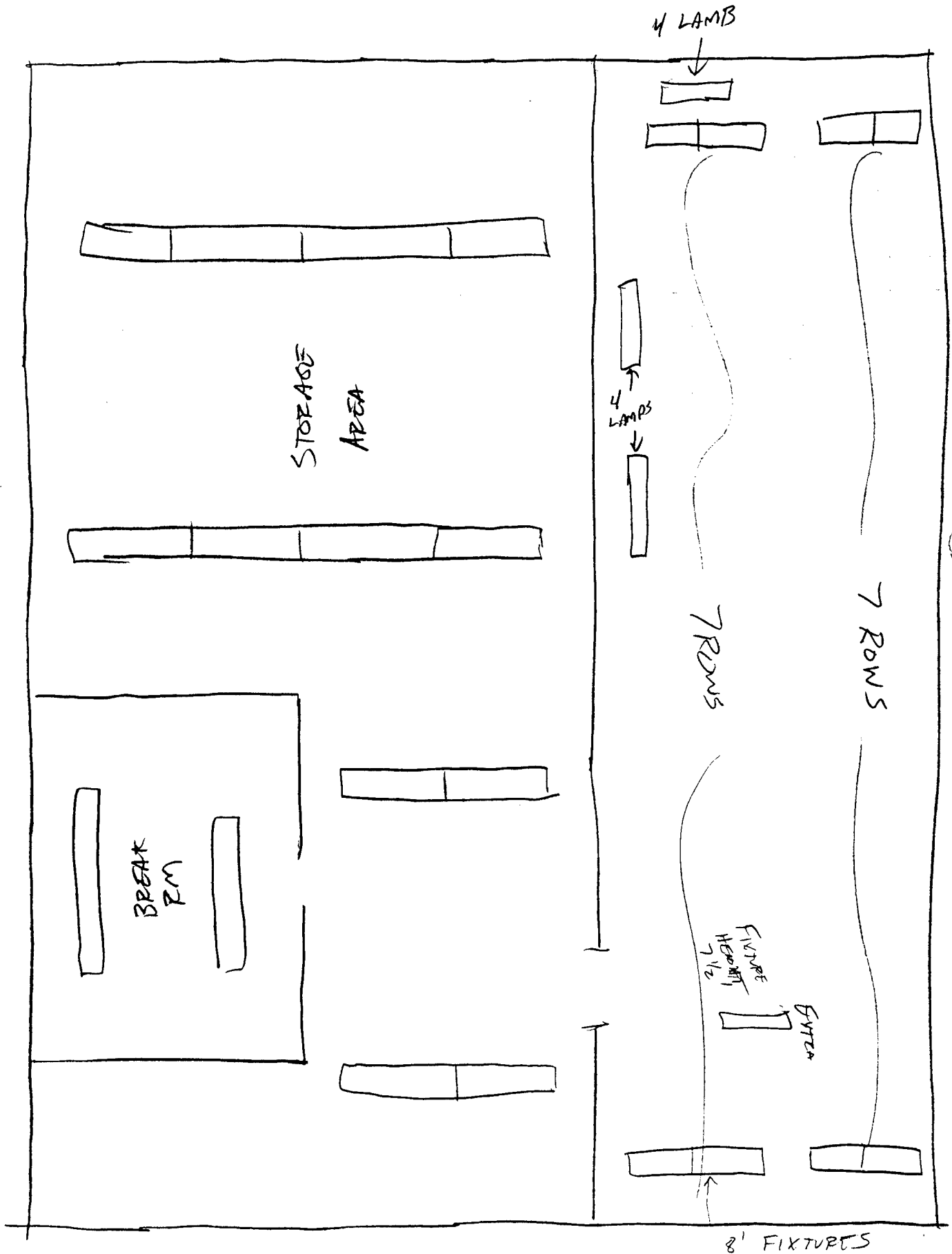

# LIGHTING SURVEY ECO CHECK-LIST

BLDG # 63110

ROOM/AREA ENTIRE BUILDING

## A. Reduce/enhance lighting

1. Remove unneeded lamps or fixtures ☐
2. Reduce indoor lighting where illumination exceeds AEI recommended levels ☐
3. Increase daylighting ☐
4. Lower light fixtures ☐
5. Improve reflection and dispersion with light-colored ceiling and walls ☐

## B. Improve lighting controls

1. Install occupancy controls to control lighting ☐
2. Install photocells to lighting near windows ☐
3. Install additional switches to control lighting arrangements ☐
4. Use time-clocks to shut off exterior building lights ☐

## C. Improve lighting efficiency

1. Replace incandescent lamps in kitchen, hallway, and bathroom fixtures with compact fluorescent lamps ☐
2. Replace incandescent lamps in exit sign fixtures with LED fixtures ☐
3. Replace incandescent lamps in exit signs with compact fluorescent lamps ☐
4. Replace standard fluorescent lamps with energy-conserving lamps ☒
5. Replace standard fluorescent ballasts with electronic ballasts ☒
6. Replace existing fluorescent fixtures with new fixtures having efficient reflectors, electronic ballasts, and energy-conserving lamps ☒
7. Use more efficient lighting sources, i.e., upgrade from incandescent to fluorescent, from fluorescent to HID, from mercury vapor to high-pressure sodium, etc. ☐

\* THIS BUILDING IS NOT CURRENTLY  
BEING USED

# LIGHTING SURVEY DATA SHEET

BLDG. # 63110

ROOM # \_\_\_\_\_

Area Description: LAYOUT #1  
 Area Dimensions: 64 ft X 82 ft. 9'  
 Fixture Grid: \_\_\_\_\_ ft X \_\_\_\_\_ ft. (center-to-center)  
 Fixture Type: RECESSED 2'x4' ACRYLIC  
 Switching - Type: WALL No. \_\_\_\_\_  
 Accessibility to User: OK  
 Hours of Operation: \_\_\_\_\_  
 Lamp Model: \_\_\_\_\_ Ballast Model: \_\_\_\_\_

Lamps/ Fixture	Ballast/ Fixture	No. Fixture	FC	FC	FC
<u>4</u>	<u>2</u>	<u>45</u>	<u>37</u>	_____	_____

2 EXIT SIGNS

## LIGHTING SURVEY DATA SHEET

BLDG. # 63110

ROOM # \_\_\_\_\_

Area Description: LAYOUT #2  
 Area Dimensions: ~~34~~ 43 ft X 64 ft.  
 Fixture Grid: \_\_\_\_\_ ft X \_\_\_\_\_ ft. (center-to-center)  
 Fixture Type: 8' INDUSTRIAL CLOSED AOE  
 Switching - Type: WALL No. 2  
 Accessibility to User: OK  
 Hours of Operation: \_\_\_\_\_  
 Lamp Model: F96 T-12 75W Ballast Model: STD

Lamps/ Fixture	Ballast/ Fixture	No. Fixture	FC	FC	FC
<u>4</u>	<u>2</u>	<u>9</u>	<u>62</u>	_____	_____

Fixture 11'



# LIGHTING SURVEY DATA SHEET

BLDG. # 63110

ROOM # \_\_\_\_\_

Area Description: TESTING

Area Dimensions: 18 ft X 7 ft.

Fixture Grid: \_\_\_\_\_ ft X \_\_\_\_\_ ft. (center-to-center)

Fixture Type: SURFACE MOUNTED WIZARD AROUND - 4'

Switching - Type: WALL No. 1

Accessibility to User: OK

Hours of Operation: \_\_\_\_\_

Lamp Model: F40 CW

Ballast Model: \_\_\_\_\_

Lamps/  
Fixture

Ballast/  
Fixture

No.  
Fixture

FC

FC

FC

2

1

3

40

\_\_\_\_\_

\_\_\_\_\_

-----  
LIGHTING SURVEY DATA SHEET

BLDG. # 63110

ROOM # \_\_\_\_\_

Area Description: BONDING

Area Dimensions: 18 ft X 28 ft.

Fixture Grid: \_\_\_\_\_ ft X \_\_\_\_\_ ft. (center-to-center)

Fixture Type: RECESSED ACRYLIC 2' X 4'

Switching - Type: WALL No. 1

Accessibility to User: OK

Hours of Operation: \_\_\_\_\_

Lamp Model: \_\_\_\_\_

Ballast Model: \_\_\_\_\_

Lamps/  
Fixture

Ballast/  
Fixture

No.  
Fixture

FC

FC

FC

4

2

6

27

47

\_\_\_\_\_

# LIGHTING SURVEY DATA SHEET

BLDG. # 63110

ROOM # \_\_\_\_\_

Area Description: STORAGE A  
 Area Dimensions: 11 ft X 15 ft. 8.5'  
 Fixture Grid: \_\_\_\_\_ ft X \_\_\_\_\_ ft. (center-to-center)  
 Fixture Type: SURFACE Mount 2x4 WRAP Beam  
 Switching - Type: WALL No. 1  
 Accessibility to User: OK  
 Hours of Operation: \_\_\_\_\_  
 Lamp Model: F40 CW Ballast Model: \_\_\_\_\_

Lamps/ Fixture	Ballast/ Fixture	No. Fixture	FC	FC	FC
<u>4</u>	<u>2</u>	<u>2</u>	<u>58</u>	_____	_____

-----  
 LIGHTING SURVEY DATA SHEET

BLDG. # 63110

ROOM # \_\_\_\_\_

Area Description: SMOKE BREAK  
 Area Dimensions: 12.5 ft X 13 ft.  
 Fixture Grid: \_\_\_\_\_ ft X \_\_\_\_\_ ft. (center-to-center)  
 Fixture Type: RECESSED ACRYLIC 2x4  
 Switching - Type: WALL No. 1  
 Accessibility to User: OK  
 Hours of Operation: \_\_\_\_\_  
 Lamp Model: \_\_\_\_\_ Ballast Model: \_\_\_\_\_

Lamps/ Fixture	Ballast/ Fixture	No. Fixture	FC	FC	FC
<u>4</u>	<u>2</u>	<u>3</u>	<u>39</u>	_____	_____

# LIGHTING SURVEY DATA SHEET

BLDG. # 63110

ROOM # \_\_\_\_\_

Area Description: BREAK ROOM

Area Dimensions: 15.5 ft X 20 ft. 8'

Fixture Grid: \_\_\_\_\_ ft X \_\_\_\_\_ ft. (center-to-center)

Fixture Type: RECESSED

Switching - Type: WALL No. 1

Accessibility to User: OK

Hours of Operation: \_\_\_\_\_

Lamp Model: \_\_\_\_\_

Ballast Model: \_\_\_\_\_

Lamps/  
Fixture

Ballast/  
Fixture

No.  
Fixture

FC

FC

FC

4

2

3

49

\_\_\_\_\_

\_\_\_\_\_

## LIGHTING SURVEY DATA SHEET

BLDG. # \_\_\_\_\_

ROOM # \_\_\_\_\_

Area Description: BATHROOM (2 IDENTICAL)

Area Dimensions: 10.5 ft X 10.5 ft.

Fixture Grid: \_\_\_\_\_ ft X \_\_\_\_\_ ft. (center-to-center)

Fixture Type: 4' WRAP AROUND

Switching - Type: WALL No. 1

Accessibility to User: OK

Hours of Operation: \_\_\_\_\_

Lamp Model: \_\_\_\_\_

Ballast Model: \_\_\_\_\_

Lamps/  
Fixture

Ballast/  
Fixture

No.  
Fixture

FC

FC

FC

2

1

1

20

\_\_\_\_\_

\_\_\_\_\_

# LIGHTING SURVEY DATA SHEET

BLDG. # 63110

ROOM # \_\_\_\_\_

Area Description: STORAGE B

Area Dimensions: 7 ft X 12 ft.

Fixture Grid: \_\_\_\_\_ ft X \_\_\_\_\_ ft. (center-to-center)

Fixture Type: 4' SURFACE MOUNT WRAP AROUND

Switching - Type: WALL No. 1

Accessibility to User: OK

Hours of Operation: \_\_\_\_\_

Lamp Model: \_\_\_\_\_ Ballast Model: \_\_\_\_\_

Lamps/ Fixture	Ballast/ Fixture	No. Fixture	FC	FC	FC
<u>2</u>	<u>1</u>	<u>2</u>	<u>48</u>	_____	_____

## LIGHTING SURVEY DATA SHEET

BLDG. # 63110

ROOM # \_\_\_\_\_

Area Description: OFFICE

Area Dimensions: 8 ft X 12 ft.

Fixture Grid: \_\_\_\_\_ ft X \_\_\_\_\_ ft. (center-to-center)

Fixture Type: RECESSED ACRYLIC 2x4

Switching - Type: WALL No. 1

Accessibility to User: OK

Hours of Operation: \_\_\_\_\_

Lamp Model: \_\_\_\_\_ Ballast Model: \_\_\_\_\_

Lamps/ Fixture	Ballast/ Fixture	No. Fixture	FC	FC	FC
<u>4</u>	<u>2</u>	<u>2</u>	<u>89</u>	_____	_____

# LIGHTING SURVEY ECO CHECK-LIST

BLDG # 63120

ROOM/AREA ENTIRE BUILDING

## A. Reduce/enhance lighting

1. Remove unneeded lamps or fixtures ☐
2. Reduce indoor lighting where illumination exceeds AEI recommended levels ☐
3. Increase daylighting ☐
4. Lower light fixtures ☐
5. Improve reflection and dispersion with light-colored ceiling and walls ☐

## B. Improve lighting controls

1. Install occupancy controls to control lighting ☐
2. Install photocells to lighting near windows ☐
3. Install additional switches to control lighting arrangements ☐
4. Use time-clocks to shut off exterior building lights ☐

## C. Improve lighting efficiency

1. Replace incandescent lamps in kitchen, hallway, and bathroom fixtures with compact fluorescent lamps ☐
2. Replace incandescent lamps in exit sign fixtures with LED fixtures ☐
3. Replace incandescent lamps in exit signs with compact fluorescent lamps ☐
4. Replace standard fluorescent lamps with energy-conserving lamps ☒
5. Replace standard fluorescent ballasts with electronic ballasts ☒
6. Replace existing fluorescent fixtures with new fixtures having efficient reflectors, electronic ballasts, and energy-conserving lamps ☒
7. Use more efficient lighting sources, i.e., upgrade from incandescent to fluorescent, from fluorescent to HID, from mercury vapor to high-pressure sodium, etc. ☐

# LIGHTING SURVEY DATA SHEET

BLDG. # 63120

ROOM # \_\_\_\_\_

Area Description: LOADING AREA #1

Area Dimensions: 61 ft X \_\_\_\_\_ ft.

Fixture Grid: \_\_\_\_\_ ft X \_\_\_\_\_ ft. (center-to-center)

Fixture Type: MERCURY VAPOR

Switching - Type: WALL No. \_\_\_\_\_

Accessibility to User: OK

Hours of Operation: \_\_\_\_\_

Lamp Model: 175 W Ballast Model: \_\_\_\_\_

Lamps/ Fixture	Ballast/ Fixture	No. Fixture	FC	FC	FC
<u>1</u>	<u>X</u>	<u>26</u>	<u>8</u>	<u>10</u>	<u>   </u>

MERCURY VAPORS THROUGHOUT BUILDING ARE 175 W  
14' HIGH

# LIGHTING SURVEY DATA SHEET

BLDG. # 63120

ROOM # \_\_\_\_\_

Area Description: REST ROOM #1

Area Dimensions: 8 ft X 10 ft. 81

Fixture Grid: \_\_\_\_\_ ft X \_\_\_\_\_ ft. (center-to-center)

Fixture Type: 4' SURFACE MOUNT WRAP AROUND

Switching - Type: WALL No. 1

Accessibility to User: OK

Hours of Operation: \_\_\_\_\_

Lamp Model: \_\_\_\_\_ Ballast Model: \_\_\_\_\_

Lamps/ Fixture	Ballast/ Fixture	No. Fixture	FC	FC	FC
<u>2</u>	<u>1</u>	<u>1</u>	<u>30</u>	<u>   </u>	<u>   </u>

# LIGHTING SURVEY DATA SHEET

BLDG. # 63120

ROOM # \_\_\_\_\_

Area Description: REST ROOM #2 / CHANGE AREA

Area Dimensions: 18 ft X 17 ft.

Fixture Grid: \_\_\_\_\_ ft X \_\_\_\_\_ ft. (center-to-center)

Fixture Type: 4' WRAP AROUND SURF. MOUNT

Switching - Type: WALL No. 1

Accessibility to User: OK

Hours of Operation: \_\_\_\_\_

Lamp Model: \_\_\_\_\_

Ballast Model: \_\_\_\_\_

Lamps/ Fixture	Ballast/ Fixture	No. Fixture	FC	FC	FC
<u>4</u>	<u>2</u>	<u>2</u>	<u>27</u>	<u>80</u>	<u>29</u>
<u>2</u>	<u>1</u>	<u>2</u>			

2 INCANDESCENT IN SHOWER

# LIGHTING SURVEY DATA SHEET

BLDG. # 63120

ROOM # \_\_\_\_\_

Area Description: MACHINE SHOP (W/ LAYOUT 1 CALC.)

Area Dimensions: 64 ft X 42 ft.

Fixture Grid: \_\_\_\_\_ ft X \_\_\_\_\_ ft. (center-to-center)

Fixture Type: MERCURY VAPOR / INDUS. SUSP. 8'

Switching - Type: WALL No. \_\_\_\_\_

Accessibility to User: OK

Hours of Operation: \_\_\_\_\_

Lamp Model: F96 TW-60W

Ballast Model: \_\_\_\_\_

Lamps/ Fixture	Ballast/ Fixture	No. Fixture	FC	FC	FC
<u>1</u>	<u>X</u>	<u>8</u>	<u>30</u>		
<u>2</u>	<u>1</u>	<u>10</u>			

FLUORESCENTS - 10' HIGH  
MERCURY VAPOR - 14'

# LIGHTING SURVEY DATA SHEET

BLDG. # 63120

ROOM # \_\_\_\_\_

Area Description: RADIOACTIVE MATERIAL STORAGE

Area Dimensions: 10 ft X 10 ft.

Fixture Grid: \_\_\_\_\_ ft X \_\_\_\_\_ ft. (center-to-center)

Fixture Type: RECESSED ACRYLIC 2'x4'

Switching - Type: WALL No. 1

Accessibility to User: OK

Hours of Operation: \_\_\_\_\_

Lamp Model: \_\_\_\_\_

Ballast Model: \_\_\_\_\_

Lamps/ Fixture	Ballast/ Fixture	No. Fixture	FC	FC	FC
<u>4</u>	<u>2</u>	<u>2</u>	<u>45</u>	<u>56</u>	_____

## LIGHTING SURVEY DATA SHEET

BLDG. # 63120

ROOM # \_\_\_\_\_

Area Description: OFFICE

Area Dimensions: 10 ft X 14 ft.

Fixture Grid: \_\_\_\_\_ ft X \_\_\_\_\_ ft. (center-to-center)

Fixture Type: RECESSED ACRYLIC

Switching - Type: WALL No. 1

Accessibility to User: OK

Hours of Operation: \_\_\_\_\_

Lamp Model: \_\_\_\_\_

Ballast Model: \_\_\_\_\_

Lamps/ Fixture	Ballast/ Fixture	No. Fixture	FC	FC	FC
<u>4</u>	<u>2</u>	<u>2</u>	<u>30</u>	_____	_____



# LIGHTING SURVEY DATA SHEET

BLDG. # 63120

ROOM # \_\_\_\_\_

Area Description: TOOL ROOM OFFICE

Area Dimensions: \_\_\_\_\_ ft X \_\_\_\_\_ ft.

Fixture Grid: \_\_\_\_\_ ft X \_\_\_\_\_ ft. (center-to-center)

Fixture Type: 4' INDUSTRIAL SURF. MOUNT

Switching - Type: WALL No. 1

Accessibility to User: OK

Hours of Operation: \_\_\_\_\_

Lamp Model: F40-CW

Ballast Model: STD

Lamps/ Fixture	Ballast/ Fixture	No. Fixture	FC	FC	FC
<u>2</u>	<u>1</u>	<u>1</u>	_____	_____	_____

## LIGHTING SURVEY DATA SHEET

BLDG. # 63120

ROOM # \_\_\_\_\_

Area Description: BREAK ROOM

Area Dimensions: 14 ft X 16 ft.

Fixture Grid: \_\_\_\_\_ ft X \_\_\_\_\_ ft. (center-to-center)

Fixture Type: RECESSED ACRYLIC

Switching - Type: WALL No. 1

Accessibility to User: OK

Hours of Operation: \_\_\_\_\_

Lamp Model: \_\_\_\_\_

Ballast Model: \_\_\_\_\_

Lamps/ Fixture	Ballast/ Fixture	No. Fixture	FC	FC	FC
<u>4</u>	<u>2</u>	<u>2</u>	<u>42</u>	_____	_____

# LIGHTING SURVEY ECO CHECK-LIST

BLDG # 63200

ROOM/AREA ENTIRE BUILDING

## A. Reduce/enhance lighting

1. Remove unneeded lamps or fixtures \_\_\_\_\_
2. Reduce indoor lighting where illumination exceeds AEI recommended levels \_\_\_\_\_
3. Increase daylighting \_\_\_\_\_
4. Lower light fixtures \_\_\_\_\_
5. Improve reflection and dispersion with light-colored ceiling and walls \_\_\_\_\_

## B. Improve lighting controls

1. Install occupancy controls to control lighting \_\_\_\_\_
2. Install photocells to lighting near windows \_\_\_\_\_
3. Install additional switches to control lighting arrangements \_\_\_\_\_
4. Use time-clocks to shut off exterior building lights \_\_\_\_\_

## C. Improve lighting efficiency

1. Replace incandescent lamps in kitchen, hallway, and bathroom fixtures with compact fluorescent lamps \_\_\_\_\_
2. Replace incandescent lamps in exit sign fixtures with LED fixtures \_\_\_\_\_
3. Replace incandescent lamps in exit signs with compact fluorescent lamps \_\_\_\_\_
4. Replace standard fluorescent lamps with energy-conserving lamps \_\_\_\_\_✓
5. Replace standard fluorescent ballasts with electronic ballasts \_\_\_\_\_✓
6. Replace existing fluorescent fixtures with new fixtures having efficient reflectors, electronic ballasts, and energy-conserving lamps \_\_\_\_\_✓
7. Use more efficient lighting sources, i.e., upgrade from incandescent to fluorescent, from fluorescent to HID, from mercury vapor to high-pressure sodium, etc. \_\_\_\_\_

# LIGHTING SURVEY DATA SHEET

BLDG. # 63200

ROOM # \_\_\_\_\_

Area Description: MAIN AREA

Area Dimensions: 154 ft X 68 ft. 10'

Fixture Grid: \_\_\_\_\_ ft X \_\_\_\_\_ ft. (center-to-center)

Fixture Type: RECESSED ACRYLIC

Switching - Type: WALL No. \_\_\_\_\_

Accessibility to User: OK

Hours of Operation: \_\_\_\_\_

Lamp Model: F40 CW

Ballast Model: STD

Lamps/ Fixture	Ballast/ Fixture	No. Fixture	FC	FC	FC
<u>4</u>	<u>2</u>	<u>68</u>	<u>71</u>	<u>112</u>	<u>      </u>

3 EXIT SIGNS

# LIGHTING SURVEY DATA SHEET

BLDG. # 63200

ROOM # \_\_\_\_\_

Area Description: BREAK ROOM

Area Dimensions: 20 ft X 28 ft. 8'

Fixture Grid: \_\_\_\_\_ ft X \_\_\_\_\_ ft. (center-to-center)

Fixture Type: RECESSED 2'x4'

Switching - Type: WALL No. 1

Accessibility to User: OK

Hours of Operation: \_\_\_\_\_

Lamp Model: F40 CW

Ballast Model: STD

Lamps/ Fixture	Ballast/ Fixture	No. Fixture	FC	FC	FC
<u>2</u>	<u>1</u>	<u>9</u>	<u>34</u>	<u>      </u>	<u>      </u>

# LIGHTING SURVEY DATA SHEET

BLDG. # 63200

ROOM # \_\_\_\_\_

Area Description: MENS RM

Area Dimensions: 11.5 ft X 19 ft.

Fixture Grid: \_\_\_\_\_ ft X \_\_\_\_\_ ft. (center-to-center)

Fixture Type: RECESSED 2x4 ACRYLIC

Switching - Type: WALL No. 1 → NEED O.S.

Accessibility to User: OK

Hours of Operation: \_\_\_\_\_

Lamp Model: \_\_\_\_\_

Ballast Model: \_\_\_\_\_

Lamps/  
Fixture

Ballast/  
Fixture

No.  
Fixture

FC

FC

FC

4

2

2

44

\_\_\_\_\_

\_\_\_\_\_

## LIGHTING SURVEY DATA SHEET

BLDG. # 63200

ROOM # \_\_\_\_\_

Area Description: WOMENS RM

Area Dimensions: \_\_\_\_\_ ft X \_\_\_\_\_ ft.

Fixture Grid: \_\_\_\_\_ ft X \_\_\_\_\_ ft. (center-to-center)

Fixture Type: \_\_\_\_\_

Switching - Type: \_\_\_\_\_ No. \_\_\_\_\_

Accessibility to User: \_\_\_\_\_

Hours of Operation: \_\_\_\_\_

Lamp Model: \_\_\_\_\_

Ballast Model: \_\_\_\_\_

Lamps/  
Fixture

Ballast/  
Fixture

No.  
Fixture

FC

FC

FC

\_\_\_\_\_

\_\_\_\_\_

\_\_\_\_\_

\_\_\_\_\_

\_\_\_\_\_

\_\_\_\_\_

SAME AS MENS

# LIGHTING SURVEY DATA SHEET

BLDG. # 63200

ROOM # \_\_\_\_\_

Area Description: MAST INSPECTION

Area Dimensions: 28 ft X 32 ft. 10'

Fixture Grid: \_\_\_\_\_ ft X \_\_\_\_\_ ft. (center-to-center)

Fixture Type: RECESSED ACQUIC 2x4

Switching - Type: WALL No. 1

Accessibility to User: OK

Hours of Operation: \_\_\_\_\_

Lamp Model: F40 CW

Ballast Model: STD

Lamps/ Fixture	Ballast/ Fixture	No. Fixture	FC	FC	FC
<u>4</u>	<u>2</u>	<u>14</u>	<u>48</u>	_____	_____

## LIGHTING SURVEY DATA SHEET

BLDG. # 63200

ROOM # \_\_\_\_\_

Area Description: STORAGE RM

Area Dimensions: 6 ft X 28 ft. 8'

Fixture Grid: \_\_\_\_\_ ft X \_\_\_\_\_ ft. (center-to-center)

Fixture Type: SAME

Switching - Type: WALL No. 1

Accessibility to User: OK

Hours of Operation: \_\_\_\_\_

Lamp Model: F40 CW

Ballast Model: STD

Lamps/ Fixture	Ballast/ Fixture	No. Fixture	FC	FC	FC
<u>2</u>	<u>1</u>	<u>3</u>	<u>20</u>	_____	_____

# LIGHTING SURVEY DATA SHEET

BLDG. # 63200

ROOM # \_\_\_\_\_

Area Description: OFFICE #1

Area Dimensions: 11 ft X 14 ft.

Fixture Grid: \_\_\_\_\_ ft X \_\_\_\_\_ ft. (center-to-center)

Fixture Type: RECESSED ACR

Switching - Type: WALL No. 1

Accessibility to User: OK

Hours of Operation: \_\_\_\_\_

Lamp Model: \_\_\_\_\_

Ballast Model: \_\_\_\_\_

Lamps/  
Fixture

Ballast/  
Fixture

No.  
Fixture

FC

FC

FC

2

1

2

35

\_\_\_\_\_

\_\_\_\_\_

-----  
LIGHTING SURVEY DATA SHEET

BLDG. # 63200

ROOM # \_\_\_\_\_

Area Description: OFFICE #2

Area Dimensions: 20 ft X 16 ft.

Fixture Grid: \_\_\_\_\_ ft X \_\_\_\_\_ ft. (center-to-center)

Fixture Type: SAME

Switching - Type: WALL No. 1

Accessibility to User: OK

Hours of Operation: \_\_\_\_\_

Lamp Model: \_\_\_\_\_

Ballast Model: \_\_\_\_\_

Lamps/  
Fixture

Ballast/  
Fixture

No.  
Fixture

FC

FC

FC

2

1

24

49

\_\_\_\_\_

\_\_\_\_\_

**RS&H**

SUBJECT \_\_\_\_\_  
DESIGNER \_\_\_\_\_  
CHECKER \_\_\_\_\_

AEP NO \_\_\_\_\_  
SHEET \_\_\_\_\_ OF \_\_\_\_\_  
DATE \_\_\_\_\_  
DATE \_\_\_\_\_

63-200

88'

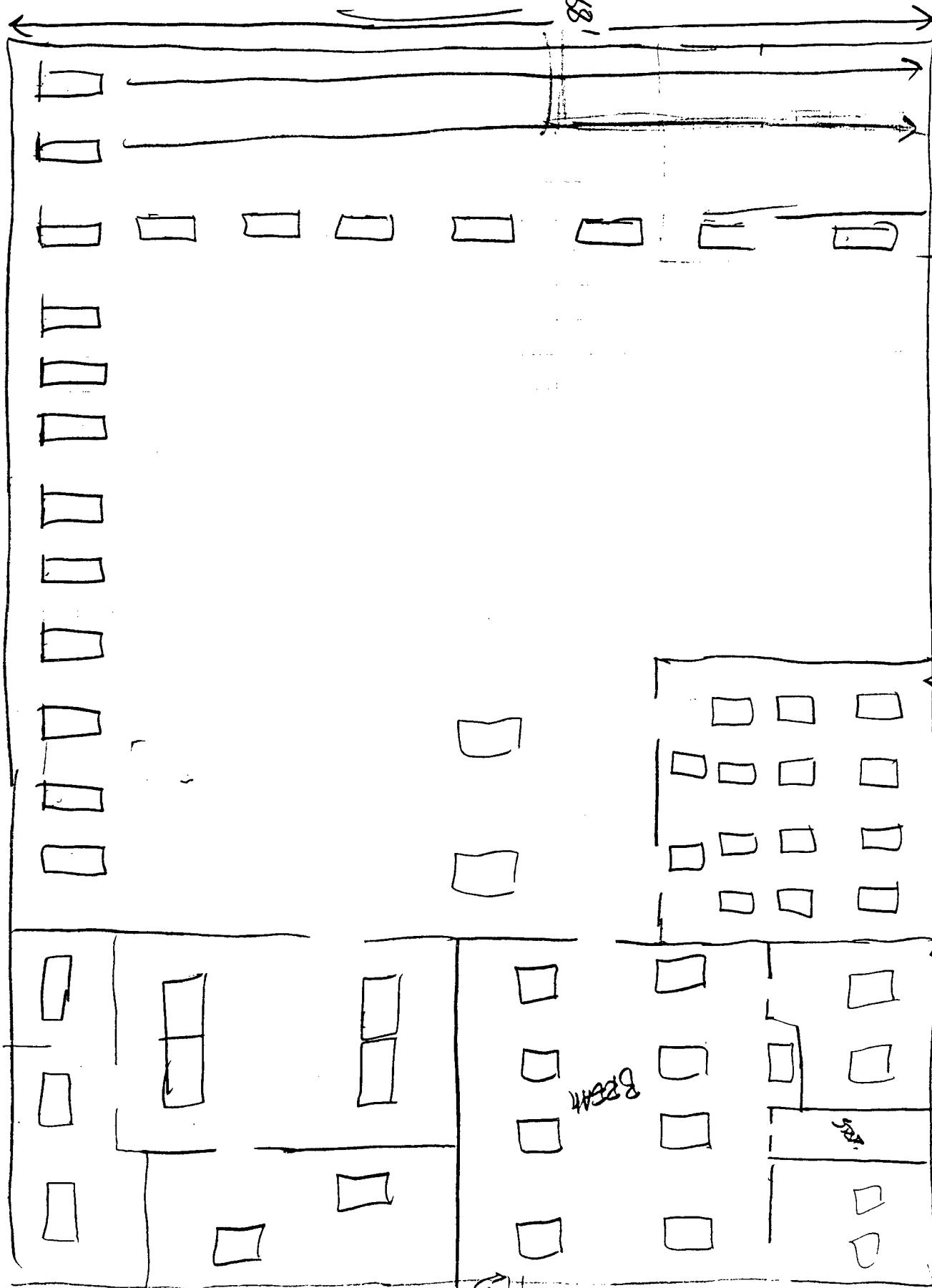

MAST  
INSPECTION

MEN'S  
RM

WOMEN'S  
RM

82544

# LIGHTING SURVEY ECO CHECK-LIST

BLDG # G3210

ROOM/AREA ENTIRE BUILDING

## A. Reduce/enhance lighting

1. Remove unneeded lamps or fixtures \_\_\_\_\_
2. Reduce indoor lighting where illumination exceeds AEI recommended levels \_\_\_\_\_
3. Increase daylighting \_\_\_\_\_
4. Lower light fixtures \_\_\_\_\_
5. Improve reflection and dispersion with light-colored ceiling and walls \_\_\_\_\_

## B. Improve lighting controls

1. Install occupancy controls to control lighting \_\_\_\_\_
2. Install photocells to lighting near windows \_\_\_\_\_
3. Install additional switches to control lighting arrangements \_\_\_\_\_
4. Use time-clocks to shut off exterior building lights \_\_\_\_\_

## C. Improve lighting efficiency

1. Replace incandescent lamps in kitchen, hallway, and bathroom fixtures with compact fluorescent lamps \_\_\_\_\_
2. Replace incandescent lamps in exit sign fixtures with LED fixtures \_\_\_\_\_
3. Replace incandescent lamps in exit signs with compact fluorescent lamps \_\_\_\_\_
4. Replace standard fluorescent lamps with energy-conserving lamps \_\_\_\_\_✓
5. Replace standard fluorescent ballasts with electronic ballasts \_\_\_\_\_✓
6. Replace existing fluorescent fixtures with new fixtures having efficient reflectors, electronic ballasts, and energy-conserving lamps \_\_\_\_\_✓
7. Use more efficient lighting sources, i.e., upgrade from incandescent to fluorescent, from fluorescent to HID, from mercury vapor to high-pressure sodium, etc. \_\_\_\_\_



# LIGHTING SURVEY DATA SHEET

BLDG. # 63210

ROOM # \_\_\_\_\_

Area Description: MAIN AREA

Area Dimensions: \_\_\_\_\_ ft X \_\_\_\_\_ ft.

Fixture Grid: \_\_\_\_\_ ft X \_\_\_\_\_ ft. (center-to-center)

Fixture Type: 8' INDUS. SUSPENDED OPEN PENDULUM + OTHERS

Switching - Type: WALL No. \_\_\_\_\_

SEE DRAWING

Accessibility to User: OK

Hours of Operation: \_\_\_\_\_

Lamp Model: F60-CW

Ballast Model: \_\_\_\_\_

Lamps/  
Fixture

Ballast/  
Fixture

No.  
Fixture

FC

FC

FC

SEE

DRAWING

122

35

↑  
PACKAGING

AREA

FIXTURE HEIGHT - 10'

2 EXIT SIGNS

## LIGHTING SURVEY DATA SHEET

BLDG. # 63210

ROOM # \_\_\_\_\_

Area Description: M43 TEST REP

Area Dimensions: 30 ft X 30 ft. 8'

Fixture Grid: \_\_\_\_\_ ft X \_\_\_\_\_ ft. (center-to-center)

Fixture Type: RECESSED ACRYLIC

Switching - Type: WALL No. 2

Accessibility to User: OK

Hours of Operation: \_\_\_\_\_

Lamp Model: \_\_\_\_\_

Ballast Model: \_\_\_\_\_

Lamps/  
Fixture

Ballast/  
Fixture

No.  
Fixture

FC

FC

FC

2

1

15

11

40

OWNER REQUEST CHANGE IN LIGHTING LAYOUT - LOW

1 EXIT SIGN

FC IN SAME  
AREAS

# LIGHTING SURVEY DATA SHEET

BLDG. # 63210

ROOM # \_\_\_\_\_

Area Description: STORAGE ROOMS

Area Dimensions: \_\_\_\_\_ ft X \_\_\_\_\_ ft.

Fixture Grid: \_\_\_\_\_ ft X \_\_\_\_\_ ft. (center-to-center)

Fixture Type: \_\_\_\_\_

Switching - Type: WALL No. 1

Accessibility to User: OK

Hours of Operation: \_\_\_\_\_

Lamp Model: \_\_\_\_\_

Ballast Model: \_\_\_\_\_

Lamps/  
Fixture

Ballast/  
Fixture

No.  
Fixture

FC

FC

FC

31

SEE DRAWINGS  
FOR OTHER DATA

## LIGHTING SURVEY DATA SHEET

BLDG. # 63210

ROOM # \_\_\_\_\_

Area Description: DRYING ROOM

Area Dimensions: \_\_\_\_\_ ft X \_\_\_\_\_ ft.

Fixture Grid: \_\_\_\_\_ ft X \_\_\_\_\_ ft. (center-to-center)

Fixture Type: INCAD.

Switching - Type: WALL No. 1

Accessibility to User: OK

Hours of Operation: \_\_\_\_\_

Lamp Model: 100 W

Ballast Model: \_\_\_\_\_

Lamps/  
Fixture

Ballast/  
Fixture

No.  
Fixture

FC

FC

FC

# LIGHTING SURVEY DATA SHEET

BLDG. # 63210

ROOM # \_\_\_\_\_

Area Description: BREAKROOM

Area Dimensions: \_\_\_\_\_ ft X \_\_\_\_\_ ft.

Fixture Grid: \_\_\_\_\_ ft X \_\_\_\_\_ ft. (center-to-center)

Fixture Type: SEE DRAW

Switching - Type: WALL No. 1

Accessibility to User: OK

Hours of Operation: \_\_\_\_\_

Lamp Model: \_\_\_\_\_ Ballast Model: \_\_\_\_\_

Lamps/ Fixture	Ballast/ Fixture	No. Fixture	FC	FC	FC
<u>SEE DRAW</u>	_____	<u>7</u>	<u>48</u>	_____	_____

1 EXIT SIGN

## LIGHTING SURVEY DATA SHEET

BLDG. # 63210

ROOM # \_\_\_\_\_

Area Description: OFFICE #1

Area Dimensions: \_\_\_\_\_ ft X \_\_\_\_\_ ft.

Fixture Grid: \_\_\_\_\_ ft X \_\_\_\_\_ ft. (center-to-center)

Fixture Type: \_\_\_\_\_

Switching - Type: \_\_\_\_\_ No. \_\_\_\_\_

Accessibility to User: \_\_\_\_\_

Hours of Operation: \_\_\_\_\_

Lamp Model: \_\_\_\_\_ Ballast Model: \_\_\_\_\_

Lamps/ Fixture	Ballast/ Fixture	No. Fixture	FC	FC	FC
_____	_____	<u>2</u>	<u>45</u>	_____	_____

SEE DRAWING  
FOR DATA

# LIGHTING SURVEY DATA SHEET

BLDG. # 63200

ROOM # \_\_\_\_\_

Area Description: Tool Rm

Area Dimensions: \_\_\_\_\_ ft X \_\_\_\_\_ ft.

Fixture Grid: \_\_\_\_\_ ft X \_\_\_\_\_ ft. (center-to-center)

Fixture Type: \_\_\_\_\_

Switching - Type: WALL No. 1

Accessibility to User: OK

Hours of Operation: \_\_\_\_\_

Lamp Model: \_\_\_\_\_

Ballast Model: \_\_\_\_\_

Lamps/  
Fixture

Ballast/  
Fixture

No.  
Fixture

FC

FC

FC

5

43

SEE DRAWING FOR DATA

## LIGHTING SURVEY DATA SHEET

BLDG. # 60070

ROOM # \_\_\_\_\_

Area Description: COTTON STORAGE

Area Dimensions: 19 ft X 15 ft. 12' 8"

Fixture Grid: \_\_\_\_\_ ft X \_\_\_\_\_ ft. (center-to-center)

Fixture Type: 8' INDUS. SUSPENDED CLOSED APERTURE / GASKET SURFACE MOUNT

Switching - Type: WALL No. 1

40W

Accessibility to User: OK

Hours of Operation: \_\_\_\_\_

Lamp Model: 75W-F96 T-12 CW

Ballast Model: STD

Lamps/  
Fixture

Ballast/  
Fixture

No.  
Fixture

FC

FC

FC

4

2

2

102

16

2

1

14

UNDER 8' FIXTURE

1-EXIT SIGN

# LIGHTING SURVEY DATA SHEET

BALLAST TYPE  
SEE LDCER PN 12

BLDG. # 63-410

ROOM #       

Area Description: ENTRANCE  
 Area Dimensions: 12' 5" ft X 11' 5" ft.  
 Fixture Grid:        ft X        ft. (center-to-center)  
 Fixture Type: 4' S.M.W.A.  
 Switching - Type: WALL No. 3  
 Accessibility to User: OK  
 Hours of Operation: 0630 - 1700 (5 DAYS)  
 Lamp Model: 34W Ballast Model:       

Lamps/ Fixture	Ballast/ Fixture	No. Fixture	FC	FC	FC
<u>1</u>	<u>1</u>	<u>2</u>	<u>      </u>	<u>      </u>	<u>      </u>

1 EXIT SIGN  
9' CEILING  
- THROUGHOUT BUILDING - SEVERAL LIGHT FIXTURES  
HAVE LENS COVERS REMOVED

## LIGHTING SURVEY DATA SHEET

BLDG. # 63-410

ROOM # 1

Area Description: ALLDVE  
 Area Dimensions: 3' 8" ft X 6' 0" ft.  
 Fixture Grid:        ft X        ft. (center-to-center)  
 Fixture Type: 4' S.M.W.A.  
 Switching - Type: WALL No. 2  
 Accessibility to User: OK  
 Hours of Operation:         
 Lamp Model: 34W Ballast Model:       

Lamps/ Fixture	Ballast/ Fixture	No. Fixture	FC	FC	FC
<u>1</u>	<u>1</u>	<u>1</u>	<u>13</u>	<u>      </u>	<u>      </u>

# LIGHTING SURVEY DATA SHEET

BLDG. # 63-410

ROOM # \_\_\_\_\_

Area Description: LOITER ROOM #1

Area Dimensions: 27 ft X 19 ft.

Fixture Grid: \_\_\_\_\_ ft X \_\_\_\_\_ ft. (center-to-center)

Fixture Type: 4' S.M.W.A. (10) 4' WALL MOUNT (3)

Switching - Type: WALL No. \_\_\_\_\_

Accessibility to User: OK

Hours of Operation: \_\_\_\_\_

Lamp Model: F40CW

Ballast Model: \_\_\_\_\_

Lamps/ Fixture	Ballast/ Fixture	No. Fixture	FC	FC	FC
<u>1</u>	<u>1</u>	<u>13</u>	<u>21</u>	<u>40</u>	<u>      </u>

UNDER  
WALL LIGHTS

1 EXIT SIGN - NOT ON

## LIGHTING SURVEY DATA SHEET

BLDG. # 63-410

ROOM # \_\_\_\_\_

Area Description: SHOWERS #1

Area Dimensions: 27 ft X 18' 8" ft.

Fixture Grid: \_\_\_\_\_ ft X \_\_\_\_\_ ft. (center-to-center)

Fixture Type: 4' S.M. WET LOCATION

Switching - Type: WALL No. \_\_\_\_\_

Accessibility to User: OK

Hours of Operation: \_\_\_\_\_

Lamp Model: F40CW

Ballast Model: \_\_\_\_\_

Lamps/ Fixture	Ballast/ Fixture	No. Fixture	FC	FC	FC
<u>1</u>	<u>1</u>	<u>10</u>	<u>14</u>	<u>      </u>	<u>      </u>

2 EXIT SIGNS

7' 4"  
4' 2"  
6' 9"  
5'  
17'  
18' 2"

# LIGHTING SURVEY DATA SHEET

BLDG. # 63-410

ROOM # \_\_\_\_\_

Area Description: LOCKER RM #2

Area Dimensions: 20 ft X 15.5 ft.

Fixture Grid: \_\_\_\_\_ ft X \_\_\_\_\_ ft. (center-to-center)

Fixture Type: 4' S.M.W.A (6) 4' WALL MOUNT

Switching - Type: WALL No. 2

Accessibility to User: OK

Hours of Operation: \_\_\_\_\_

Lamp Model: F40CW

Ballast Model: Universal 412-L-SLH-LD-TC-P

Lamps/ Fixture	Ballast/ Fixture	No. Fixture	FC	FC	FC
<u>1</u>	<u>1</u>	<u>7</u>	<u>26</u>	_____	_____

1 EXIT SIGN

4' LBL

# LIGHTING SURVEY DATA SHEET

BLDG. # 63-410

ROOM # \_\_\_\_\_

Area Description: ALLUVE #2

Area Dimensions: 6 ft X 4 ft.

Fixture Grid: \_\_\_\_\_ ft X \_\_\_\_\_ ft. (center-to-center)

Fixture Type: 4' S.M.W.A

Switching - Type: WALL No. 1

Accessibility to User: OK

Hours of Operation: \_\_\_\_\_

Lamp Model: F40CW

Ballast Model: \_\_\_\_\_

Lamps/ Fixture	Ballast/ Fixture	No. Fixture	FC	FC	FC
<u>1</u>	<u>1</u>	<u>1</u>	<u>20</u>	_____	_____

8' LBL

# LIGHTING SURVEY DATA SHEET

BLDG. # 63-410

ROOM # \_\_\_\_\_

Area Description: Rest Room #1  
 Area Dimensions: 5 ft X 16 ft.  
 Fixture Grid: \_\_\_\_\_ ft X \_\_\_\_\_ ft. (center-to-center)  
 Fixture Type: 4' S.M.W.A. (2) 4' W.M. - (1) 7' HIGH  
 Switching - Type: WALL No. 1  
 Accessibility to User: OK  
 Hours of Operation: \_\_\_\_\_  
 Lamp Model: F40CW Ballast Model: \_\_\_\_\_

Lamps/ Fixture	Ballast/ Fixture	No. Fixture	FC	FC	FC
<u>1</u>	<u>1</u>	<u>3</u>	<u>30</u>	_____	_____

8' CEIL.

# LIGHTING SURVEY DATA SHEET

BLDG. # 63-410

ROOM # \_\_\_\_\_

Area Description: Locker Rm #2  
 Area Dimensions: 6' 9" ft X 18' 4" ft.  
 Fixture Grid: \_\_\_\_\_ ft X \_\_\_\_\_ ft. (center-to-center)  
 Fixture Type: 4' S.M.W.A.  
 Switching - Type: WALL No. 1  
 Accessibility to User: OK  
 Hours of Operation: \_\_\_\_\_  
 Lamp Model: F40CW Ballast Model: \_\_\_\_\_

Lamps/ Fixture	Ballast/ Fixture	No. Fixture	FC	FC	FC
<u>1</u>	<u>1</u>	<u>3</u>	<u>33</u>	_____	_____

1 EXIT SIGN

6' CEIL.



# LIGHTING SURVEY DATA SHEET

BLDG. # 63-410

ROOM # \_\_\_\_\_

Area Description: SHOWERS #2

Area Dimensions: 20 ft X 16 ft.

Fixture Grid: \_\_\_\_\_ ft X \_\_\_\_\_ ft. (center-to-center)

Fixture Type: S.M.W.L.

Switching - Type: WALL No. 1

Accessibility to User: OK

Hours of Operation: \_\_\_\_\_

Lamp Model: F40 CW

Ballast Model: \_\_\_\_\_

Lamps/ Fixture	Ballast/ Fixture	No. Fixture	FC	FC	FC
<u>1</u>	<u>1</u>	<u>6</u>	<u>14</u>	_____	_____

1 EXIT SIGN

# LIGHTING SURVEY DATA SHEET

BLDG. # 63-410

ROOM # \_\_\_\_\_

Area Description: ALLIANCE #3

Area Dimensions: 4' 10" ft X 7 ft.

Fixture Grid: \_\_\_\_\_ ft X \_\_\_\_\_ ft. (center-to-center)

Fixture Type: COMPACT FLUORESCENT - BIAK

Switching - Type: WALL No. 1

Accessibility to User: OK

Hours of Operation: \_\_\_\_\_

Lamp Model: \_\_\_\_\_

Ballast Model: \_\_\_\_\_

Lamps/ Fixture	Ballast/ Fixture	No. Fixture	FC	FC	FC
<u>1</u>	<u>1</u>	<u>1</u>	<u>6</u>	_____	_____

LEIL - 8'

# LIGHTING SURVEY DATA SHEET

BLDG. # B3-410

ROOM # \_\_\_\_\_

Area Description: ALLIANCE #4

Area Dimensions: 3' 8" ft X 5' 3" ft.

Fixture Grid: \_\_\_\_\_ ft X \_\_\_\_\_ ft. (center-to-center)

Fixture Type: COMPACT FLUORESCENT BLANK

Switching - Type: WALL No. 1

Accessibility to User: OK

Hours of Operation: \_\_\_\_\_

Lamp Model: \_\_\_\_\_ Ballast Model: \_\_\_\_\_

Lamps/ Fixture	Ballast/ Fixture	No. Fixture	FC	FC	FC
<u>1</u>	<u>1</u>	<u>1</u>	<u>6</u>	<u>  </u>	<u>  </u>

## LIGHTING SURVEY DATA SHEET

BLDG. # B3-410

ROOM # \_\_\_\_\_

Area Description: ALLIANCE #5

Area Dimensions: 5' 7" ft X 3' 8" ft.

Fixture Grid: \_\_\_\_\_ ft X \_\_\_\_\_ ft. (center-to-center)

Fixture Type: COMPACT FLUORESCENT BLANK

Switching - Type: WALL No. 1

Accessibility to User: OK

Hours of Operation: \_\_\_\_\_

Lamp Model: \_\_\_\_\_ Ballast Model: \_\_\_\_\_

Lamps/ Fixture	Ballast/ Fixture	No. Fixture	FC	FC	FC
<u>1</u>	<u>1</u>	<u>1</u>	<u>5</u>	<u>  </u>	<u>  </u>

# LIGHTING SURVEY DATA SHEET

BLDG. # 63-410

ROOM # \_\_\_\_\_

Area Description: ALCOVE #6

Area Dimensions: 3' 8" ft X 6 ft.

Fixture Grid: \_\_\_\_\_ ft X \_\_\_\_\_ ft. (center-to-center)

Fixture Type: COMPACT FLUORESCENT BLAX

Switching - Type: WALL No. 1

Accessibility to User: \_\_\_\_\_

Hours of Operation: \_\_\_\_\_

Lamp Model: \_\_\_\_\_

Ballast Model: \_\_\_\_\_

Lamps/  
Fixture

Ballast/  
Fixture

No.  
Fixture

FC

FC

FC

1

1

1

9

\_\_\_\_\_

\_\_\_\_\_

1 EXIT SIGN

## LIGHTING SURVEY DATA SHEET

BLDG. # 63-410

ROOM # \_\_\_\_\_

Area Description: OPEN AREA (R.D. #2)

Area Dimensions: 10' 4" ft X 9' 11" ft.

Fixture Grid: \_\_\_\_\_ ft X \_\_\_\_\_ ft. (center-to-center)

Fixture Type: 4' S.M.W.A

Switching - Type: WALL No. 1

Accessibility to User: \_\_\_\_\_

Hours of Operation: \_\_\_\_\_

Lamp Model: 34W

Ballast Model: \_\_\_\_\_

Lamps/  
Fixture

Ballast/  
Fixture

No.  
Fixture

FC

FC

FC

1

1

2

28

\_\_\_\_\_

\_\_\_\_\_

SWITCH CONTROLS OPEN AREA ALCOVE #6 & BATHROOM

# LIGHTING SURVEY DATA SHEET

BLDG. # 63-410

ROOM # \_\_\_\_\_

Area Description: REST Room #2

Area Dimensions: 15'10" ft X 4' 11" ft.

Fixture Grid: \_\_\_\_\_ ft X \_\_\_\_\_ ft. (center-to-center)

Fixture Type: 4' S.M.W.A (2) 4' W.M. (1)

Switching - Type: WALL No. 1

Accessibility to User: OK

Hours of Operation: \_\_\_\_\_

Lamp Model: F40CW Ballast Model: \_\_\_\_\_

Lamps/ Fixture	Ballast/ Fixture	No. Fixture	FC	FC	FC
<u>1</u>	<u>1</u>	<u>3</u>	<u>26</u>	_____	_____

8' CELL

# LIGHTING SURVEY DATA SHEET

BLDG. # 63-410

ROOM # \_\_\_\_\_

Area Description: ALLGIVE #7

Area Dimensions: 4'3" ft X 7'2" ft.

Fixture Grid: \_\_\_\_\_ ft X \_\_\_\_\_ ft. (center-to-center)

Fixture Type: 4' S.M.W.A

Switching - Type: WALL No. 1

Accessibility to User: OK

Hours of Operation: \_\_\_\_\_

Lamp Model: F40CW Ballast Model: \_\_\_\_\_

Lamps/ Fixture	Ballast/ Fixture	No. Fixture	FC	FC	FC
<u>1</u>	<u>1</u>	<u>1</u>	<u>26</u>	_____	_____

8' CELL

# LIGHTING SURVEY DATA SHEET

BLDG. # 63-410

ROOM # \_\_\_\_\_

Area Description: HALLWAY #1

Area Dimensions: 6' 2" ft X 21.5 ft.

Fixture Grid: \_\_\_\_\_ ft X \_\_\_\_\_ ft. (center-to-center)

Fixture Type: 4' S.M.W.A.

Switching - Type: WALL No. 1

Accessibility to User: OK

Hours of Operation: \_\_\_\_\_

Lamp Model: 40W Ballast Model: \_\_\_\_\_

Lamps/ Fixture	Ballast/ Fixture	No. Fixture	FC	FC	FC
<u>1</u>	<u>1</u>	<u>2</u>	<u>18</u>	<u>  </u>	<u>  </u>

4' CELL.  
2 EXIT SIGNS

# LIGHTING SURVEY DATA SHEET

BLDG. # 63-410

ROOM # \_\_\_\_\_

Area Description: OFFICE #1

Area Dimensions: 8' 11" ft X SEE DRAW ft.

Fixture Grid: \_\_\_\_\_ ft X \_\_\_\_\_ ft. (center-to-center)

Fixture Type: 4' S.M.W.A.

Switching - Type: WALL No. 1

Accessibility to User: OK

Hours of Operation: \_\_\_\_\_

Lamp Model: 40W Ballast Model: \_\_\_\_\_

Lamps/ Fixture	Ballast/ Fixture	No. Fixture	FC	FC	FC
<u>1</u>	<u>1</u>	<u>2</u>	<u>22</u>	<u>23</u>	<u>  </u>

4' CELL

# LIGHTING SURVEY DATA SHEET

BLDG. # 63-410

ROOM # \_\_\_\_\_

Area Description: KITCHEN

Area Dimensions: 8' 11" ft X SEE DRAW ft.

Fixture Grid: \_\_\_\_\_ ft X \_\_\_\_\_ ft. (center-to-center)

Fixture Type: 4' S.M.W.A. (4)

Switching - Type: WALL No. 1

Accessibility to User: OK

Hours of Operation: \_\_\_\_\_

Lamp Model: 40W F30T-12 (W.M) Ballast Model: \_\_\_\_\_

Lamps/ Fixture	Ballast/ Fixture	No. Fixture	FC	FC	FC
<u>1</u>	<u>1</u>	<u>5</u>	<u>25</u>	<u>   </u>	<u>   </u>

4' LEIL.  
STD BALLAST IN W.M. FIXT.

# LIGHTING SURVEY DATA SHEET

BLDG. # 63-410

ROOM # \_\_\_\_\_

Area Description: BREAK ROOM

Area Dimensions: 20' 9" ft X 30' 3" ft.

Fixture Grid: \_\_\_\_\_ ft X \_\_\_\_\_ ft. (center-to-center)

Fixture Type: 4' S.M.W.A

Switching - Type: WALL No. 1

Accessibility to User: OK

Hours of Operation: \_\_\_\_\_

Lamp Model: 40W Ballast Model: \_\_\_\_\_

Lamps/ Fixture	Ballast/ Fixture	No. Fixture	FC	FC	FC
<u>1</u>	<u>1</u>	<u>12</u>	<u>22</u>	<u>   </u>	<u>   </u>

4' LEIL.

# LIGHTING SURVEY DATA SHEET

BLDG. # 63-410

ROOM # \_\_\_\_\_

Area Description: OFFICE #3

Area Dimensions: 8 ft X 12 ft.

Fixture Grid: \_\_\_\_\_ ft X \_\_\_\_\_ ft. (center-to-center)

Fixture Type: 4' S.M.W.A.

Switching - Type: WALL No. 1

Accessibility to User: OK

Hours of Operation: \_\_\_\_\_

Lamp Model: 34W Ballast Model: \_\_\_\_\_

Lamps/ Fixture	Ballast/ Fixture	No. Fixture	FC	FC	FC
<u>1</u>	<u>1</u>	<u>2</u>	<u>22</u>	<u>    </u>	<u>    </u>

4' CEIL

# LIGHTING SURVEY DATA SHEET

BLDG. # 63

ROOM # \_\_\_\_\_

Area Description: OFFICE #4

Area Dimensions: 10' 10" ft X 12 ft.

Fixture Grid: \_\_\_\_\_ ft X \_\_\_\_\_ ft. (center-to-center)

Fixture Type: 4' S.M.W.A.

Switching - Type: WALL No. 1

Accessibility to User: OK

Hours of Operation: \_\_\_\_\_

Lamp Model: 34W Ballast Model: \_\_\_\_\_

Lamps/ Fixture	Ballast/ Fixture	No. Fixture	FC	FC	FC
<u>1</u>	<u>1</u>	<u>4</u>	<u>35</u>	<u>    </u>	<u>    </u>

4' CEIL

# LIGHTING SURVEY DATA SHEET

BLDG. # 63-410

ROOM # \_\_\_\_\_

Area Description: BATH ROOM #3  
 Area Dimensions: 10'4" ft X S.D. ft.  
 Fixture Grid: \_\_\_\_\_ ft X \_\_\_\_\_ ft. (center-to-center)  
 Fixture Type: 4' S.M.W.A. (2) 4' W.M. (1)  
 Switching - Type: WALL No. 1  
 Accessibility to User: OK  
 Hours of Operation: \_\_\_\_\_

Lamp Model: 40 W Ballast Model: \_\_\_\_\_

Lamps/ Fixture	Ballast/ Fixture	No. Fixture	FC	FC	FC
<u>1</u>	<u>1</u>	<u>3</u>	<u>32</u>	_____	_____

8' CEIL

# LIGHTING SURVEY DATA SHEET

BLDG. # 63-410

ROOM # \_\_\_\_\_

Area Description: ALLGVE #8  
 Area Dimensions: 4 ft X 4 ft.  
 Fixture Grid: \_\_\_\_\_ ft X \_\_\_\_\_ ft. (center-to-center)  
 Fixture Type: COMBAC FLOOR BLAX  
 Switching - Type: WALL No. 1  
 Accessibility to User: OK  
 Hours of Operation: \_\_\_\_\_

Lamp Model: \_\_\_\_\_ Ballast Model: \_\_\_\_\_

Lamps/ Fixture	Ballast/ Fixture	No. Fixture	FC	FC	FC
<u>1</u>	<u>1</u>	<u>1</u>	<u>7</u>	_____	_____

8' CEIL



# LIGHTING SURVEY DATA SHEET

BLDG. # 63-410

ROOM # \_\_\_\_\_

Area Description: HALLWAY 2  
 Area Dimensions: 6 ft X 24 ft. + 4 x 5'6"  
 Fixture Grid: \_\_\_\_\_ ft X \_\_\_\_\_ ft. (center-to-center)  
 Fixture Type: 4' S.M.W.A.  
 Switching - Type: WALL No. 1  
 Accessibility to User: OK  
 Hours of Operation: \_\_\_\_\_  
 Lamp Model: 40W (2) 34W (1) Ballast Model: \_\_\_\_\_

Lamps/ Fixture	Ballast/ Fixture	No. Fixture	FC	FC	FC
<u>1</u>	<u>1</u>	<u>3</u>	<u>23</u>	<u>20</u>	<u>  </u>

9' CEIL  
2 EXIT SIGNS

# LIGHTING SURVEY DATA SHEET

BLDG. # 63-410

ROOM # \_\_\_\_\_

Area Description: BATH ROOM #4  
 Area Dimensions: 8' 11" ft X 10' ft.  
 Fixture Grid: \_\_\_\_\_ ft X \_\_\_\_\_ ft. (center-to-center)  
 Fixture Type: 4' S.M.W.A. (2) 4' W.M. (1)  
 Switching - Type: WALL No. 1  
 Accessibility to User: OK  
 Hours of Operation: \_\_\_\_\_  
 Lamp Model: 34W Ballast Model: \_\_\_\_\_

Lamps/ Fixture	Ballast/ Fixture	No. Fixture	FC	FC	FC
<u>1</u>	<u>1</u>	<u>3</u>	<u>20</u>	<u>  </u>	<u>  </u>

9' CEIL

# LIGHTING SURVEY DATA SHEET

BLDG. # 63-A10

ROOM # \_\_\_\_\_

Area Description: ALCOVE (Wms. Rm.)

Area Dimensions: 4 ft X 4 ft.

Fixture Grid: \_\_\_\_\_ ft X \_\_\_\_\_ ft. (center-to-center)

Fixture Type: COMPACT FLUOR. BIX

Switching - Type: WALL No. 1

Accessibility to User: OK

Hours of Operation: \_\_\_\_\_

Lamp Model: \_\_\_\_\_

Ballast Model: \_\_\_\_\_

Lamps/ Fixture	Ballast/ Fixture	No. Fixture	FC	FC	FC
<u>1</u>	<u>1</u>	<u>1</u>	<u>10</u>	_____	_____

8' CEIL.

# LIGHTING SURVEY DATA SHEET

BLDG. # 63-A10

ROOM # \_\_\_\_\_

Area Description: ENTRANCE #2

Area Dimensions: 8' 9" ft X 8' 1" ft.

Fixture Grid: \_\_\_\_\_ ft X \_\_\_\_\_ ft. (center-to-center)

Fixture Type: 4' S.M. WA

Switching - Type: WALL No. 1

Accessibility to User: OK

Hours of Operation: \_\_\_\_\_

Lamp Model: 34W

Ballast Model: \_\_\_\_\_

Lamps/ Fixture	Ballast/ Fixture	No. Fixture	FC	FC	FC
<u>1</u>	<u>1</u>	<u>1</u>	<u>15</u>	_____	_____

9' CEIL

# LIGHTING SURVEY DATA SHEET

BLDG. # 63-410

ROOM # \_\_\_\_\_

Area Description: ALCOVE #9  
 Area Dimensions: 4 ft X 6 ft.  
 Fixture Grid: \_\_\_\_\_ ft X \_\_\_\_\_ ft. (center-to-center)  
 Fixture Type: COMPACT FLUORESC 3'x4'  
 Switching - Type: WALL No. 1  
 Accessibility to User: OK  
 Hours of Operation: \_\_\_\_\_  
 Lamp Model: \_\_\_\_\_ Ballast Model: \_\_\_\_\_

Lamps/ Fixture	Ballast/ Fixture	No. Fixture	FC	FC	FC
<u>1</u>	<u>1</u>	<u>1</u>	<u>    </u>	<u>    </u>	<u>    </u>

9' LED  
LIGHT BURNED OUT

## LIGHTING SURVEY DATA SHEET

BLDG. # 63-410

ROOM # \_\_\_\_\_

Area Description: LITANKE ROOM #1  
 Area Dimensions: 19.5 ft X 32 ft.  
 Fixture Grid: \_\_\_\_\_ ft X \_\_\_\_\_ ft. (center-to-center)  
 Fixture Type: 4' S.M.W.A (10) 4' W.M (3)  
 Switching - Type: WALL No. 1  
 Accessibility to User: OK  
 Hours of Operation: \_\_\_\_\_  
 Lamp Model: 34 + 40 W MIXTURE Ballast Model: \_\_\_\_\_

Lamps/ Fixture	Ballast/ Fixture	No. Fixture	FC	FC	FC
<u>1</u>	<u>1</u>	<u>13</u>	<u>35</u>	<u>20</u>	<u>    </u>

# LIGHTING SURVEY DATA SHEET

BLDG. # 63-410

ROOM # \_\_\_\_\_

Area Description: SHOWERS

Area Dimensions: 32 ft X 18' 2" ft.

Fixture Grid: \_\_\_\_\_ ft X \_\_\_\_\_ ft. (center-to-center)

Fixture Type: 4' S.M.W.L. (4) C.F. BLK

Switching - Type: WALL No. 1

Accessibility to User: \_\_\_\_\_

Hours of Operation: \_\_\_\_\_

Lamp Model: \_\_\_\_\_

Ballast Model: \_\_\_\_\_

Lamps/ Fixture	Ballast/ Fixture	No. Fixture	FC	FC	FC
<u>1</u>	<u>1</u>	<u>1</u>	<u>15</u>	_____	_____

1 EXIT SIGN

# LIGHTING SURVEY DATA SHEET

BLDG. # 63-410

ROOM # \_\_\_\_\_

Area Description: ALLOVE #10

Area Dimensions: 12 ft X 3' 8" ft.

Fixture Grid: \_\_\_\_\_ ft X \_\_\_\_\_ ft. (center-to-center)

Fixture Type: COMDAC FLOOR BLK

Switching - Type: WALL No. 1

Accessibility to User: OK

Hours of Operation: \_\_\_\_\_

Lamp Model: \_\_\_\_\_

Ballast Model: \_\_\_\_\_

Lamps/ Fixture	Ballast/ Fixture	No. Fixture	FC	FC	FC
<u>1</u>	<u>1</u>	<u>2</u>	<u>5</u>	_____	_____

2 EXIT SIGNS  
8' CEIL

# LIGHTING SURVEY DATA SHEET

BLDG. # 63-410

ROOM # \_\_\_\_\_

Area Description: OPEN AREA #2

Area Dimensions: 10'3" ft X 9'7" ft.

Fixture Grid: \_\_\_\_\_ ft X \_\_\_\_\_ ft. (center-to-center)

Fixture Type: 4' S.M.W.A

Switching - Type: WALL No. 1

Accessibility to User: OK

Hours of Operation: \_\_\_\_\_

Lamp Model: 40W Ballast Model: \_\_\_\_\_

Lamps/ Fixture	Ballast/ Fixture	No. Fixture	FC	FC	FC
<u>1</u>	<u>1</u>	<u>2</u>	<u>32</u>	<u>  </u>	<u>  </u>

8' CELL

# LIGHTING SURVEY DATA SHEET

BLDG. # 63-410

ROOM # \_\_\_\_\_

Area Description: REST ROOM #5

Area Dimensions: 4'11" ft X 16'9" ft.

Fixture Grid: \_\_\_\_\_ ft X \_\_\_\_\_ ft. (center-to-center)

Fixture Type: 4' S.M.W.A. (2) 4' W.M. (1)

Switching - Type: WALL No. 1

Accessibility to User: OK

Hours of Operation: \_\_\_\_\_

Lamp Model: 34W (1) 40W (2) Ballast Model: \_\_\_\_\_

Lamps/ Fixture	Ballast/ Fixture	No. Fixture	FC	FC	FC
<u>1</u>	<u>1</u>	<u>3</u>	<u>33</u>	<u>  </u>	<u>  </u>

# LIGHTING SURVEY DATA SHEET

BLDG. # B-AD

ROOM # \_\_\_\_\_

Area Description: Area #11 (Women's)

Area Dimensions: 4 ft X 6 ft.

Fixture Grid: \_\_\_\_\_ ft X \_\_\_\_\_ ft. (center-to-center)

Fixture Type: Compact Fluor BIA

Switching - Type: WALL No. 1

Accessibility to User: OK

Hours of Operation: \_\_\_\_\_

Lamp Model: \_\_\_\_\_ Ballast Model: \_\_\_\_\_

Lamps/ Fixture	Ballast/ Fixture	No. Fixture	FC	FC	FC
<u>1</u>	<u>1</u>	<u>1</u>	<u>7</u>	<u>   </u>	<u>   </u>

9' CEIL

# LIGHTING SURVEY DATA SHEET

BLDG. # B-AD

ROOM # \_\_\_\_\_

Area Description: Wms. Locker Rm

Area Dimensions: 19.5 ft X 20.5 ft.

Fixture Grid: \_\_\_\_\_ ft X \_\_\_\_\_ ft. (center-to-center)

Fixture Type: 4' S.M.W.A (6) 4' W.M. (1)

Switching - Type: WALL No. 1

Accessibility to User: OK

Hours of Operation: \_\_\_\_\_

Lamp Model: 40W Ballast Model: \_\_\_\_\_

Lamps/ Fixture	Ballast/ Fixture	No. Fixture	FC	FC	FC
<u>1</u>	<u>1</u>	<u>7</u>	<u>21</u>	<u>18</u>	<u>   </u>

# LIGHTING SURVEY DATA SHEET

BLDG. # 63-410

ROOM # \_\_\_\_\_

Area Description: WMS. SHOWERS

Area Dimensions: 11' 9" ft X 19.5 ft.

Fixture Grid: \_\_\_\_\_ ft X \_\_\_\_\_ ft. (center-to-center)

Fixture Type: 4' S.M.W.L.

Switching - Type: WALL No. 1

Accessibility to User: OK

Hours of Operation: \_\_\_\_\_

Lamp Model: 34W

Ballast Model: \_\_\_\_\_

Lamps/  
Fixture

Ballast/  
Fixture

No.  
Fixture

FC

FC

FC

1

1

6

13

\_\_\_\_\_

\_\_\_\_\_

8' LEIL.  
1 EXTENSION

## LIGHTING SURVEY DATA SHEET

BLDG. # 63-410

ROOM # \_\_\_\_\_

Area Description: BATH RM #6

Area Dimensions: 10' 3" ft X 16' 3" ft.

Fixture Grid: \_\_\_\_\_ ft X \_\_\_\_\_ ft. (center-to-center)

Fixture Type: 4' S.M.W.A (3) 4' W.M. (1) 7'

Switching - Type: WALL No. 1

Accessibility to User: OK

Hours of Operation: \_\_\_\_\_

Lamp Model: 40W

Ballast Model: \_\_\_\_\_

Lamps/  
Fixture

Ballast/  
Fixture

No.  
Fixture

FC

FC

FC

1

1

4

17

\_\_\_\_\_

\_\_\_\_\_

8' LEIL

# LIGHTING SURVEY DATA SHEET

BLDG. # B-410

ROOM # \_\_\_\_\_

Area Description: ALLUVE #12

Area Dimensions: SEE DRAW ft X \_\_\_\_\_ ft.

Fixture Grid: \_\_\_\_\_ ft X \_\_\_\_\_ ft. (center-to-center)

Fixture Type: \_\_\_\_\_

Switching - Type: WALL No. 1

Accessibility to User: OK

Hours of Operation: \_\_\_\_\_

Lamp Model: 40W Ballast Model: \_\_\_\_\_

<u>Lamps/ Fixture</u>	<u>Ballast/ Fixture</u>	<u>No. Fixture</u>	<u>FC</u>	<u>FC</u>	<u>FC</u>
<u>1</u>	<u>1</u>	<u>2</u>	<u>NO LIGHTS OUT</u>	<u>—</u>	<u>—</u>

1 EXIT SIGN  
6' CELL

# LIGHTING SURVEY DATA SHEET

BLDG. # B-410

ROOM # \_\_\_\_\_

Area Description: ALLUVE #13

Area Dimensions: 3'8" ft X \_\_\_\_\_ ft.

Fixture Grid: \_\_\_\_\_ ft X \_\_\_\_\_ ft. (center-to-center)

Fixture Type: COMPACT BIA-X

Switching - Type: WALL No. 1

Accessibility to User: OK

Hours of Operation: \_\_\_\_\_

Lamp Model: \_\_\_\_\_ Ballast Model: \_\_\_\_\_

<u>Lamps/ Fixture</u>	<u>Ballast/ Fixture</u>	<u>No. Fixture</u>	<u>FC</u>	<u>FC</u>	<u>FC</u>
<u>—</u>	<u>—</u>	<u>—</u>	<u>—</u>	<u>—</u>	<u>—</u>

NO LIGHTS  
2' CELL



# LIGHTING SURVEY DATA SHEET

BLDG. # B-410

ROOM # \_\_\_\_\_

Area Description: LEE MACH. RM

Area Dimensions: 10' ft X 10 ft.

Fixture Grid: \_\_\_\_\_ ft X \_\_\_\_\_ ft. (center-to-center)

Fixture Type: 4

Switching - Type: WALL No. 1

Accessibility to User: OK

Hours of Operation: \_\_\_\_\_

Lamp Model: 40W Ballast Model: \_\_\_\_\_

Lamps/ Fixture	Ballast/ Fixture	No. Fixture	FC	FC	FC
<u>1</u>	<u>1</u>	<u>2</u>	<u>25</u>	_____	_____
+ 1 BLAX.					

4' - CELL

## LIGHTING SURVEY DATA SHEET

BLDG. # B-410

ROOM # \_\_\_\_\_

Area Description: CLOTHING ISSU

Area Dimensions: 10 ft X 18 ft.

Fixture Grid: \_\_\_\_\_ ft X \_\_\_\_\_ ft. (center-to-center)

Fixture Type: \_\_\_\_\_

Switching - Type: WALL No. 1

Accessibility to User: OK

Hours of Operation: \_\_\_\_\_

Lamp Model: 34W Ballast Model: \_\_\_\_\_

Lamps/ Fixture	Ballast/ Fixture	No. Fixture	FC	FC	FC
<u>1</u>	<u>1</u>	<u>6</u>	<u>24</u>	_____	_____

4' CELL

# LIGHTING SURVEY DATA SHEET

BLDG. # B3-41D

ROOM # \_\_\_\_\_

Area Description: MASK STORAGE

Area Dimensions: 26 ft X 19 ft.

Fixture Grid: \_\_\_\_\_ ft X \_\_\_\_\_ ft. (center-to-center)

Fixture Type: 4' S.M.W.A

Switching - Type: WALL No. 1

Accessibility to User: OK

Hours of Operation: \_\_\_\_\_

Lamp Model: ADW Ballast Model: \_\_\_\_\_

<u>Lamps/ Fixture</u>	<u>Ballast/ Fixture</u>	<u>No. Fixture</u>	<u>FC</u>	<u>FC</u>	<u>FC</u>
<u>1</u>	<u>1</u>	<u>12</u>	<u>14</u>	_____	_____

12' - CELL

---

# LIGHTING SURVEY DATA SHEET

BLDG. # \_\_\_\_\_

ROOM # \_\_\_\_\_

Area Description: \_\_\_\_\_

Area Dimensions: \_\_\_\_\_ ft X \_\_\_\_\_ ft.

Fixture Grid: \_\_\_\_\_ ft X \_\_\_\_\_ ft. (center-to-center)

Fixture Type: \_\_\_\_\_

Switching - Type: \_\_\_\_\_ No. \_\_\_\_\_

Accessibility to User: \_\_\_\_\_

Hours of Operation: \_\_\_\_\_

Lamp Model: \_\_\_\_\_ Ballast Model: \_\_\_\_\_

<u>Lamps/ Fixture</u>	<u>Ballast/ Fixture</u>	<u>No. Fixture</u>	<u>FC</u>	<u>FC</u>	<u>FC</u>
_____	_____	_____	_____	_____	_____